

2. Attach open end of floating link (3) to the bottom hole of A-frame bars (5). Secure using cap screw (11), sleeve (10), and flange lock nut (9).
 3. Attach closed end of floating link (3) to diagonal braces (6). Secure using cap screw (8), spacer (7), and flange lock nut (9) supplied in hardware bag.
- NOTE:** Quick hitch top hook will pick up on sleeve (10). Lower quick hitch hook will attach to cutter hitch pins.
4. Raise cutter to transport position and adjust tractor top link until cutter is level in the raised position.

INSTALLATION AND REMOVAL OF DRIVELINE (TRACTOR PTO)

To Install:

Pull locking collar back and at the same time push driveline onto tractor PTO shaft until locking device engages.

To Remove:

Hold driveline into position, pull locking collar back, and slide driveline off tractor PTO shaft.

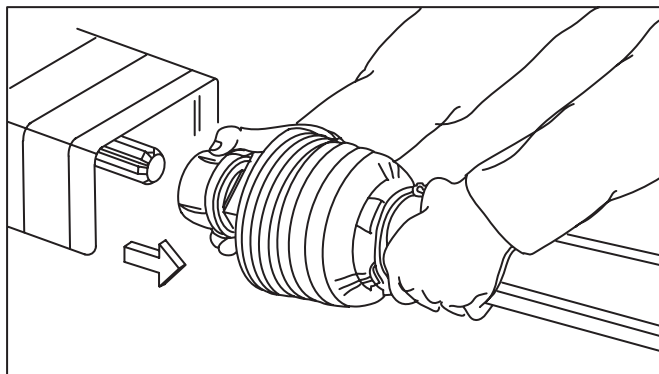

Figure 3. Lock Collar

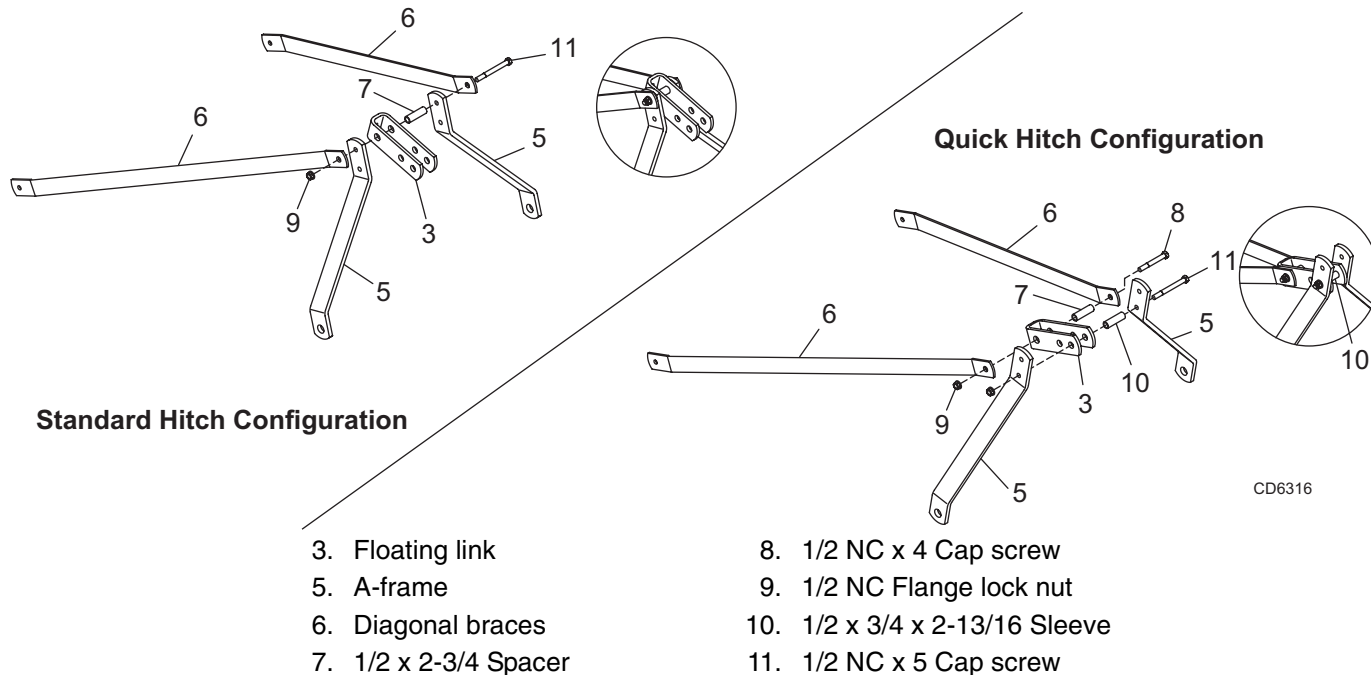

Figure 4. Standard Hitch and Quick Hitch Configuration