

2. OPERATING PRINCIPLE

2.1 POWER TRAIN DIAGRAM

2.1.1 CK22

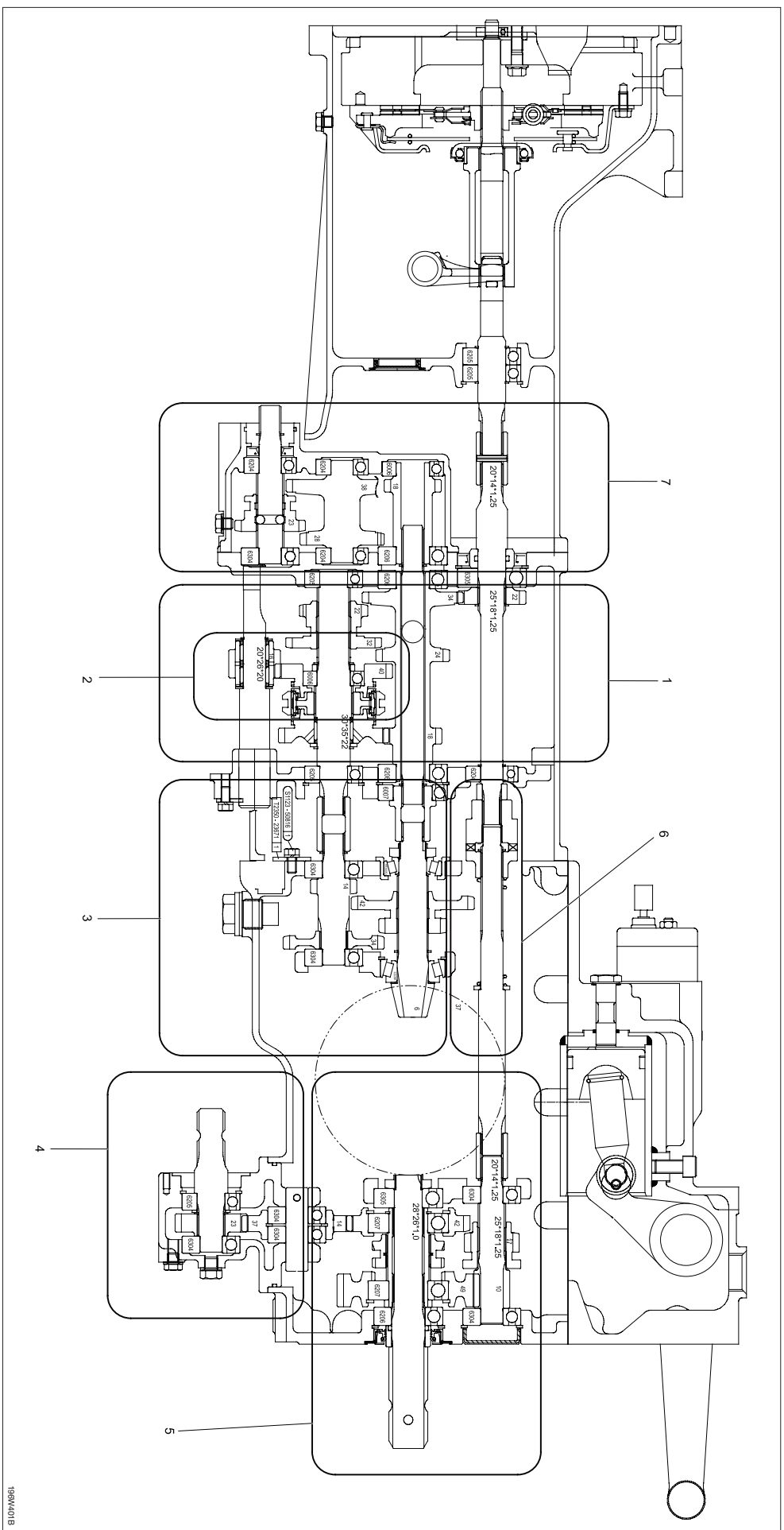

- (1) Main gear shift section
- (2) Reverse shift section
- (3) High-Low range shift section

- (4) Mid PTO shift section
- (5) Rear PTO shift section

- (6) **Overrunning clutch section**
- (7) Front Wheel drive section