

FIG 609

RK37HC

HYDRAULIC PIPE (1)

P1

Year

2017

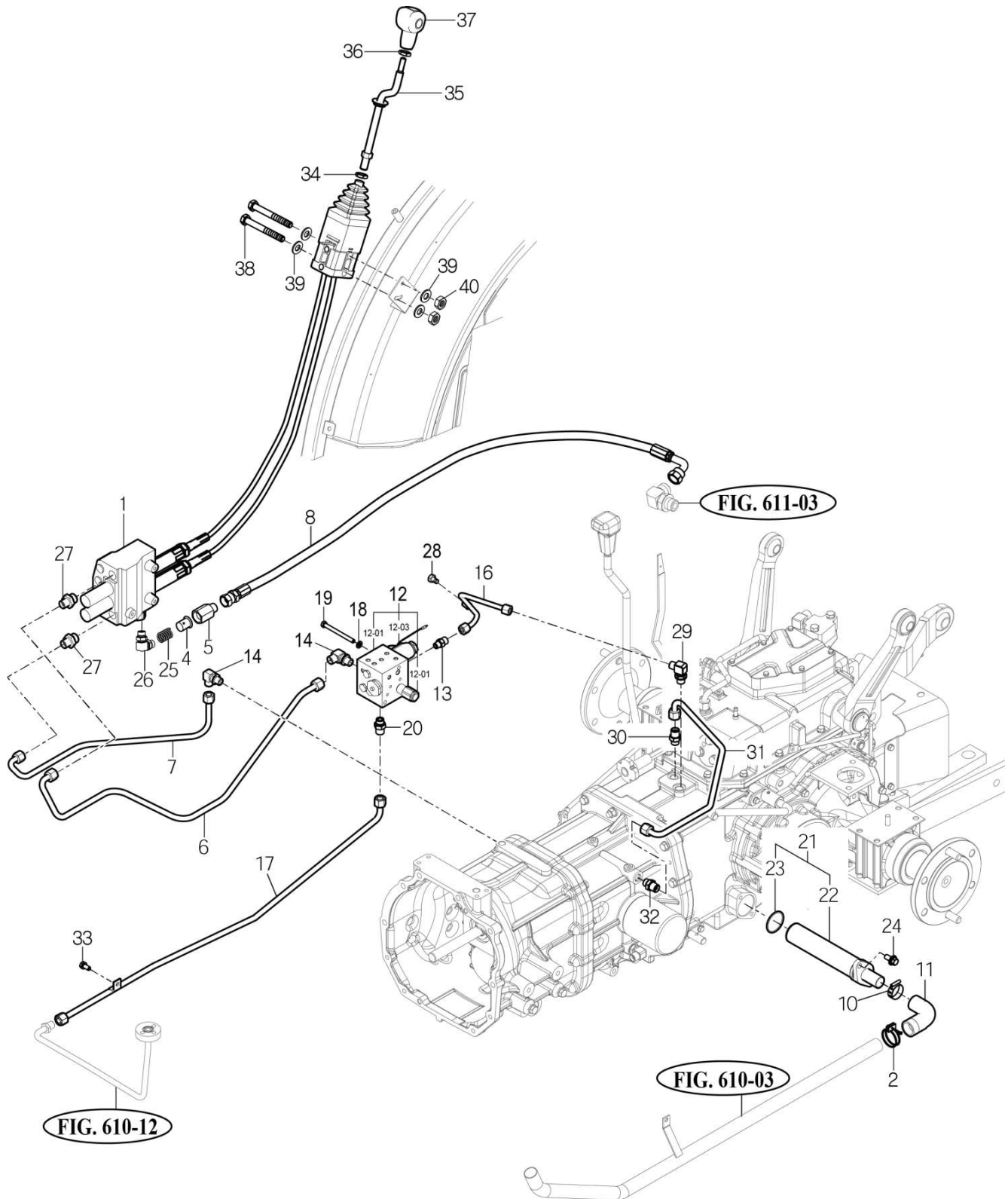
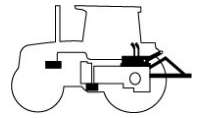

NOTE

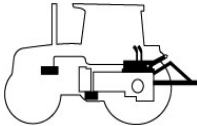
FIG 609			HYDRAULIC PIPE (1)			P1	Year	
RK37HC							2017	
KEY NO.	TYM PART NO.	DESCRIPTION	SPEC.	QTY.	REPAIR	EFFECTIVE DATE	REMARKS	
609 001	12345501000	LOADER VALVE SUB		1				
609 002	14801020070	CLAMP , 40		1		~2018.12.02		
609 002	18027090400	BAND CLAMP 40 EMBO TYPE		1		2018.12.03~		
609 004	12305180020	FILTER , 80 MESH		1				
609 005	16705100030	ADAPTER , PF1/2 PF1/2		1				
609 006	12355134401GB	PIPE COMP , PUMP		1				
609 007	12355134502GB	PIPE COMP , TANK		1				
609 008	16705152330	HOSE , 1400 ASSY		1				
609 010	14445100080	CLAMP . HOSE		1		~2018.12.02		
609 010	18027090400	BAND CLAMP 40 EMBO TYPE		1		2018.12.03~		
609 011	17405100010	HOSE		1		~2018.12.02		
609 011	17405100011	HOSE		1		2018.12.03~		
609 012	14835182000	VALVE ASSY , PTO		1		~2019.02.28		
609 012	14835182001	VALVE ASSY , PTO		1		2019.03.01~		
609 01201	14725182100	VALVE , PTO		1		~2019.02.28		
609 01201	14725182101	VALVE , PTO		1		2019.03.01~		
609 01202	15640090001	VALVE ASSY , RELIEF		1				
609 01203	14725182210	SOLENOID COIL		1				
609 013	14444080062	CONNECTOR		1				
609 014	14725100100	ELBOW , PF3/8 M18		2				
609 016	12385204200	PIPE COMP , PTO		1				
609 017	12355104701GB	PIPE COMP , RR MAIN		1		~2019.02.28		
609 017	12355104702GB	PIPE COMP , RR MAIN		1		2019.03.01~		
609 018	V4011600080	WASHER , SPRING	M8	3				
609 019	V2013608090	BOLT , HEX	M8X90	3				
609 020	16995304000	UNION , O-RING		1				
609 021	16705105000	FILTER ASSY , SUCTION		1				
609 022	16705104900	FILTER COMP , SUCTION		1				
609 023	V7211031045	O-RING , G	G45	1				
609 024	V2183610025	BOLT , HEX/SP	M10X25	2				
609 025	17995010210	SPRING		1				
609 026	13025100060	ELBOW PF1/2		1				
609 027	13025100020	UNION , M18,PF1/2		2				
609 028	13267060022	PLUG , DRAIN		1				
609 029	16705100100	ELBOW UNIT , PF 3/8XM16		1				
609 030	16995304000	UNION , O-RING		1				
609 031	12385204300	PIPE COMP , PTO CLUTCH		1				
609 032	12385304000	UNION(M18 , PF3/8, 0.6 orifice)		1				
609 033	V2173608025	BOLT , HEX/S	M8X25	1				
609 034	V3302600140	NUT , HEX FINE/2	M14	1				
609 035	12396013900GB	LEVER COMP . JOYSTICK		1		~2017.01.04		
609 035	12646013900GB	LEVER COMP . JOYSTICK		1		2017.01.05~		
609 036	V3343600100	NUT , HEX FINE/2		1				
609 037	19027750021	GRIP COMP , JOYSTICK		1				
609 038	V2173608085	BOLT , HEX/S	M8X85	2				
609 039	V4111600080	WASHER , PLAIN	M8	4				
609 040	V3042600080	NUT , HEX/2	M8	2				
NOTE								