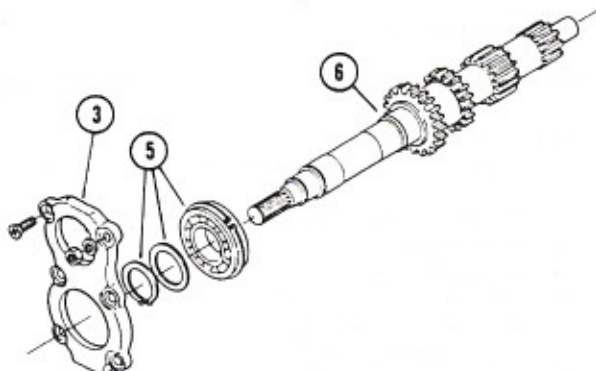

MAIN SHAFT**Disassembly and Reassembly** 5B-65-69**Disassembly**

1. Separate the transmission unit, Operation 5B-61-65.
2. Remove the shift cover, Operation 5B-62-65.
3. Remove the front cover, Operation 5B-63-67.
4. Remove the countershaft, Operation 5B-64-68.
5. Remove the snap ring, thrust washer and bearing.
6. Pull out the main shaft.

**Reassembly**

7. Reverse procedures 1 to 6.

REVERSE IDLER SHAFT**Disassembly and Reassembly** 5B-66-69**Disassembly**

1. Separate the transmission unit, Operation 5B-61-65.
2. Remove the shift cover, Operation 5B-62-65.
3. Remove the countershaft, Operation 5B-64-68.
4. Remove the lock bolt securing the shaft.
5. Turn the shaft 1/2 turn, and tap out the two roll pins.
6. Pull the shaft forward, removing collar, gear, bearing, washer and collar.

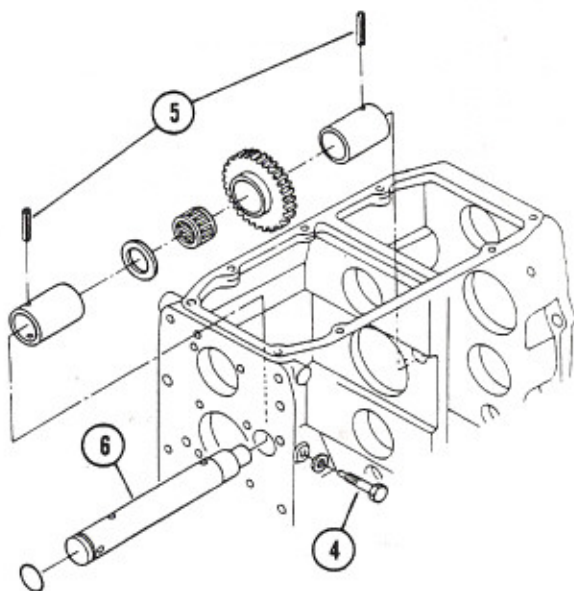
**Examination**

7. Install the gear, bearing, thrust washer, and collars on the reverse idler shaft.
8. Fasten collars with roll pins.
9. Measure the clearance with feeler gauge.
Standard Clearance 0.1 to 0.3 mm
(0.00394" to 0.0118")
10. Select appropriate thrust washer to obtain the standard clearance.
 - 2.9 mm (0.114")
 - 3.2 mm (0.126")
 - 3.5 mm (0.138")
11. Disassemble and retain proper thrust washer.

Reassembly

12. Install the shaft in the housing, and assemble collar, thrust washer, bearing, gear, and collar on the shaft.
13. Align holes with the chamfered edge of the hole facing upwards.
14. Press in two roll pins.

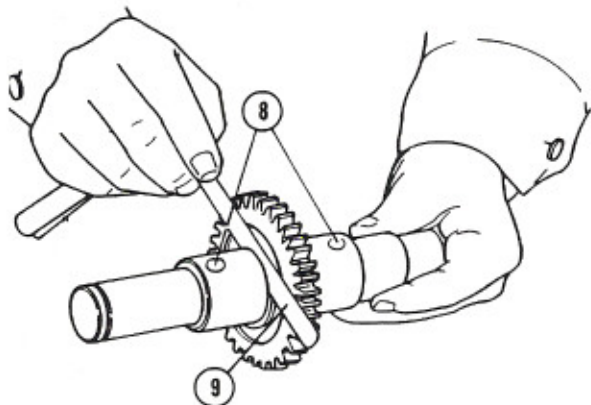

NOTE: Set the opening of the roll pins in the axial direction of the shaft.

15. Secure the shaft with lock bolt.
16. Reverse procedures 1 to 3.