

# MODEL MID MOWER 60" MOWER AND MOUNTING

---

**INCLUDES OPERATOR'S MANUAL  
INSTALLATION INSTRUCTIONS AND PARTS CATALOG**

---

**MODEL NAME : MM60**

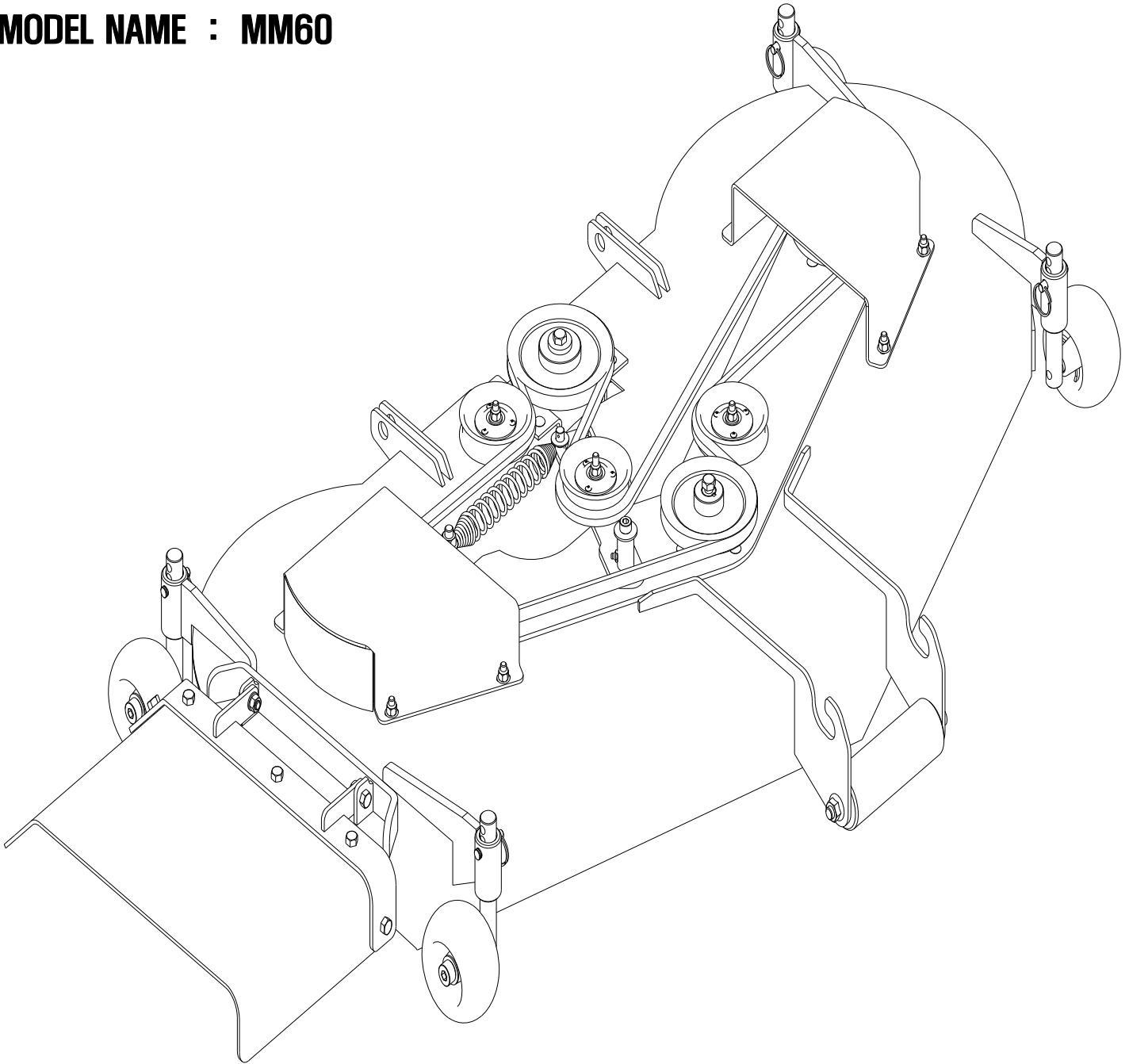

SAFETY DECALS

The safety of the operator was the prime consideration on the design of the mower. Proper shielding,convenient controls,simple adjustments,and other safety features have been built into this implement.

The following decals are located on the mower deck. Keep decals clean and replace them immediately if they are missing or damaged. contact your dealer for replacements.



Part NO : JHM 1000-071-100  
Located on RH and LH Belt Shields



Part NO : JHM 1000-072-100  
Located on Deck Weldment



Part No : JHM 1000-075-100  
Located on Deck Weldment

INFORMATIONAL DECALS

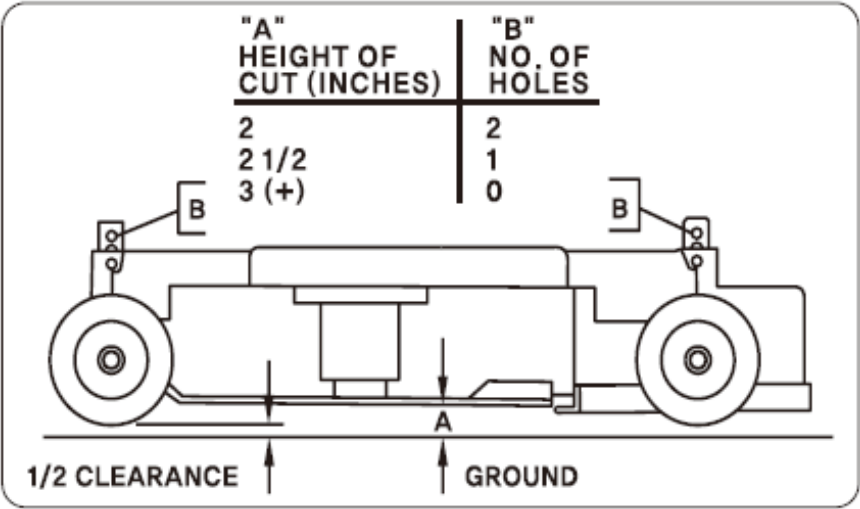

Part NO : JHM 1000-074-100

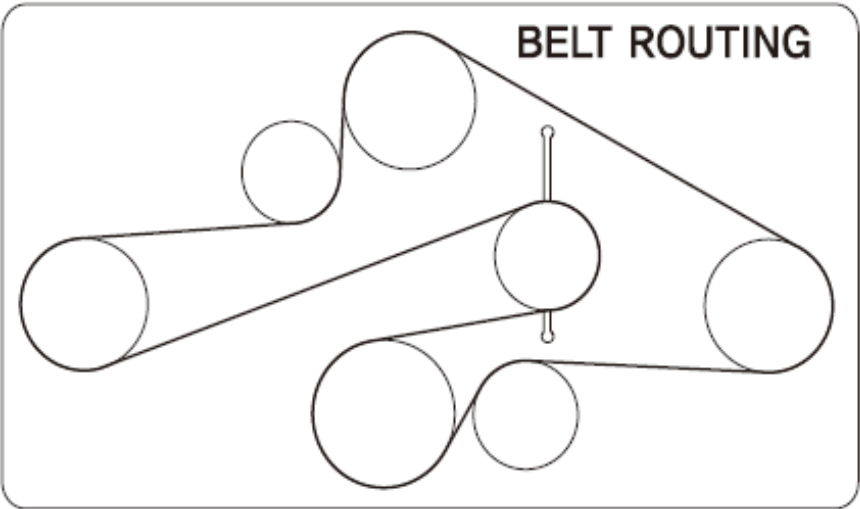

Part NO : JHM 1000-073-100

---

## LUBRICATION

NOTICE: It is not recommended to use a pressure washer to clean the mower assembly. High pressure water may cause damage to spindles, pulleys, belts, or bearings shortening life and reducing serviceability.

Life of the mower depends upon the maintenance given. Proper lubrication is very important. Always lubricate the deck and lift components before operation.

Always wipe the fittings to be lubricated with a clean cloth before greasing. Dirt injected into the fitting will cause damage to the machined parts.

Use SAE Multi-purpose lithium base grease on all lubrication locations shown below. Remember to wipe away excess grease, which has built up around parts.

Lubricate grease fittings after every 50 hours of operation.

Miscellaneous working parts not provided with lubrication fittings should be oiled daily with a good grade of lubricating oil.

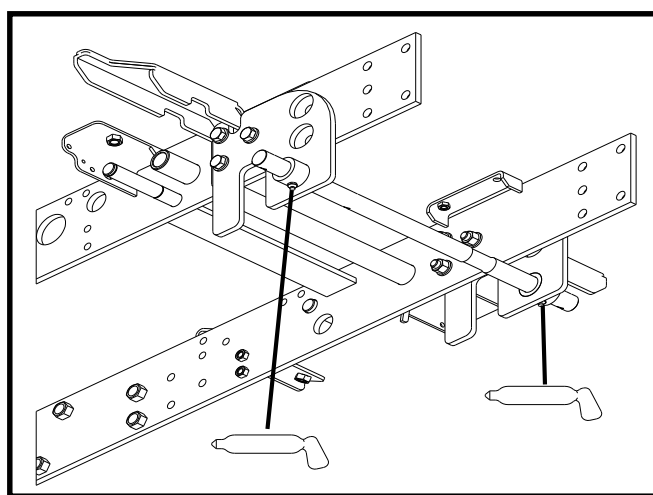
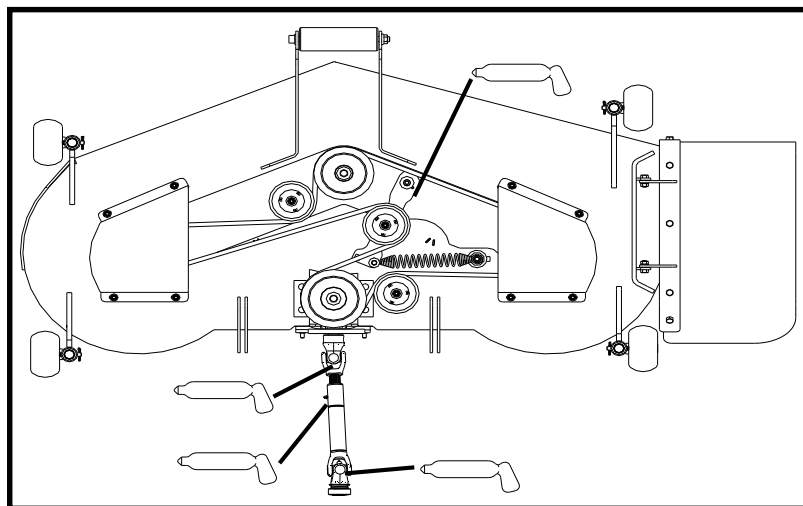

# MOWER DECK SERVICE PARTS

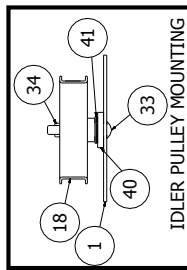
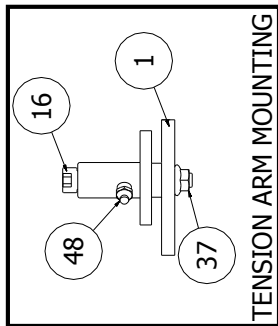
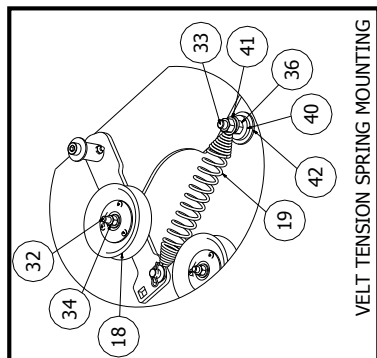
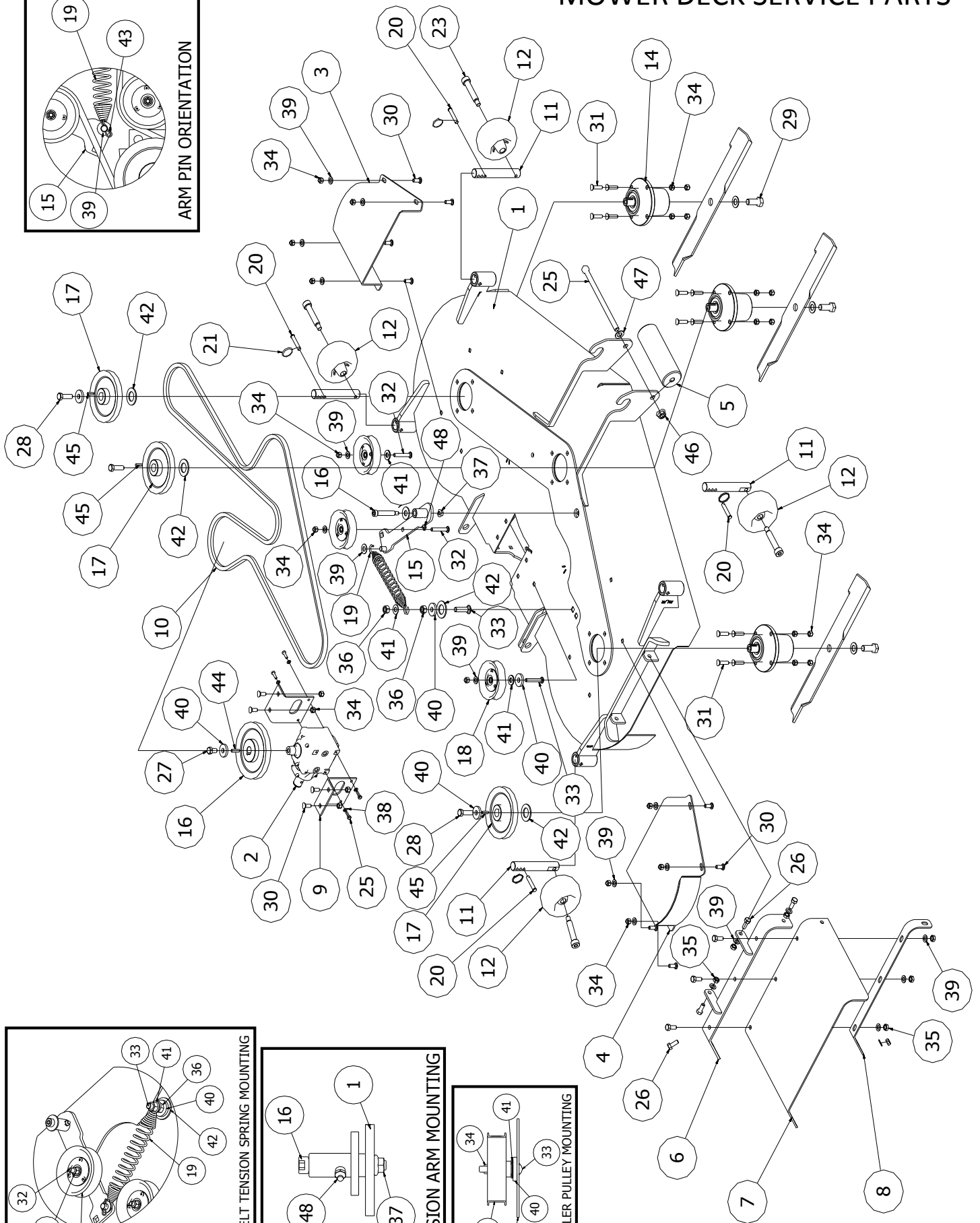
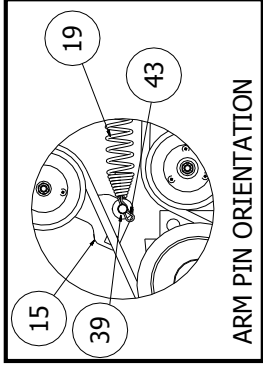

---

# MOUNT KIT SERVICE PARTS BREAKDOWN

NO	QTY	PART	DESCRIPTION
1	1	JHM 1000-015-100	MID MOWER WELDING ASSY
2	1	JHM 1000-002-101	GEAR BOX SUB ASSY
3	1	JHM 1000-021-100	VELT COVER WELDING ASSY_LH
4	1	JHM 1000-020-100	VELT COVER WELDING ASSY_RH
5	1	JHM 1000-024-100	FRONT WHEEL
6	1	JHM 1000-011-100	CHUTE WELDING ASSY
7	1	JHM 1000-010-102	RUBBER PLATE
8	1	JHM 1000-010-101	CHUTE WASHER PLATE
9	2	JHM 1000-002-102	GEAR BOX PLATE
10	1	JHM 1000-022-100	V_BELT
11	4	JHM 1000-014-101	WHEEL LEVEL SHAFT
12	4	JHM 1000-014-102	WHEEL
13	3	JHM 1000-003-101	BLADE
14	3	JHM 1000-013-100	HOUSING SUB ASSY
15	1	JHM 1000-009-100	ARM WELDING ASSY
16	1	JHM 1000-004-100	MAIN PULLEY
17	3	JHM 1000-005-100	BLADE PULLEY
18	3	JHM 1000-006-100	TENTION PULLEY ASSY
19	1	JHM 1000-023-100	SPRING SEIVEL ASSY
20	4	JHM 1000-027-100	CLEVIS PIN
21	4	JHM 1000-084-100	RING
22	1	JHM 1000-026-100	STRIPER BOLT
23	4	JHM 1000-014-103	STRIPER BOLT
24	1	H100-400-001	WRENCH BOLT
25	4	H100-100-001	Hex Head_5/16 X L20
26	7	H100-100-002	Hex Head_M10 X L35
27	1	H100-100-004	Hex Head_M12 X L25
28	3	H100-200-001	Hex Head_M12 X L35
29	3	H100-100-008	Hex Head_M16 X L40
30	12	H100-300-001	Carriage Bolt_ 3/8 X L30
31	16	H100-300-002	Carriage Bolt_ 3/8 X L40
32	2	H100-300-003	Carriage Bolt_ 3/8 X L65
33	1	H100-300-005	Carriage Bolt_ 1/2 X L60
34	26	H200-200-001	Nut,_3/8 Lock Nylon
35	7	H200-100-001	Nut,Hex_M10
36	2	H200-100-004	Nut,Hex_ 1/2
37	1	H200-100-004	Lock Nylon Nut_M12
38	4	H400-100-002	Spring Washer_M8
39	19	H300-100-001	FLAT WASHER_M10
40	6	JHM 1000-077-100	FLAT WASHER_Φ36 X T6

---

---

# MOUNT KIT SERVICE PARTS BREAKDOWN

NO	QTY	PART	DESCRIPTION
41	5	H200-100-002	Flat Washer_M12
42	4	H300-100-005	Flat Washer_M24
43	1	JHM 1000-078-100	Clip_Pin
44	1	JHM 1000-029-100	Key_6 X 6
45	3	JHM 1000-028-100	Key_5 X 5
46	1	H200-100-003	Lock Nylon Nut_M14
47	1	H300-100-003	Flat Washer_M14
48	1	H900-100-001	Grease Fitting_PT 3/8

## FRONT MOUNT HANGER PLATE INSTALLATION

1. Tractor on the front as shown in the illustration inside the frame parts (1 & 2) and install it. Bolt M16 X 45mm (36), using the four fixing plates and washers (43) and two M16 nuts (56) to assemble.

Note: The left-hand front fixed plate is pre-assembled spring-loaded J-latch.

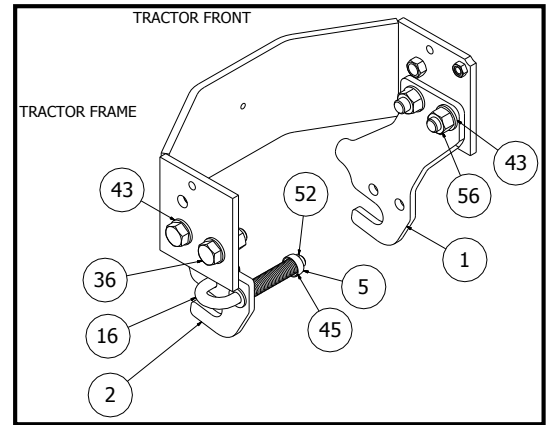

## MID-MOUNT WELDMENT INSTALLATION

- 1 On the right side of the tractor (8) to the mid-mounting bracket assembly and offset (9,10) ANCHOR BRACKET (7) in two holes in the bolt M12-1.75 X 45 (38), M12-1.75 X 45 bolt (4) , at the bottom bolt hole on the M12-1.75 X 40 (39), washers M12 (45), and assemble the M12 nut. Located on the outside of the mount.

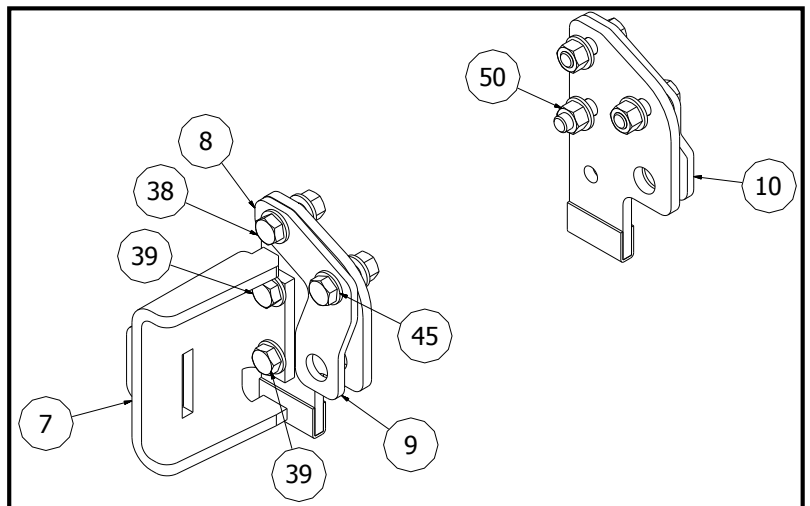

- 2 On the left side of the tractor bracket (10), a tractor frame and the bracket to fit nine people, M12-1.75 X 45 bolts (38), M12 - 1.75 X 35 bolt (39) is used to connect the washer (45), nut M12 the assembly.

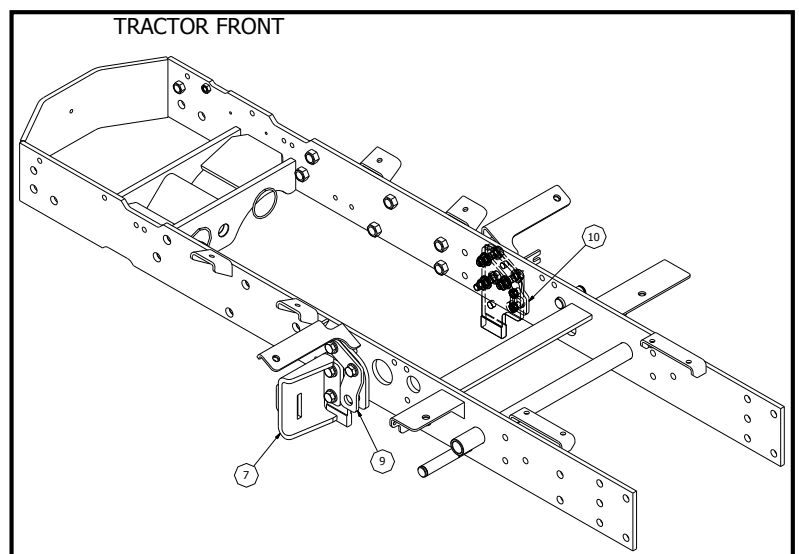



---

## REAR MOUNT ASSEMBLY INSTALLATION

1. ANCHOR SUB ASSY-LH (18) and the frame holes to match the tractor. Bolt M12 X L45 (38) and washers M12 (45) and fit the bracket to the frame preserver. Washer M12 (45) and nut M12 (50) and then replacing the assembly.

Left / right by the same method as in assembly.

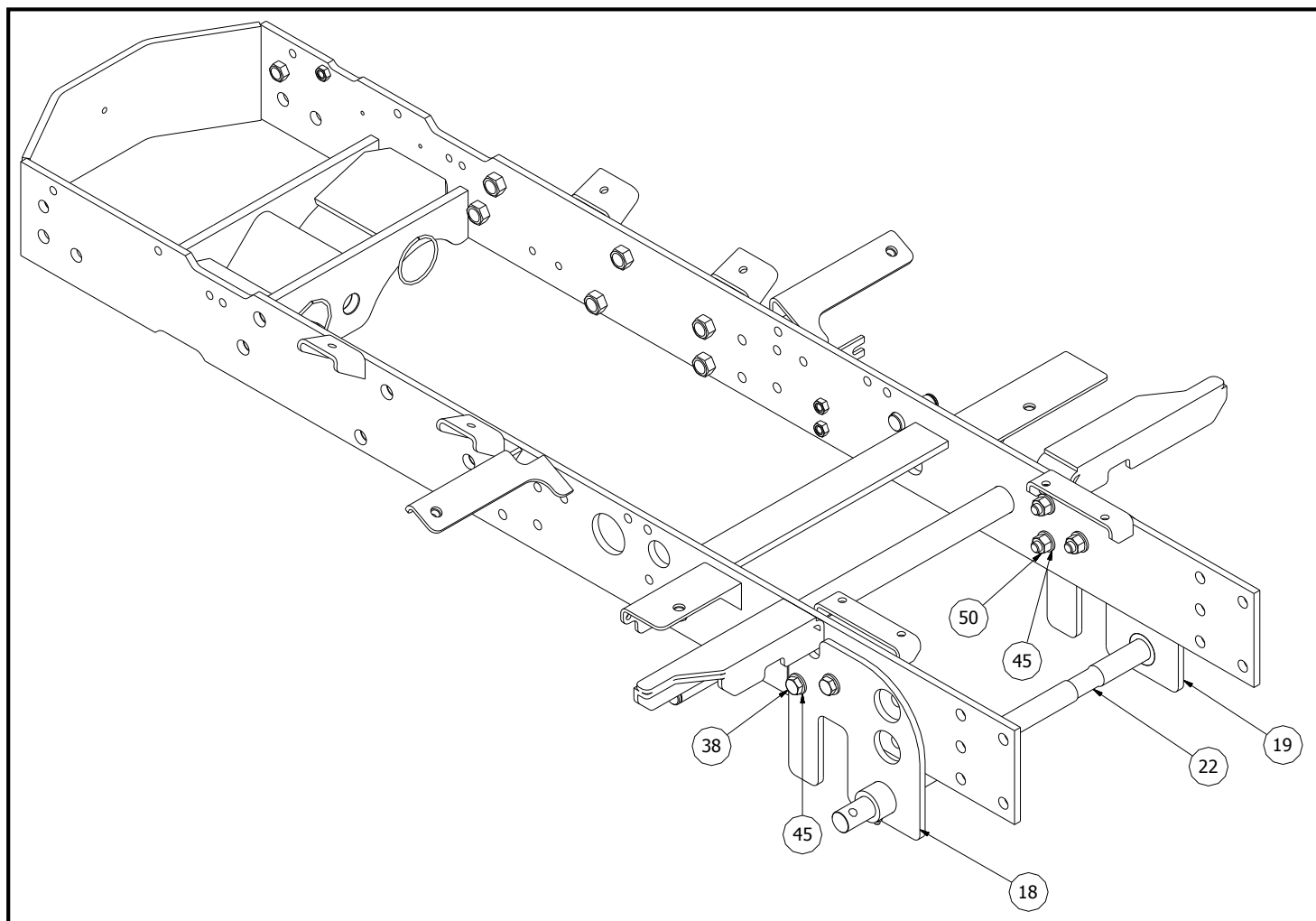

## LOWER MOUNT LINK ASSEMBLY

1. MOVING WELDING ASSY-2 welded structures (5), and the front link weldment (4) using the four bolts to assemble. M14 X 40mm Bolt (37), washers (44) and nuts (49) and shown to assemble. Tractor mower deck is installed in the end will be adjusting.  
Do not tighten at this time.

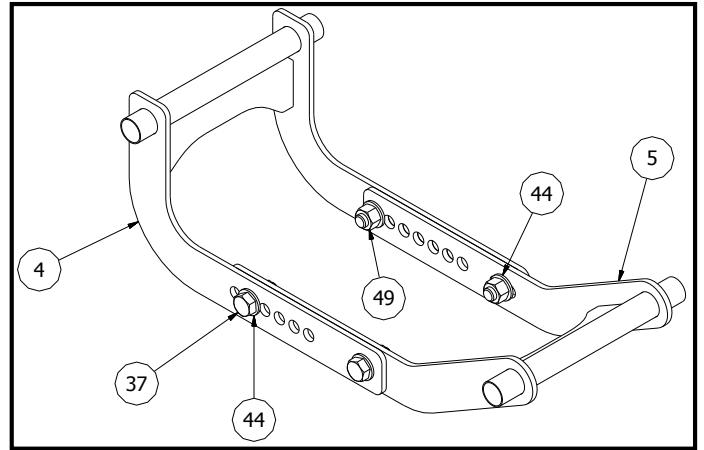

## MID LINKAGE ASSEMBLY

- 1 And the intermediate guide connection of the link pin 14, the link plate 17, a washer 44 and a cotter pin (53) is used to fix it.
2. LH assemble the same way.

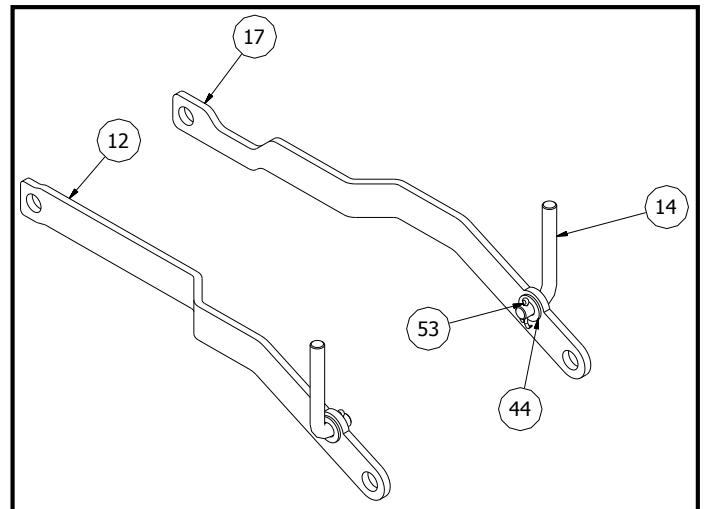

## REAR LIFT ROD ASSEMBLY

- 1 Link bolt 21 to the nut 50 and the link body 20, to assemble. Link until the end of the bolt threads inside the body touches the edge of the links, the links for the bolt and tighten the nut.
- 2 Link bolt (21) is assigned to assay pin (30), spring (32), lock nut (42) is assembled. Threads up to 1/4 to tighten the lock nut. Thread shows through the top of the lock nut.

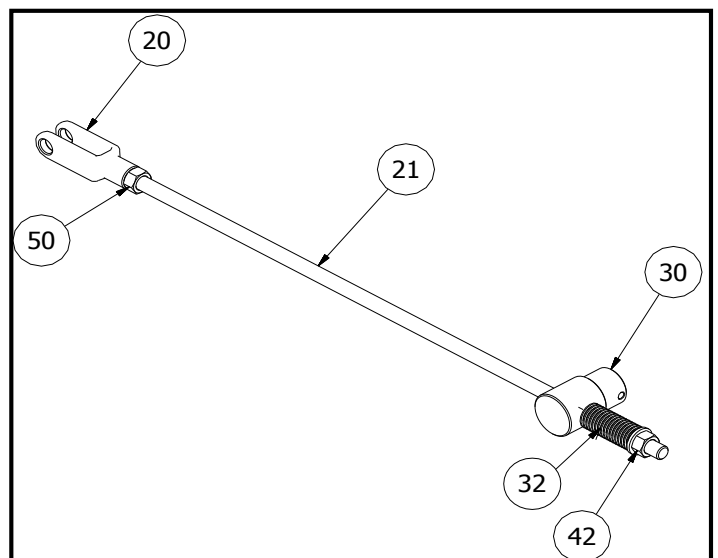

Note: The mower deck is installed, additional adjustment for the lock nut will happen in the future

## REAR LIFT ASSEMBLY

- 1 As shown in the figure the lift pin (28) to assemble and also, the rotation link (15) with washer (41) and a split pin (54) is used to fix it.
- 2 As shown in the figure lifts the pin (28) to assemble and LH, rotary link (13), a washer 41 and a split pin (54) is used to fix it.

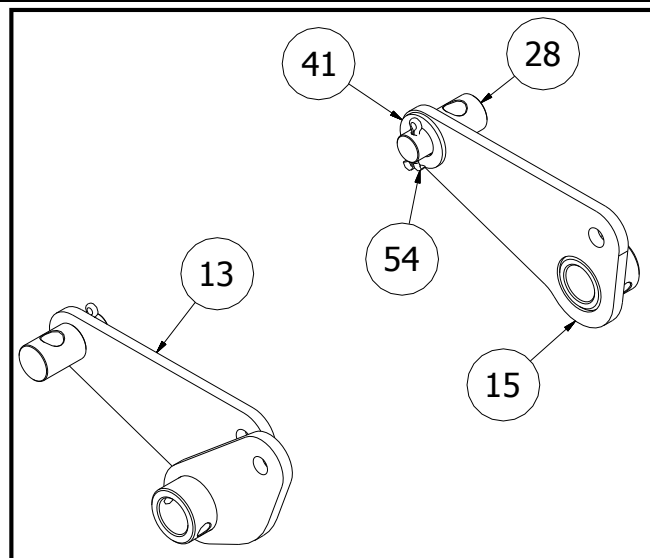

- 3 Links as shown in the figure rotation (15) links the body and assemble the assembly. A clevis pin (29) and cotter pin (53) is used to fix it.
4. Assemble the rear lift and 30 link bolt (21) pins (30) and lift. Washers (47) and cotter pin (55) is used to secure it.
- 5, One of the clevis pin (29) and a split pin (53) is used to fix it.

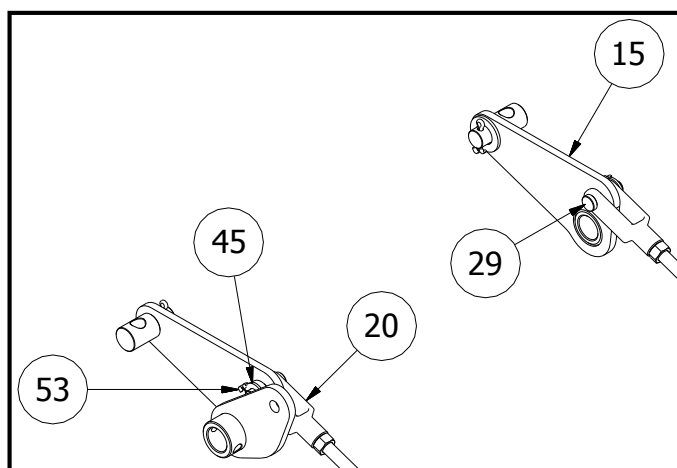

6. LH Rear Lift (24) tension rods (21) pins (30) and lift. Washers (47) and cotter pin (55) is used to secure it.
7. Left / Right assembled the same way.

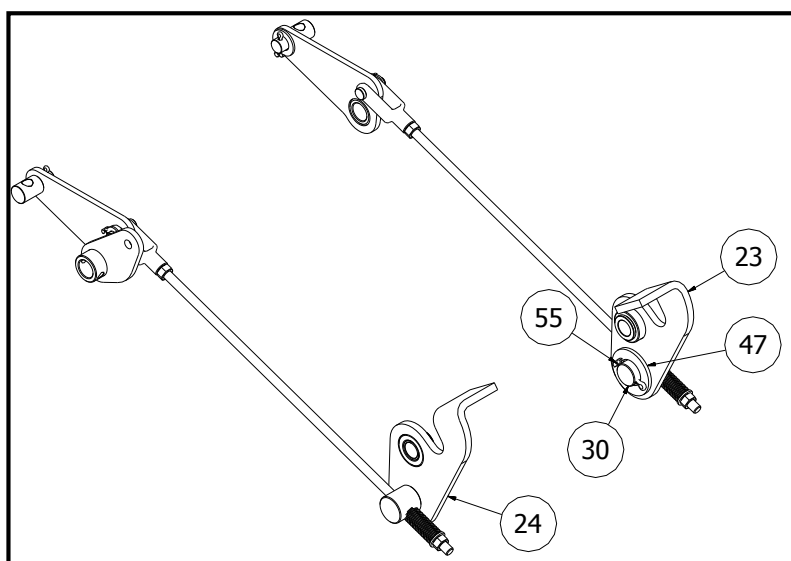

## REAR LIFT INSTALLATION

1 under the tractor to push the link pin bushings RH rear lift (23) to install. Flat washers (59), insert four bolts M10 (40), nut (51) with the screws.

1 under the tractor to push the link pin bushings RH rear lift (24) to install. Flat washers (59), insert four bolts M10 (40), nut (51) with the screws.

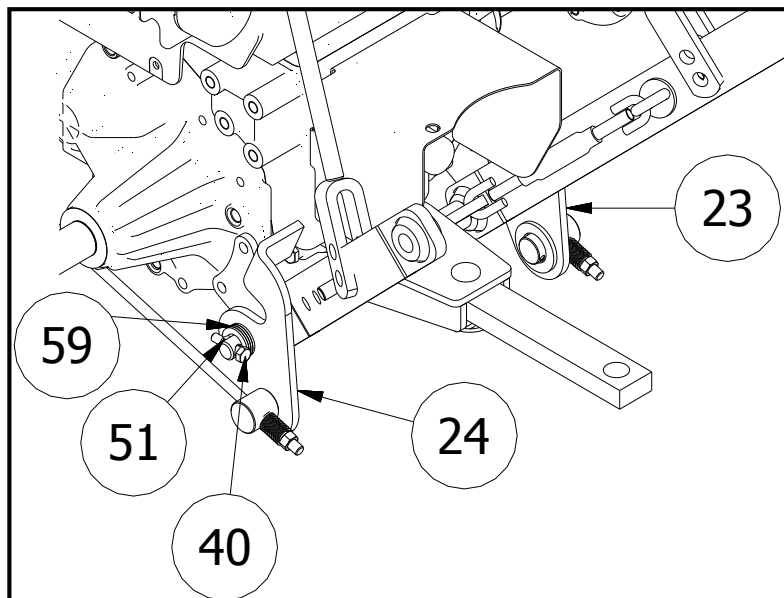

## MID LINKAGE INSTALLATION

1 Clevis pin (27) and the lynch pin (34) to the right and left mid-mount (8, 9, 10) on the right, left, middle link (11,17) connection.

2 Install the lift rod. (14) has already been right, on the left side of the bell crank (13) and (15) are installed on the lift pins (28) on the right and left middle link (11,17) to be installed. Thread 1/2 "to (41) lift rod (14) to tighten the lock nut to show through the top of the nut.

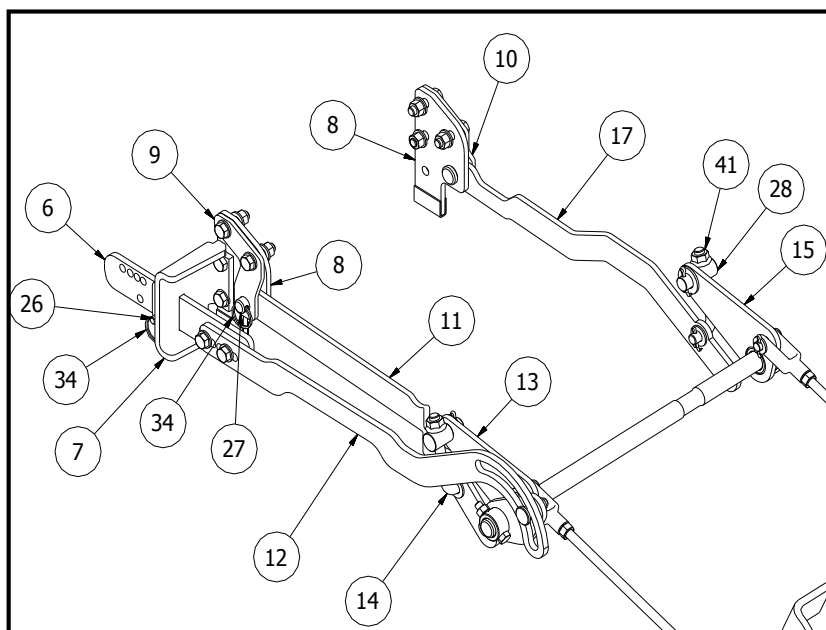

3 A distance to the plate (6) and the link plate LH (12) once the rotation of the bolt assembly with the bolt (31) is assembled. Locking pin (26) and then replacing the ring hole (34) fitted it.

---

## HEIGHT ADJUSTMENT

- 1 Together to raise the floor to hear the ring (34) and retaining pin (26) and remove the retaining pin to remove it. Distance adjustment plate to the desired position by sliding it to the left position. Locking pin (26), ring (34) to assemble.

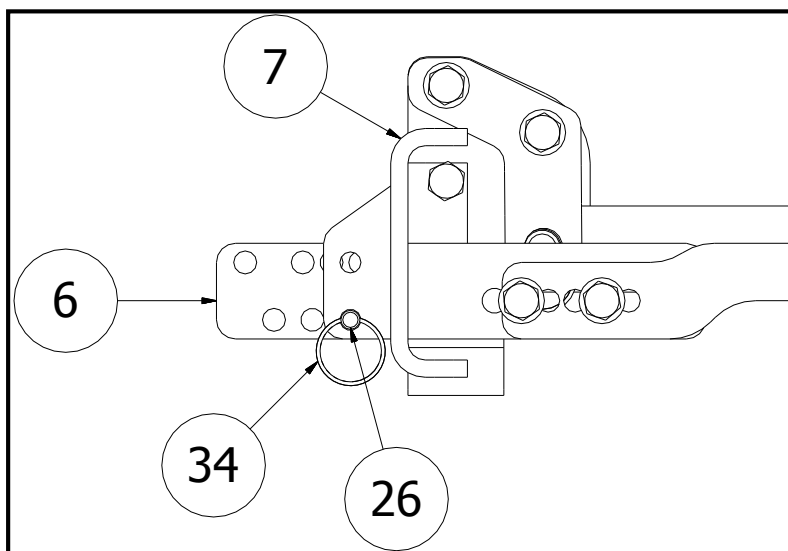

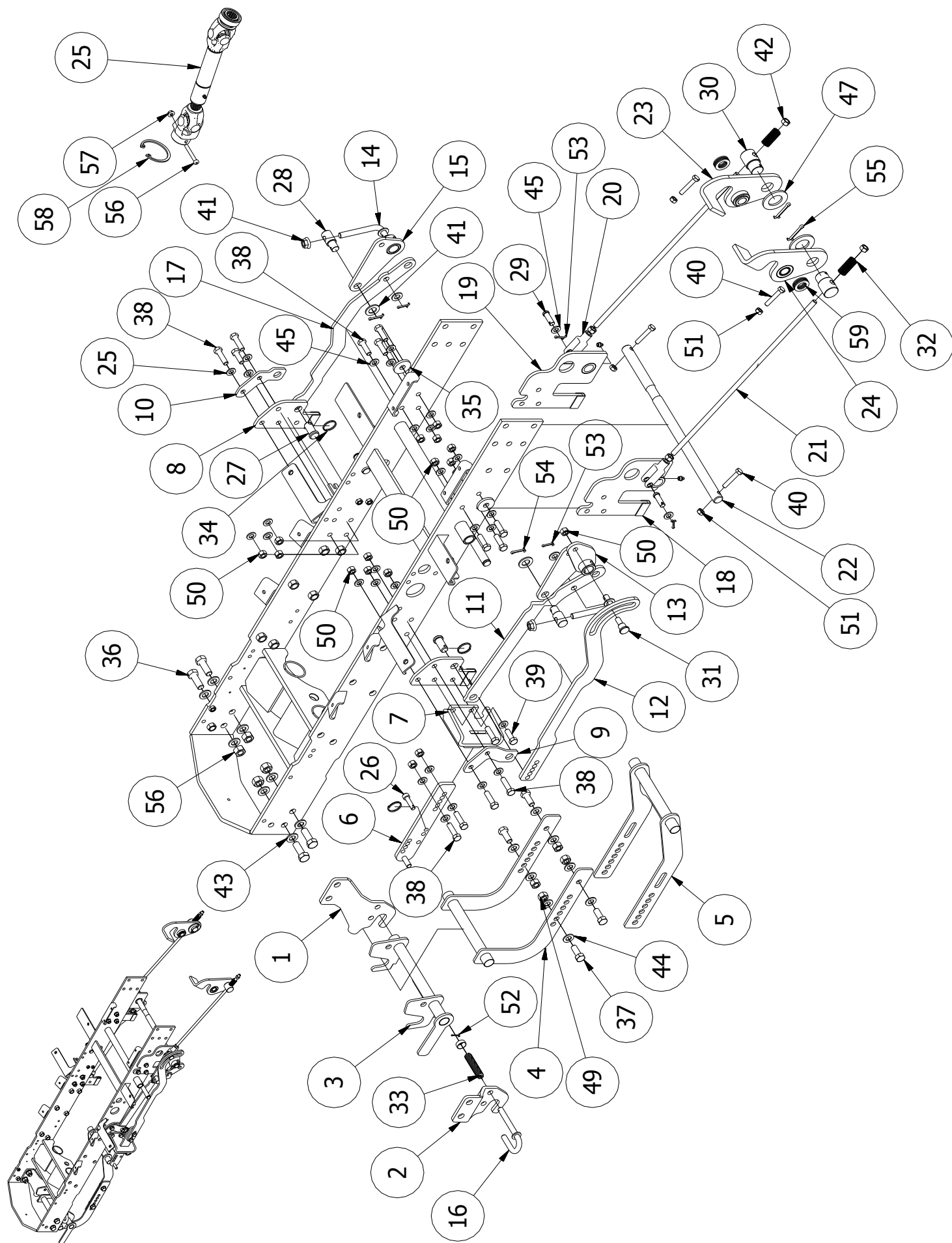

---

# MOUNT KIT SERVICE PARTS BREAKDOWN

NO	QTY	PART	DESCRIPTION
1	1	JHM 1000-056-100	FIXING PLATE-LH
2	1	JHM 1000-057-100	FIXING PLATE-RH
3	1	JHM 1000-030-100	MOVING WELDING ASSY-1
4	1	JHM 1000-031-100	MOVING WELDING ASSY-2
5	1	JHM 1000-032-100	MOVING WELDING ASSY-3
6	1	JHM 1000-088-100	DISTANCE ADJUSTMENT PLATE WELDING ASSY
7	1	JHM 1000-086-100	ANCHOR BRACKET WELDING ASSY
8	2	JHM 1000-046-100	STOP PLATE SUB ASSY
9	1	JHM 1000-060-100	LINK PLATE-1
10	1	JHM 1000-061-100	LINK PLATE-2
11	1	JHM 1000-058-100	LINK PLATE-LH
12	1	JHM 1000-087-100	LINK PLATE-LH
13	1	JHM 1000-090-100	ROTARION WELDING ASSY-LH
14	2	JHM 1000-055-100	LINK PIN GUIDE ASSY
15	1	JHM 1000-048-100	ROTATION LINK ASSY-RH
16	1	JHM 1000-047-100	LATCH PIN ASSY
17	1	JHM 1000-059-100	LINK PLATE-RH
18	1	JHM 1000-038-100	ANCHOR SUB ASSY-LH
19	1	JHM 1000-040-100	ANCHOR SUB ASSY-RH
20	2	JHM 1000-050-101	LINK BODY
21	2	JHM 1000-050-102	LINK BOLT
22	1	JHM 1000-044-100	SHAFT
23	1	JHM 1000-053-100	LINK BRACKET-RH SUB ASSY
24	1	JHM 1000-051-100	LINK BRACKET-LH SUB ASSY
25	1	JHM 1000-001-100	UNIVERSAL JOINT ASSY
26	1	JHM 1000-089-100	LOCKING PIN
27	2	JHM 1000-064-100	LINK PIN-3
28	2	JHM 1000-062-100	LINK PIN-1
29	2	JHM 1000-063-100	LINK PIN-2
30	2	JHM 1000-065-100	LINK ASSY PIN
31	1	JHM 1000-091-100	ROTATION BOLT
32	2	JHM 1000-094-100	LINK SPRING
33	1	JHM 1000-092-100	SPRING
34	2	JHM 1000-084-100	RING
35	2	JHM 1000-039-103	FLAT WASHER
36	4	H100-100-007	Hex Head Cap Screw_M16 X L45
37	4	H100-100-005	Hex Head Cap Screw_M14 X L35
38	20	H100-100-006	Hex Head Cap Screw_M12 X L45
39	1	H100-100-007	Hex Head Cap Screw_M12 X L35
40	4	H100-100-003	Hex Head Cap Screw_M10 X L55

---

---

# MOUNT KIT SERVICE PARTS BREAKDOWN

NO	QTY	PART	DESCRIPTION
41	2	H200-100-003	Lock Nylon Nut_M14
42	2	H200-100-004	Lock Nylon Nut_M12
43	8	H400-100-004	Flat Washer_M16
44	8	H300-100-003	Flat Washer_M14
45	29	H200-100-002	Flat Washer_M12
46	2	H300-100-006	Flat Washer_M32
47	2	H300-100-006	Flat Washer_M32
48	4	H200-100-005	Nut,Hex_M16
49	4	H200-100-006	Nut,Hex_M14
50	21	H200-100-002	Nut,Hex_M12
51	4	H200-100-001	Nut,Hex_M10
52	1	JHM 1000-095-100	COTTOR_D2XL25
53	4	JHM 1000-096-100	COTTOR_D4XL25
54	2	JHM 1000-097-100	COTTOR_D5XL30
55	2	JHM 1000-098-100	COTTOR_D6.3XL45
56	1	H100-100-008	WRENCH BOLT_M8XL50
57	1	H200-100-007	NYLON NUT_M8
58	1	H300-100-001	SNAP RING_Φ 25
59	8	H300-100-007	Flat Washer_M22

---