

- [Close Window](#)
- [Print This Page](#)

Solution Detail



- [Close Window](#)
- [Print This Page](#)

Compact Tractor Travel Pedal is Slow to Return to Neutral on CT225 CT230 or CT235

If the customer comments that the travel control pedal on models CT225, CT230 or CT235 takes longer to return to the neutral position compared to when the tractor was new or when comparing it with a different CT225, CT230 or CT235 follow these troubleshooting steps [in this order](#) to identify if a fault exists.

1. Determine if external pedal or linkage binding is causing the complaint. With the engine off press the travel pedal forward and release it. The pedal should quickly return to neutral. Repeat this procedure for the reverse direction. If the pedal does not return to neutral inspect the pedal pivot mechanism and pedal damper to ensure that the 2 grease zerks have been lubricated properly. If that doesn't free the travel pedal mechanism inspect that the pedal centering spring cylinder assembly is connected properly. This gold colored cylinder is located below the right floor board.
2. If the pedal does return to neutral with the engine off determine if a creep condition exists. Start the engine and make sure the machine does not move by centering the pedal with your foot. Press the travel pedal forward. Return the pedal to pedal to neutral with your heel. Ensure that the tractor does not move with the pedal in neutral. Repeat this procedure in the reverse direction, returning the pedal to neutral with your toe. If the machine creeps in one or both direction adjust the centering mechanism as needed. If this does not correct the creep inspect the neutral valve(s) for debris or damage or try swapping the valves with another tractor. Replace the neutral valve(s) if testing indicates replacement is required.
3. With the hydraulic system at operating temperature operate the machine at full speed in high range in the forward travel direction. Press the brake pedals (both pedals should be locked together at all times) and verify that the brakes will stop the tractor and return the pedal to the neutral position. Adjust the brakes as needed. Repeat this procedure for the reverse direction.
4. Starting in late March 2011 a new pedal centering mechanism went into production. The new mechanism has dual coaxial springs that increases the amount of pedal return force. The new part number is 7022773 and it is the direct replacement for the previous version. The new centering mechanism can be identified from the old design by having only a single oil drain/check hole in the side. The original design had 2 screws on the side of the gold colored body to fill and check the oil level inside the cylinder. See the attached photo below for details.

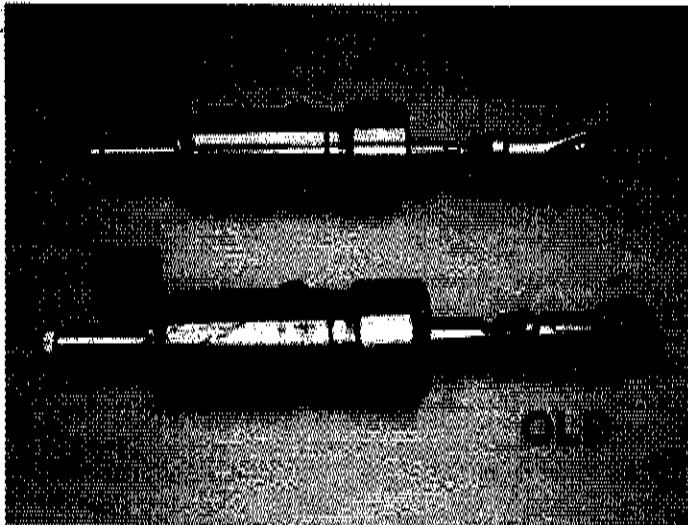

If all 4 procedures above are followed and the tractor performs as indicated in each step, no repairs are

required. DO NOT replace the pedal dampener (7002546) to address this complaint unless it is physically damaged. This part will typically not change the pedal return speed. There is no specification for the amount of time or distance for the Compact Tractor to coast to a stop using only the travel pedal centering mechanism. This is a matter of personal preference. To control the rate of deceleration of the Compact Tractor the operator should either use the brake pedals or move the travel pedal with their foot. Please review proper operating procedure (found in the Operation and Maintenance Manual) with the customer regarding use of the brakes to slow the tractor and proper usage of the travel pedal.

Related Attachments

None Found

Copyright © 2000-2012 salesforce.com, Inc. All rights reserved.

HYDROSTATIC PUMP (CT235) (CONT'D)

Parts Identification

- | | | |
|---------------------------|--------------------------|-------------------------|
| 1. Plug | 17. Snap Ring | 32. Bearing |
| 2. O-ring | 18. Spring Seat | 33. Seal |
| 3. Spring | 19. Cylinder Block | 34. Cover |
| 4. Relief Valve Assembly | 20. Snap Ring | 35. Screw |
| 5. Neutral Valve Assembly | 21. Plate | 36. Shaft |
| 6. Plug | 22. Piston Assembly | 37. Plate |
| 7. O-ring | 23. Shoe Plate | 38. Gerotor |
| 8. Bolt | 24. Swash Plate Assembly | 39. Housing |
| 9. Cover | 25. Swash Plate | 40. Lock Washer |
| 10. Oil Seal | 26. Shaft | 41. Charge Relief Valve |
| 11. Cover | 27. Key | 42. Spring Holder |
| 12. Bolt | 28. Snap Ring | |
| 13. Gasket | 29. Ball Bearing | |
| 14. Bearing | 30. Housing | |
| 15. Pin | 31. Cover | |
| 16. Valve Plate | | |
| 17. Snap Ring | | |

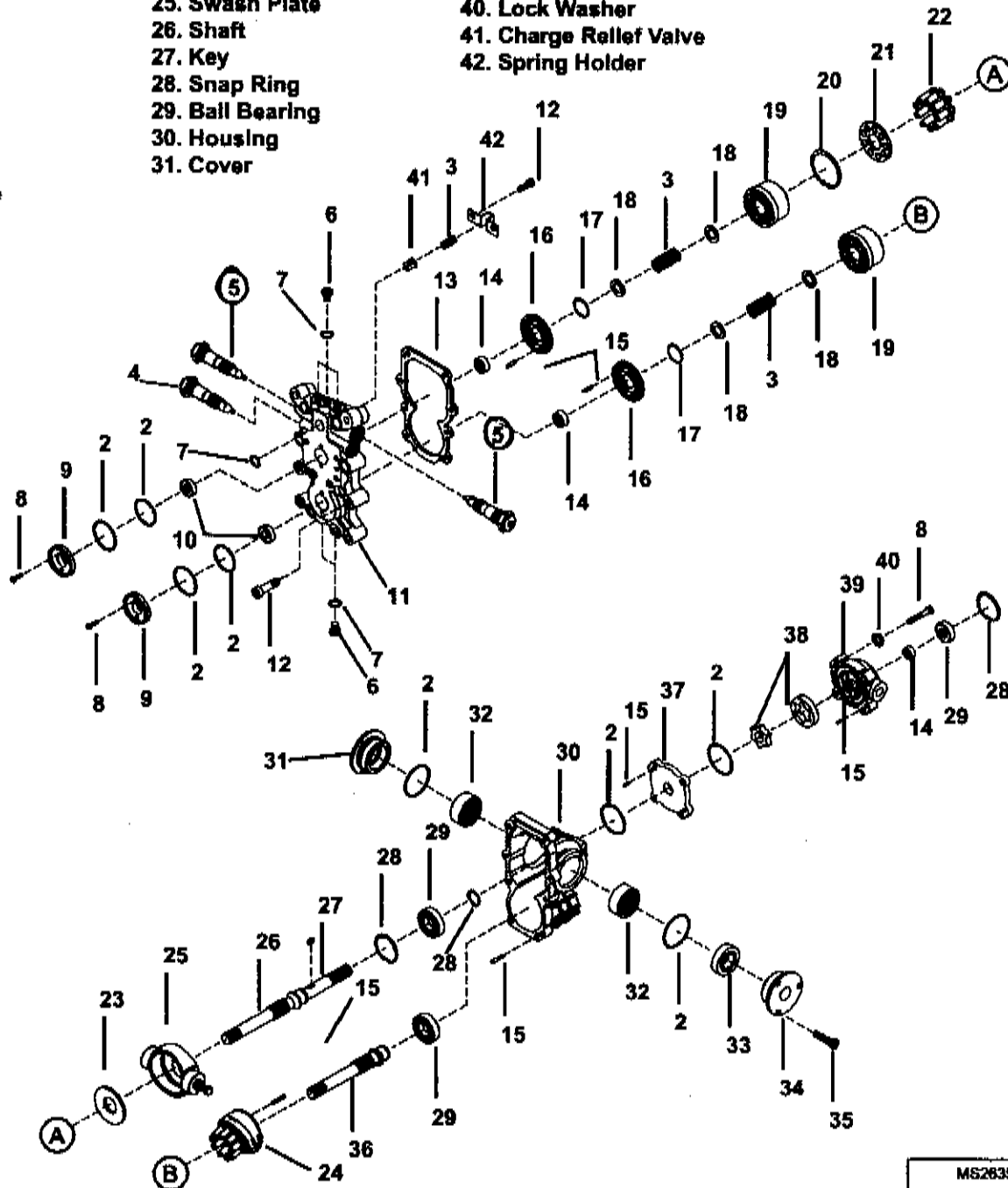

MS2635S

Dealer Copy -- Not for Resale