

PC9456 30-16 300, 300X and 300CX Loaders / HYDRAULIC HOSES AND OIL TUBES - THIRD FUNCTION (300CX) [B21] PC9456 - WELAND

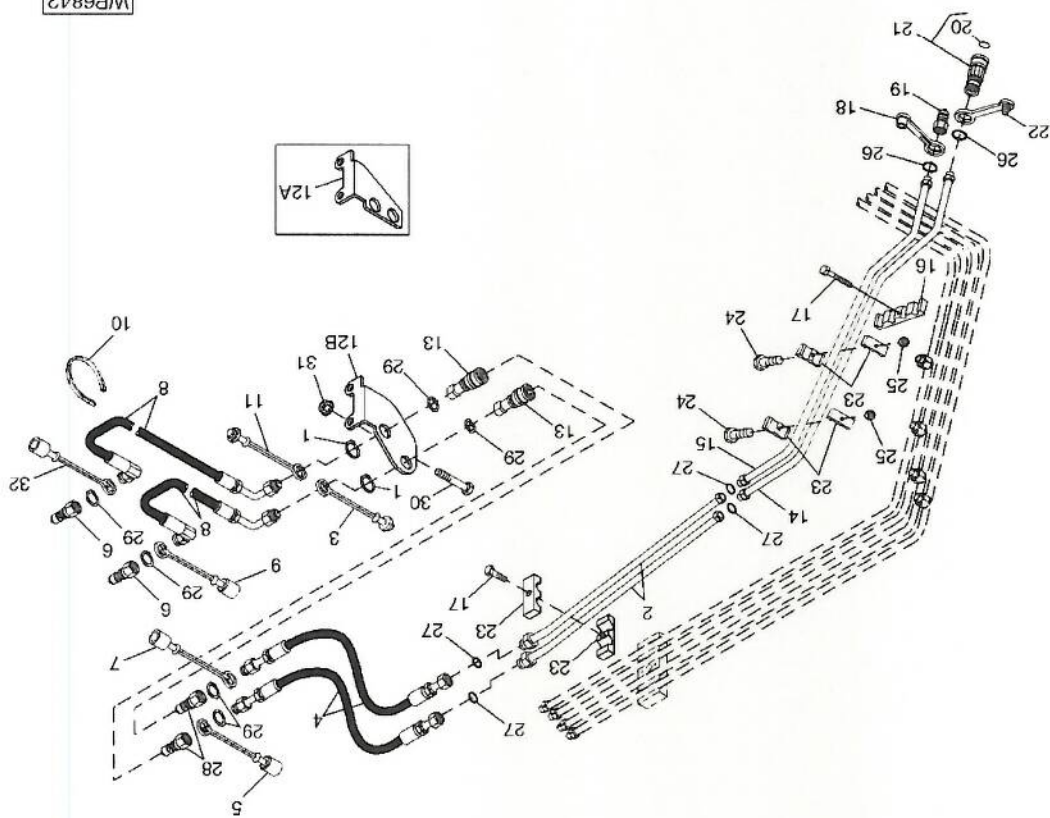

WP6842

David. Femberon @ cogeco.ca

Part List
PC9456 30-16 300, 300X and 300CX Loaders / HYDRAULIC HOSES AND OIL TUBES - THIRD FUNCTION (300CX) [B21] PC9456 - WELAND

KEY	PART NO.	PART NAME	QTY	SERIAL NO.	300	300X	300CX	REMARKS
1	M42702	SNAP RING	2					
2	AW32609	LINE	2					
3	W45635	PLUG	1					(A) ORANGE
3		PLUG	1					(B) (C) (ORANGE)
4	AW30147	HYDRAULIC HOSE	2					3/4" X 1 800 MM (70-3/4") X 11/16"
5	W45608	Cap	1					(A) (ORANGE)
5		Cap	1					(B) (C) (ORANGE)
6	AR94522	HYDR.Quick COUPLER PLUG	2					
7	W45609	Cap	1					(A) (BLUE)
7	W42991	Cap	1					(A) (GREEN)
7		Cap	1					(B) (C) (GREEN)
8	AW30239	Hose	2					3/4" X 2300 MM (90-1/2") X 3/4"
9	W42411	Cap	1					(A) (BLACK)
9		Cap	1					(B) (C) (ORANGE)
10	R105388	TIE BAND	4					
11	W45634	PLUG	1					(A) (BLUE)
11		PLUG	1					(B) (C) (GREEN)
12A	W45797	Bracket	1					(SUB FOR W52215)
12B	W53059	Bracket	1					(SUB FOR W52215)
13	LVA12997	HYD.Quick-CONNECT COUPLER	2					(A) (SUB FOR AM105466, THIS APPLICATION) 3/8"
13	LVA13231	HYD.Quick-CONNECT COUPLER	2					(B) 1/2" COUPLER
14	AW32982	OIL LINE	1					
15	AW32983	OIL LINE	1					
16	W44542	BLOCK CLAMP	1					
17	W52153	Screw	2					(SUB FOR 19M8040, THIS APPLICATION)
18	M70728	Cap	1					(BLACK)
18	W53377	Cap	1					1/4" (GREEN)
19	X4010-16	HYDR.Quick COUPLER PLUG	1					(SUB FOR AW32184)
20	32246	O-RING	1					
21	AM102487	HYD.Quick-CONNECT COUPLER	1					
22	M85099	PLUG	1					(A) (BLACK)
22	W53387	PLUG	1					1/4" (ORANGE)
23	W50244	HOSE CLAMP	6					
24	19M7286	CAP SCREW	2					M6 X 25
25	14M7272	NUT	2					M6
26	R26448	O-RING	2					
27	T77613	O-RING	4					
28	AM105467	HYDR.Quick COUPLER PLUG	2					(A)
28	AR94522	HYDR.Quick COUPLER PLUG	2					(B)
29	R26375	O-RING	6					
30	19M7286	CAP SCREW	2					M6 X 25
31	14M7272	NUT	2					M6
32		Cap	1					(B) (C) (GREEN)
	AW28043	PLUG	1					DUST CAP AND PLUG
								1/2" (CONTAINS (6) COLOR CAPS AND (6) COUPLER COLOR PLUGS)
								1/2" (CONTAINS (4) CONVERSION)
								AR94522 AND (4)

COLOR DUST CAPS)