

REF NO.	PART #	DESCRIPTION	QTY	S/NS
1	10032418001	Joint	1	S
2	05620006030	Pin, Clevis	1	S
3	05200125016	PIN, Split Dia. 2.5x16	1	S
4	10032419001	LINK, Valve	1	S
5	10032414000	SHAFT, Link	1	S
6	10032415000	SHIFTER, Valve	1	S
7	11352426000	PLATE	1	S
8	A3010108002	Nut M8	4	S
9	05500008016	PIN, Spring Dia. 8x16	1	S
10	19642453AG0	LEVER Assy	1	S
11	07420100600	E-RING	1	NS
12	A0400106012	BOLT 7T	1	S
13	03500140818	WASHER M8	1	S
14	031212559000	LINER THRUST	2	NS
15	03560101201	SPRING, Conical	4	S
16	10032425AG0	PLATE	1	S
17	19642456000	PLATE	1	S
18	19642457000	Bracket	1	S
19	07961012120	BUSHING	1	S
20	F1540108020	BOLT, W/Washer M8X20	2	S
21	19652458AG0	SHAFT	1	S
22	19041264000	LINING, Brake	1	S
23	10032413000	SHIFTER Feed Back	1	S
24	10032409AG0	ARM, Feedback	1	S
25	05500005032	PIN, Spring Dia. 5x32	1	S
26	10212428AG0	PIN, Joint	1	S
27	07420100800	E-RING Dia. 8	1	S

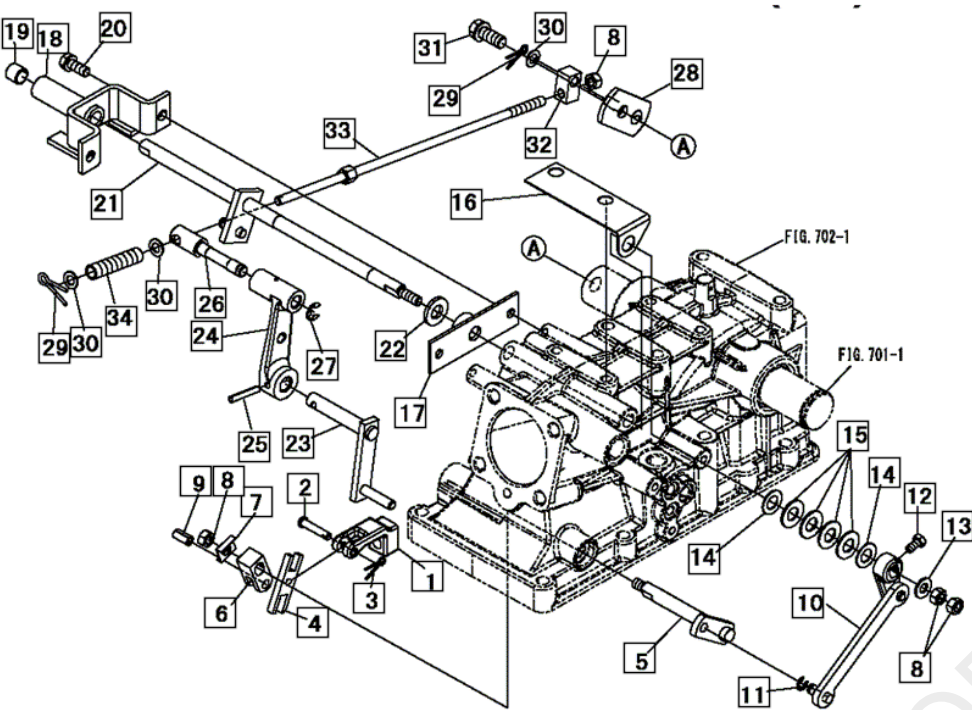

REF NO.	PART #	DESCRIPTION	QTY	S/NS
28	10032406AG0	Plate	1	S
29	05200125016	PIN, Split Dia. 2.5x16	2	S
30	03500130815	WASHER M8	3	S
31	F1550110025	BOLT, W/Washer - M10x25	1	S
32	10032407AG0	JOINT	1	S
33	10032408000	LINK, Feedback	1	S
34	10032412000	SPRING	1	S