

B2710HSD -> ENGINE -> 000102 CRANKCASE ## B2710HSD

Update Date: 01/13/2016, Printing Date: 06/20/2016

NOTE:ORDER BY REF.No.010 NEW PART and Fig.No.0007 REF.No.040.

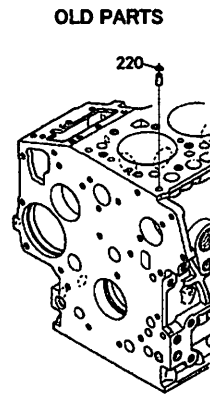
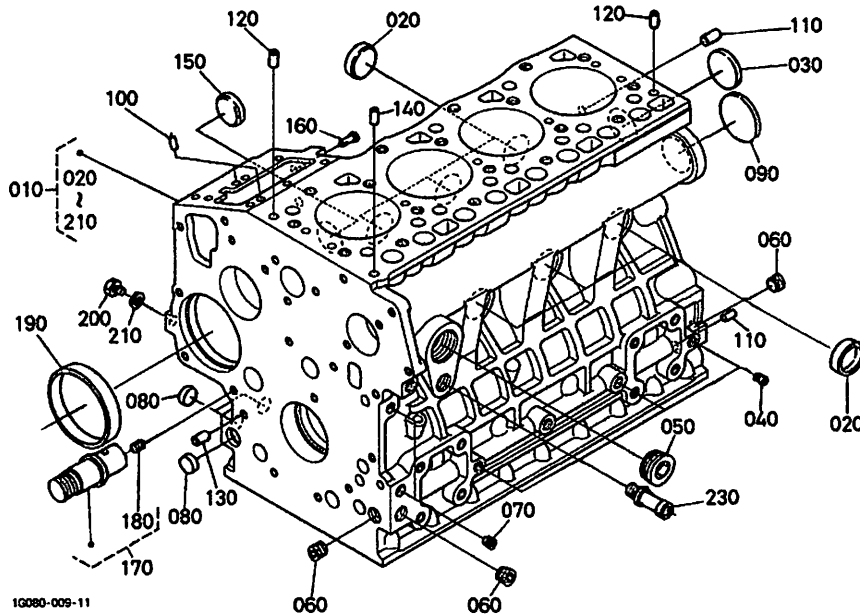

1G093-800-10

Interchangeable =, Not Interchangeable NI, New for Old >>, Old for New <<

No	Part Number	Part Name	Qty	IC	S/N	Remarks	lbs
010	1G072-01010	COMP.CRANKCASE	1			SEE NOTE	99.0
010	1G072-01012	COMP.CRANKCASE	1	=			101.2
020	15451-96270	CAP,SEALING	6				0.022
030	15221-03490	CAP,SEALING	1				0.044
040	15261-96010	PLUG	4				0.0044
050	16683-96020	PLUG	1				0.1936
060	16241-96010	PLUG	3				0.0154
070	15521-96020	PLUG	2				0.0066
080	17391-96160	PLUG,EXPANSION	3				0.0066
090	16271-96160	PLUG,EXPANSION	1				0.055
100	05012-00508	PIN,STRAIGHT	2				0.0022
110	05012-00814	PIN,STRAIGHT	2				0.0132
120	16221-94520	PIN,STRAIGHT	2				0.011
130	15231-33960	PIN,PIPE	2				0.0022
140	16241-33650	PIN,PIPE	1				0.0044
150	16241-96262	PLUG,FUEL CAMSHAFT	1				0.0154
160	16221-56280	PIN,START SPRING	1				0.011
170	16251-24060	SHAFT,COMP(IDLE)	1				0.395
180	15521-93610	SCREW,SET	1				0.0044
190	16271-55350	BUSH,GOVERNOR GEAR	1				0.132
200	15469-33610	PLUG	1				0.0176
200	15221-33610	PLUG	1	=			0.0198
210	15021-33660	PACKING	1				0.0022
220	15221-33700	O RING	1		<=5D0157		0.0022
230	15321-73340	PIPE(WATER RETURN)	1				0.0352