

INSTRUCTION MANUAL REAR WORKING LIGHT KIT (K2561-96291) for KUBOTA TRACTOR BX1880 / BX2380 / BX2680 / BX23S

■ Checking Parts

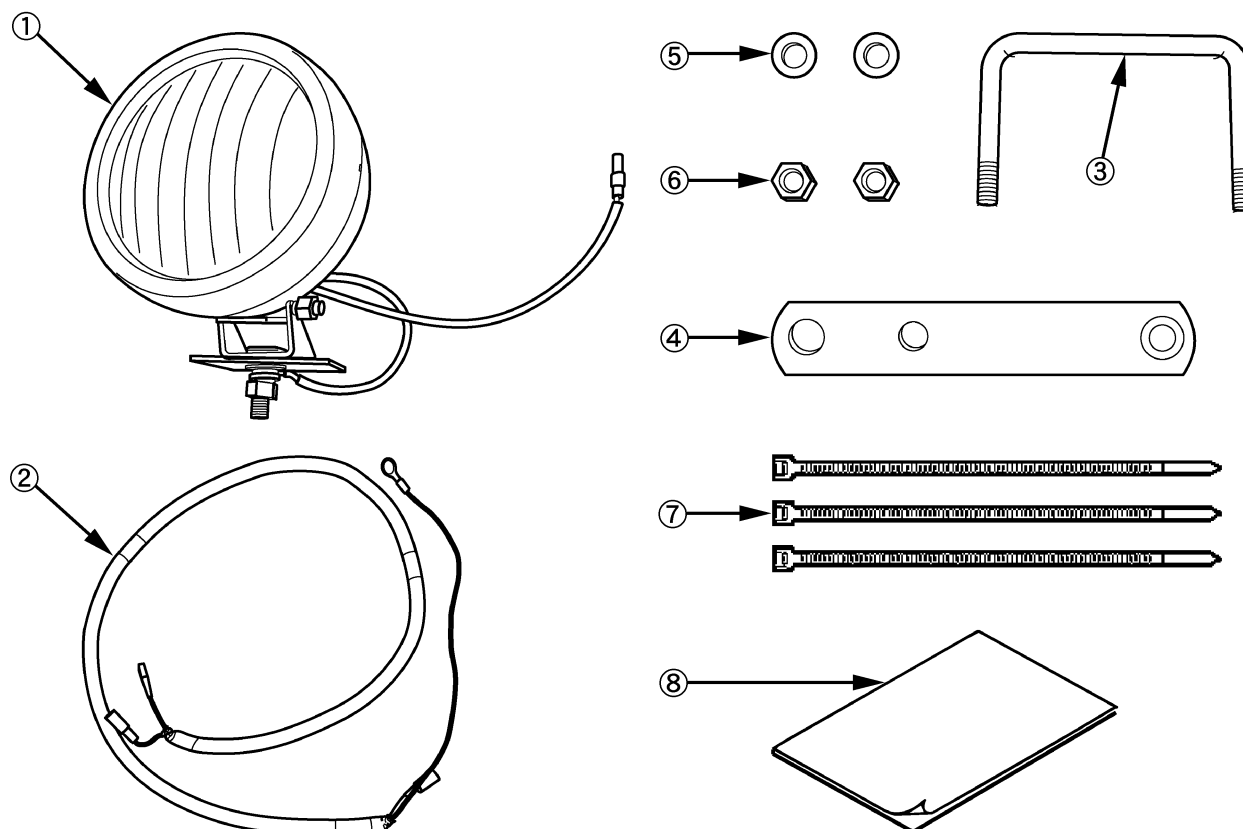

4CAKBGVAP025A

REF. No.	PART No.	PART NAME	Q'ty	REMARKS
1	K2561-9630-0	LAMP (WORKING)	1	
2	K2561-9622-0	WIRE HARNESS, W.LIGHT	1	
3	K2561-9624-2	ROD, U THREAD	1	
4	K2561-9625-0	PLATE, WORKING LIGHT	1	
5	75599-3301-2	WASHER, SPRING LOCK (5/16)	2	
6	02054-50080	HEX. NUT	2	M8
7	K2561-9626-0	TIE, RELEASABLE	3	
8	K2561-9631-1	MANUAL, ASSEMBLY WORKING LIGHT	1	This paper

NOTE :

- Check the component parts according to the parts list.

■ Installation



WARNING

To avoid personal injury or death:

- Park the machine on firm and level surface.
- Lower the implement to the ground.
- Apply the parking brake.
- Stop the engine and remove the key.
- Battery gases can explode. Keep cigarettes, sparks, and flames away from battery.
- If the machine battery is frozen, do not jump start the engine.
- Do not connect the other end of negative jumper cable to the negative terminal of the machine battery.

1. Disconnect the negative cable from the battery.
2. Remove the nut, washer, spring washer and ring terminal from the work light.
3. Assemble the work lamp and the working light plate with the original nut, plain washer, spring washer and ring terminals.

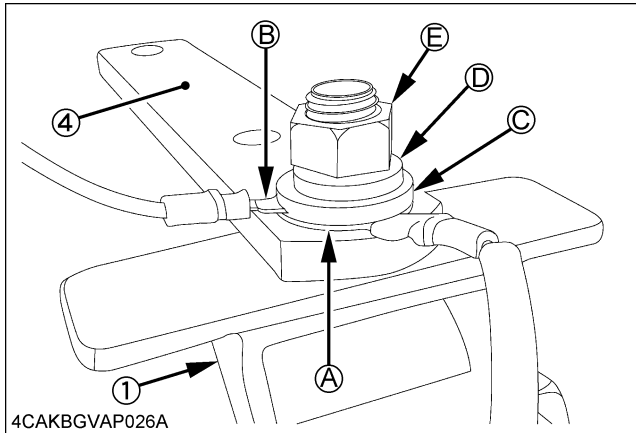

- (1) LAMP (WORKING) (A) Ring terminal (LAMP, WORKING)
 (4) PLATE, WORKING LIGHT (B) Ring terminal (wire harness)
 (C) Plain washer
 (D) Spring washer
 (E) Nut

4. Connect the work light harness to wire harness.

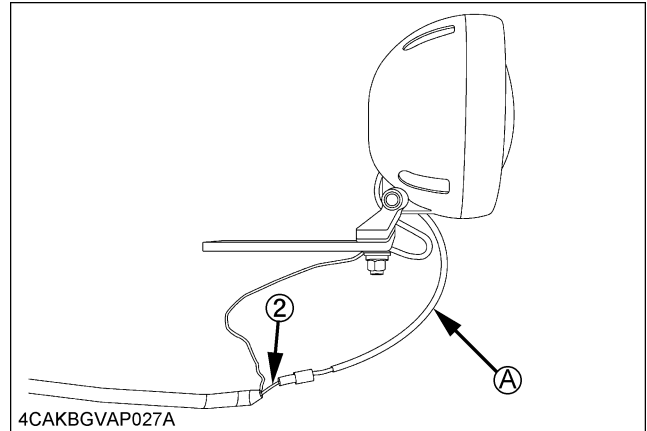

- (2) WIRE HARNESS, W.LIGHT (A) Working light harness

5. Install the work lamp to ROPS with the U rod, spring lock washer and nut.

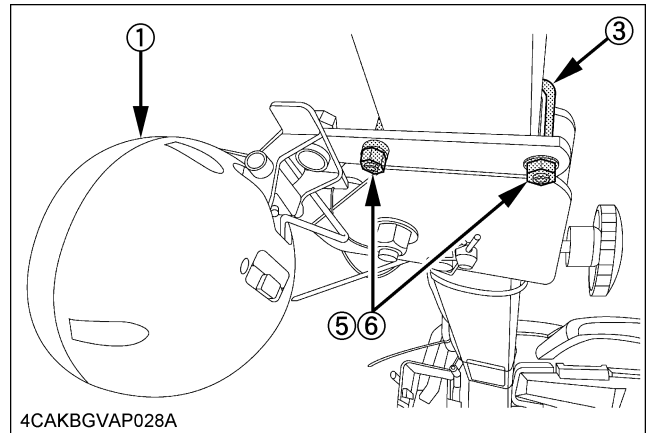

- (1) LAMP (WORKING) (5) WASHER, SPRING LOCK (5/16)
 (3) ROD, U THREAD (6) HEX. NUT

6. Route the wire harness along ROPS and clamp it.

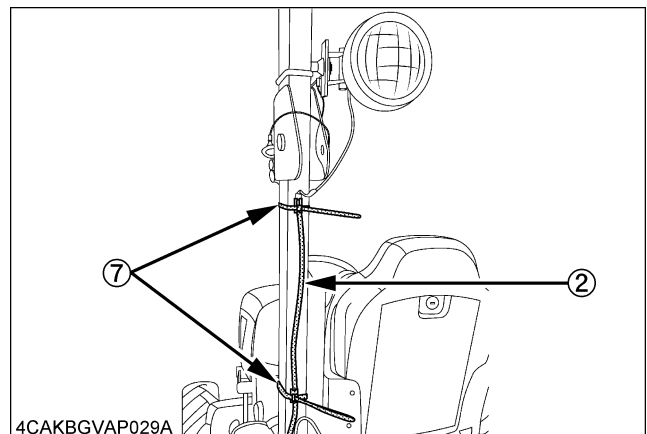

- (2) WIRE HARNESS, W.LIGHT (7) TIE, RELEASABLE

7. Remove the blue tape covering the coupler of the main harness. Connect the 2 couplers of the wire harness to the main harness.

- Connect the wire harness (red) to main wire harness (red-black / without tag).
- Connect the wire harness (black) to main wire harness (black).

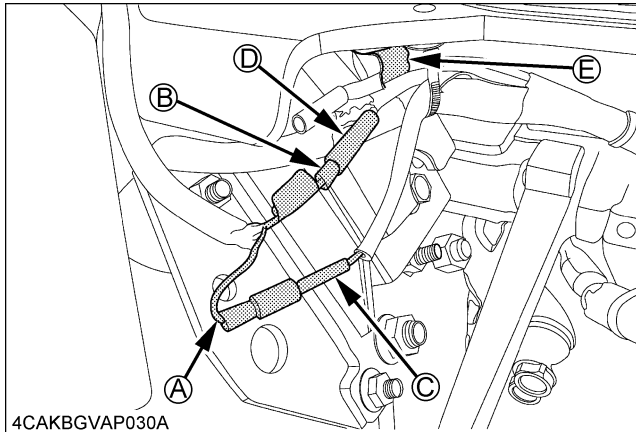

- (A) Wire harness (black) (D) Main wire harness
(B) Wire harness (red) (red-black / without tag)
(C) Main wire harness (black) (E) Tag

8. Clamp the wire harness and the main wire harness.

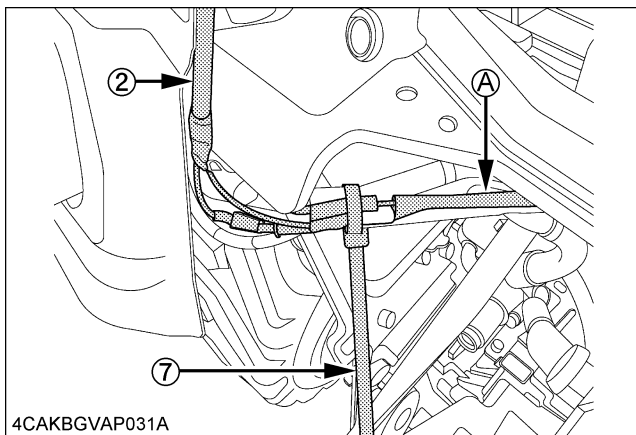

- (2) WIRE HARNESS, W.LIGHT (A) Main wire harness
(7) TIE, RELEASABLE

9. Connect the battery negative cable.
10. Turn on the work lamp switch.

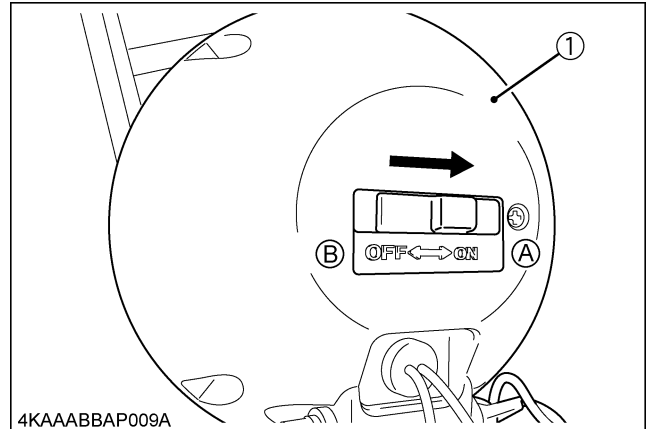

- (1) LAMP (WORKING)
(7) TIE, RELEASABLE

- (A) "ON"
(B) "OFF"