

# VALVE ASSEMBLY

ASSEMBLY #2237

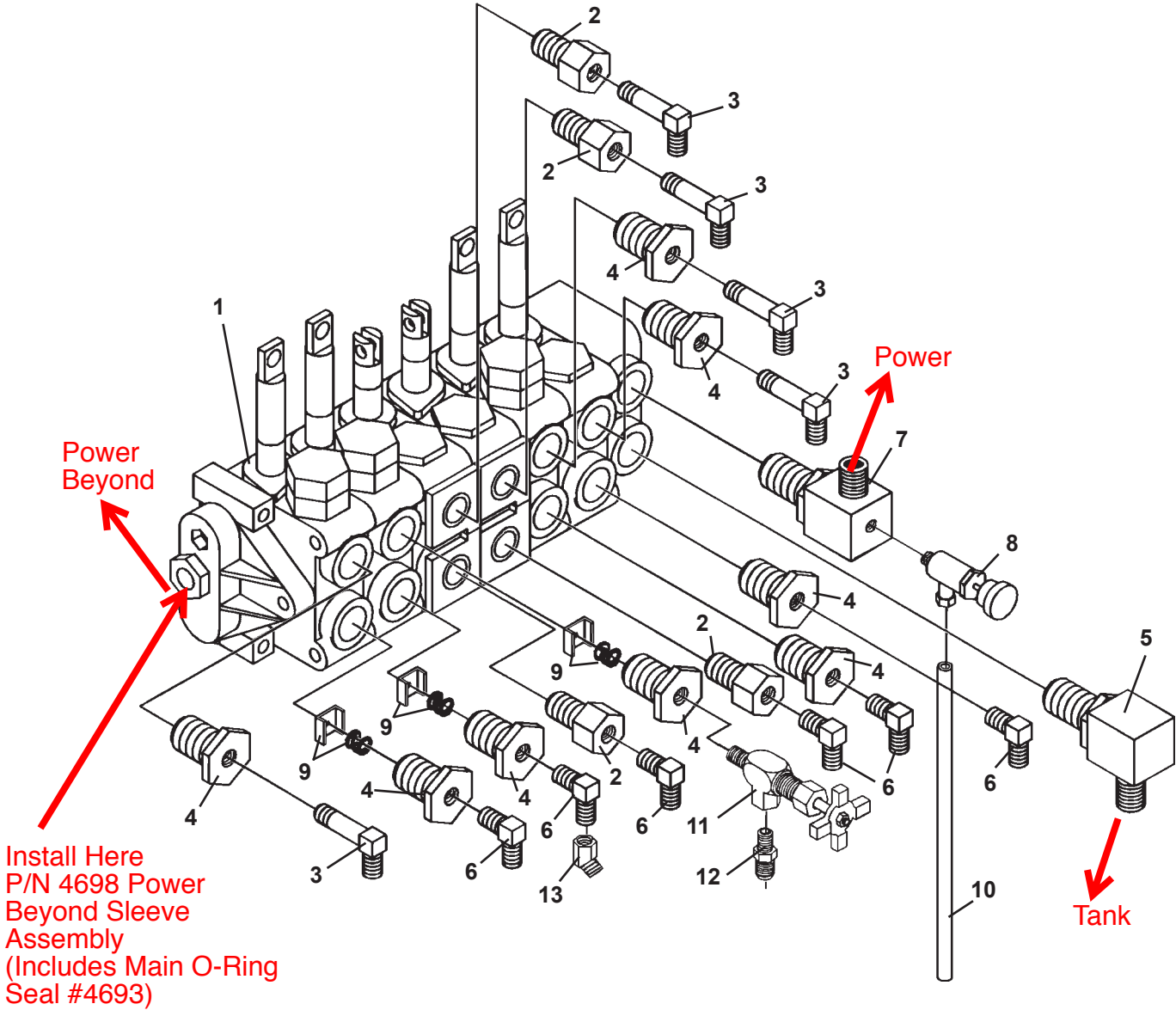

# VALVE ASSEMBLY

509, 511, 609 & 611 BACKHOE VALVE ASSEMBLY

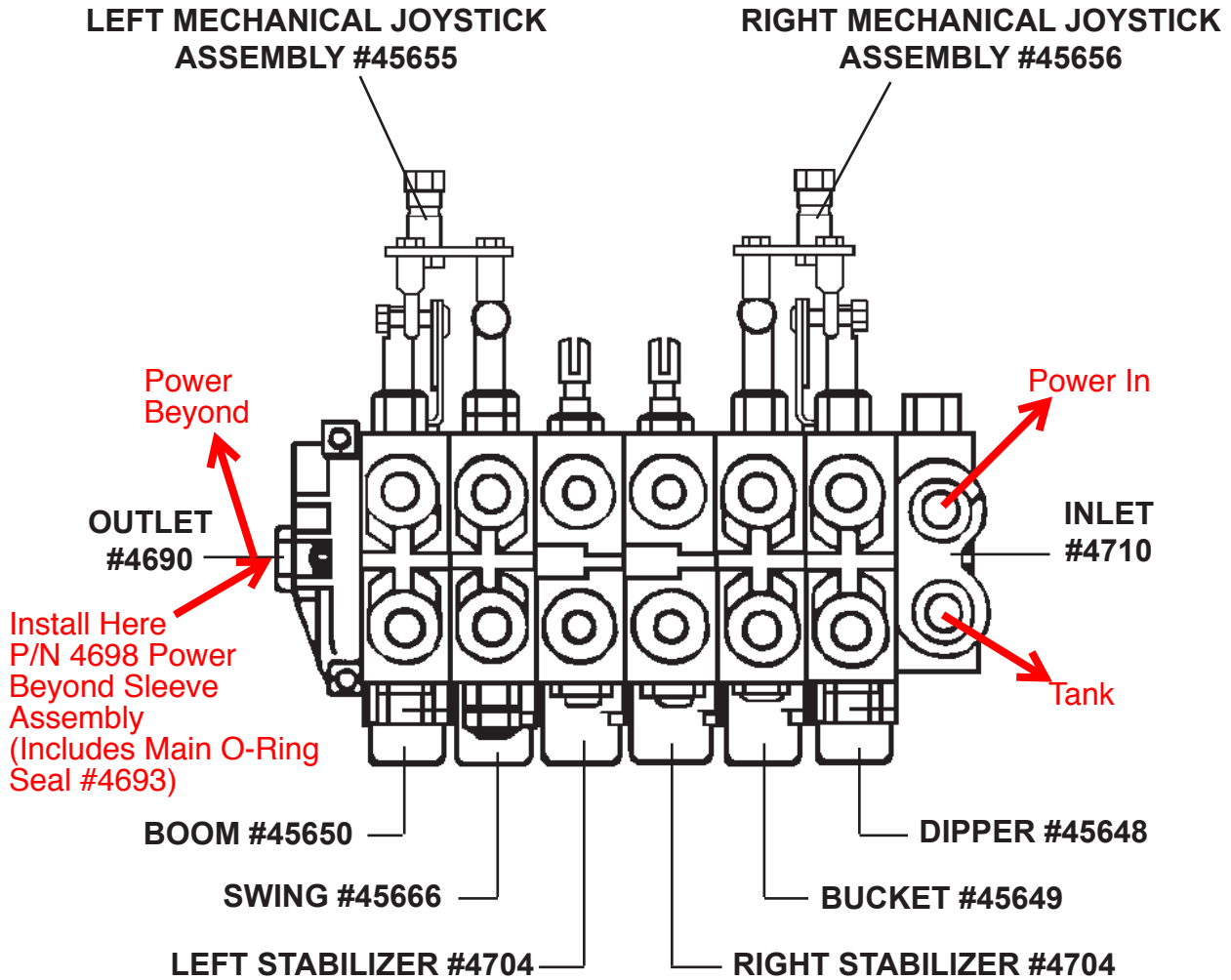

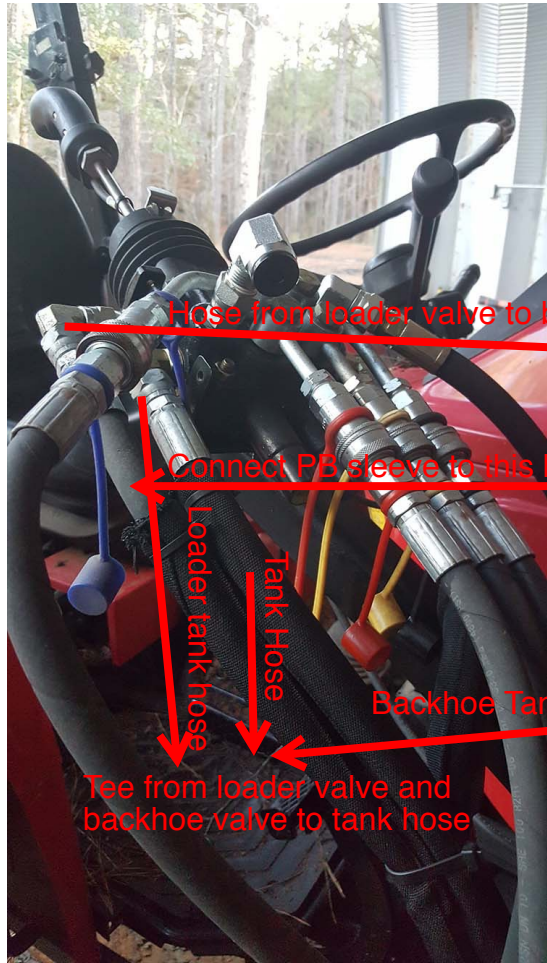

Hose from loader valve to backhoe valve

Connect PB sleeve to this hose

Loader tank hose

Tank Hose

Backhoe Tank Hose

Tee from loader valve and backhoe valve to tank hose

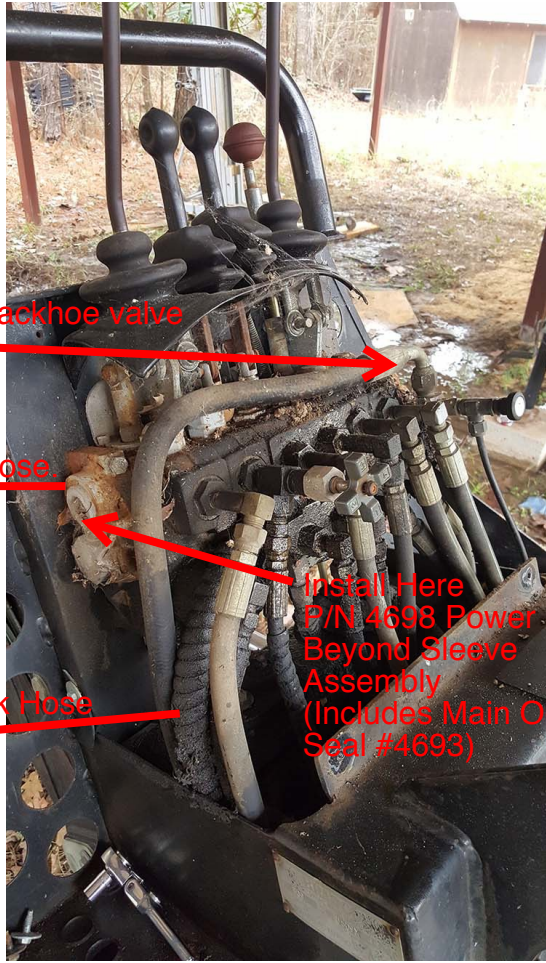

Install Here  
P/N 4698 Power  
Beyond Sleeve  
Assembly  
(Includes Main O-Ring  
Seal #4693)