

## ASSEMBLY [L3560, L4060, L4760, L5060, L5460, L6060 ROPS Model]

### ■Preparation

1. Detach the rear tire from the tractor.

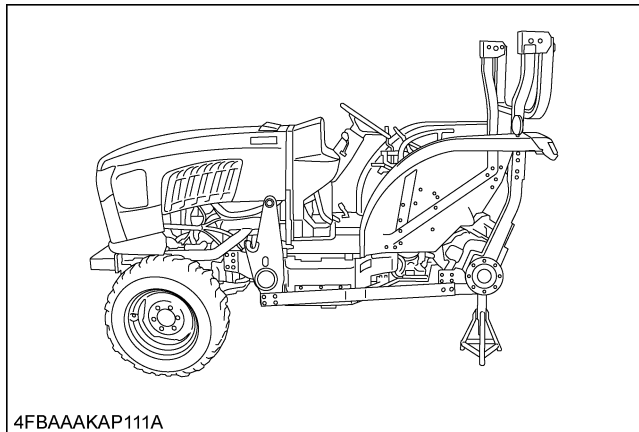

### ■Sub Frame

1. Detach the front loader sub frame.

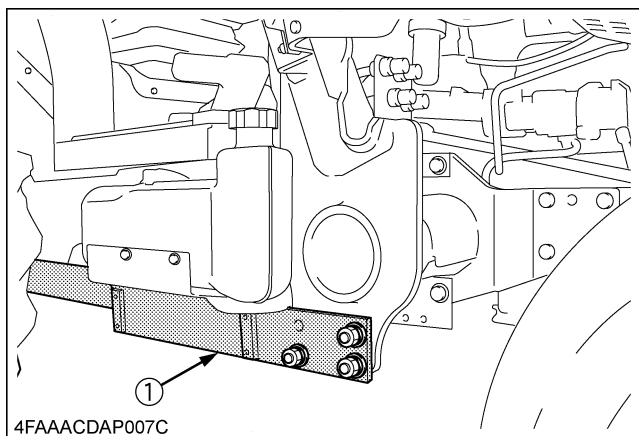

(1) Sub frame

2. Detach the collar and attach the rear bracket in place.

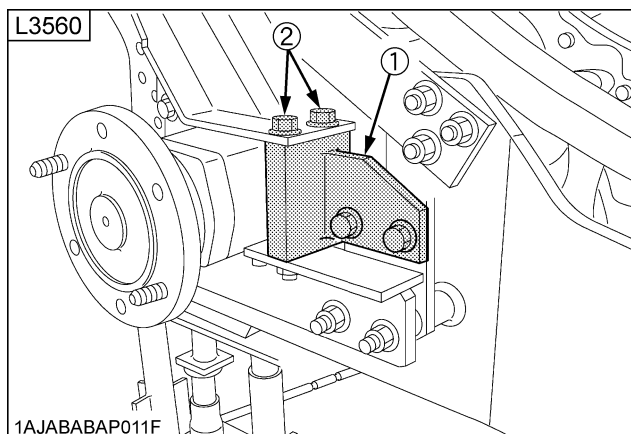

(1) Rear bracket

(2) 2 - M14 x 148 bolts [Original bolts]

2 - M14 spring lock washers

Tightening torque: 167 to 196 N·m

(17.0 to 20.0 kgf·m, 123 to 144 lbf·ft)

3. Attach the rear bracket in place.

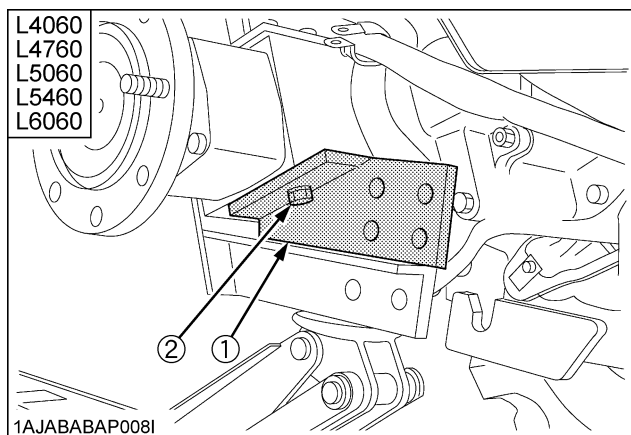

(1) Rear bracket

(2) 2 - M14 x 30 bolts

2 - M14 spring lock washers

Tightening torque: 124 to 147 N·m

(12.6 to 15.0 kgf·m, 91.5 to 108.4 lbf·ft)

4. Tighten a bolt only one of the front of a sub frame and lift the back end of the sub frame using a hoist.

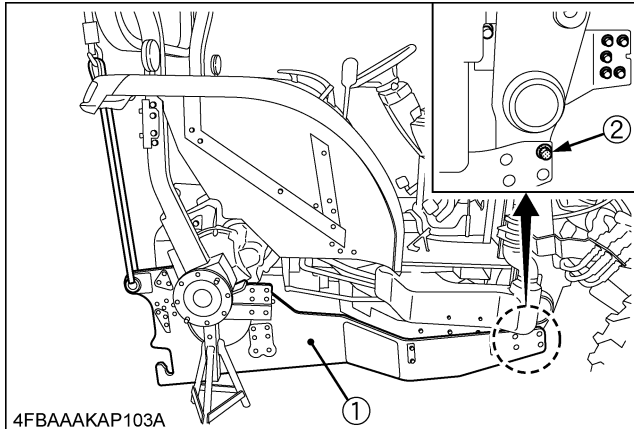

- (1) Sub frame  
 (2) 1 - M16 x 60 bolt  
       1 - 5/8 hardened plain washer  
       1 - M16 spring lock washer  
       1 - M16 nut

**IMPORTANT :**

- Be sure to apply a nylon strap to the back end of the sub frame for hoisting it.
- If the rear of the sub frame is raised too much with a crane, it will hit the fuel tank. Take much care not to hit it when raising the rear of the sub frame.

5. Temporarily tighten the bolts and nuts in place.

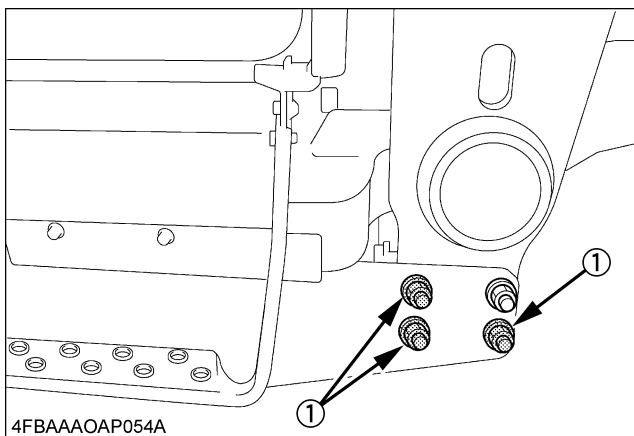

- (1) 3 - M16 x 60 bolts  
       3 - 5/8 hardened plain washers  
       3 - M16 spring lock washers  
       3 - M16 nuts

Tightening torque: 196 to 225 N·m  
 (20.0 to 23.0 kgf·m, 145 to 166 lbf·ft)

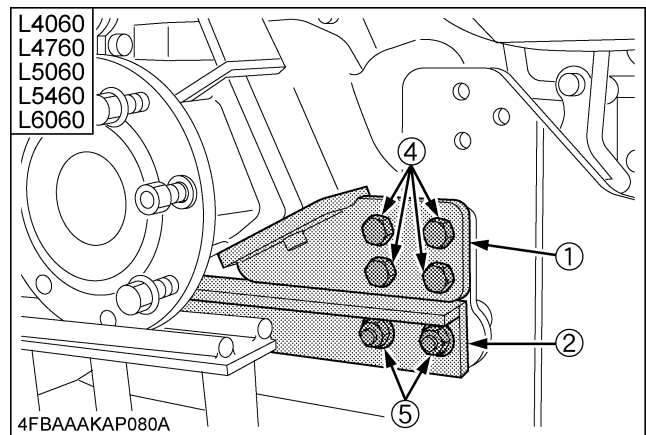
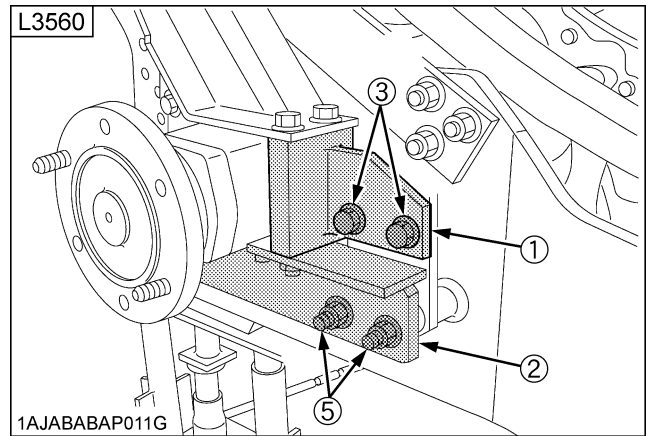

- (1) Rear bracket  
 (2) Frame  
 (3) 2 - M16 x 50 bolts  
       2 - 5/8 hardened plain washers  
       2 - M16 spring lock washers  
       2 - M16 nuts  
 (4) 4 - M16 x 50 bolts  
       4 - 5/8 hardened plain washers  
       4 - M16 spring lock washers  
       4 - M16 nuts  
 (5) 2 - M16 x 140 bolts  
       2 - 5/8 hardened plain washers  
       2 - M16 spring lock washers  
       2 - M16 nuts

Tightening torque: 196 to 225 N·m  
 (20.0 to 23.0 kgf·m, 145 to 166 lbf·ft)

**IMPORTANT :**

- If the number of bolts and that of hardened plain washers are the same, additionally put the hardened plain washers at the nut.

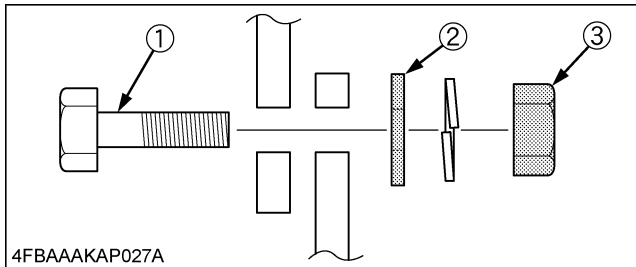

- (1) Bolt  
(2) Hardened plain washer  
(3) Nut

6. Wind the sealing tape around the joint coupler.  
Attach the female coupler and plug to joint coupler.

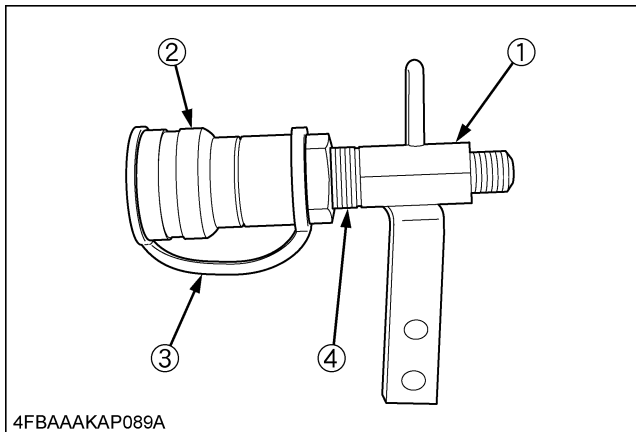

- (1) Joint coupler  
Thread size: 1/2 - 14 NPT  
Tightening torque: 49 to 58 N·m  
(5.0 to 5.9 kgf·m, 36 to 43 lbf·ft)
- (2) Female coupler  
(3) Plug  
(4) Sealing tape

7. Attach the frame support, connecting plate and joint stay.  
Attach the joint coupler to joint stay.

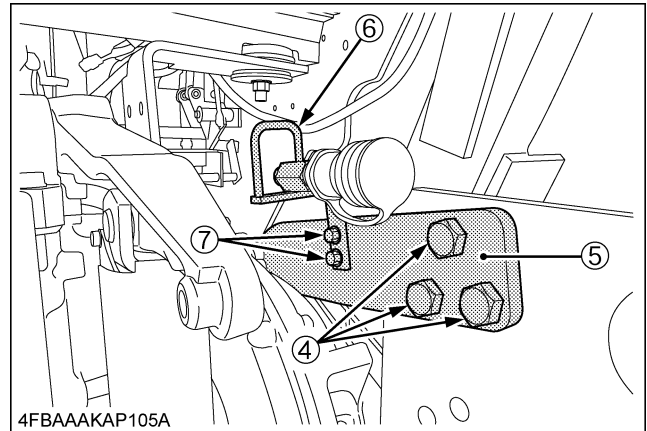
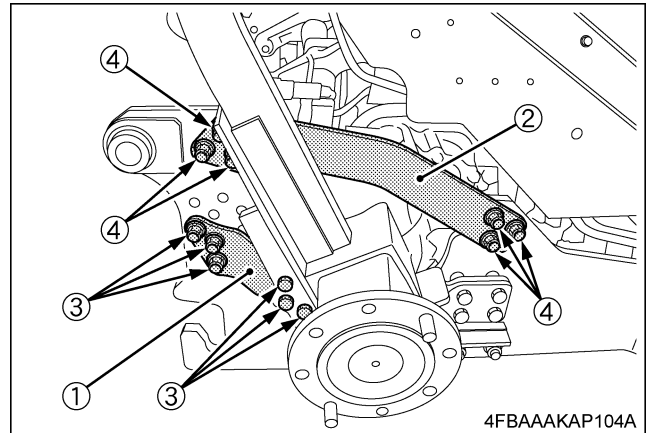

- (1) Frame support  
(2) Connecting plate  
(3) 6 - M16 x 50 bolts  
6 - 5/8 hardened plain washers  
6 - M16 spring lock washers  
6 - M16 nuts  
(4) 12 - M16 x 50 bolts  
12 - 5/8 hardened plain washers  
12 - M16 spring lock washers  
12 - M16 nuts  
(5) Joint stay [RH only]  
Tightening torque: 196 to 225 N·m  
(20.0 to 23.0 kgf·m, 145 to 166 lbf·ft)  
(6) Joint coupler  
(7) 2 - M8 X 20 bolts

**IMPORTANT :**

- Do not tighten fasteners until all components are assembled.
- Finally tighten the fasteners to the specified torque.

## ■Hydraulic Line

1. Remove each bolt and raise the operating seat. And then lock the seat.

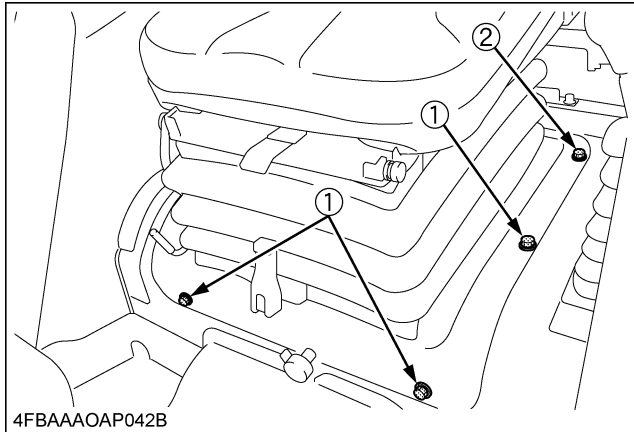

- (1) 4 - M8 bolts
- (2) 2 - M8 nuts

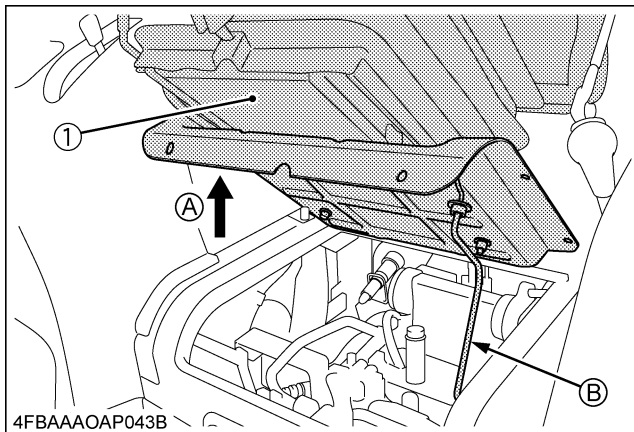

- (1) Operating seat
- (A) Raise
- (B) Lock the seat

2. Remove the bolt and tube.

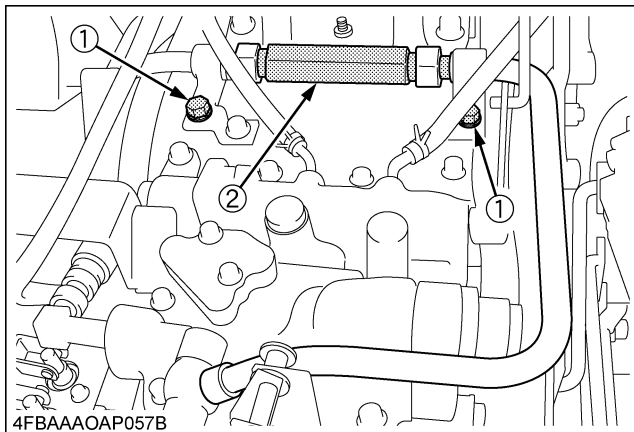

- (1) 2 - M8 bolts
- (2) Tube

3. Wind the sealing tape around the backhoe outlet hose. Attach sleeve by band cord, male coupler and cap to the outlet hose.

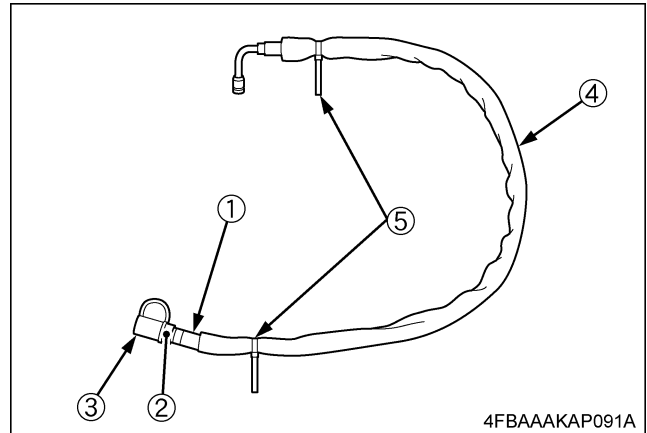

- (1) Backhoe outlet hose (Green)
- (2) Male coupler  
Thread size: 1/2 - 14 NPT  
Tightening torque: 49 to 58 N·m  
(5.0 to 5.9 kgf·m, 36 to 43 lbf·ft)
- (3) Cap
- (4) Sleeve
- (5) Band cord

4. Connect the joints as shown below and connect the backhoe inlet hose and backhoe outlet hose. Then tighten the bolts using torque.

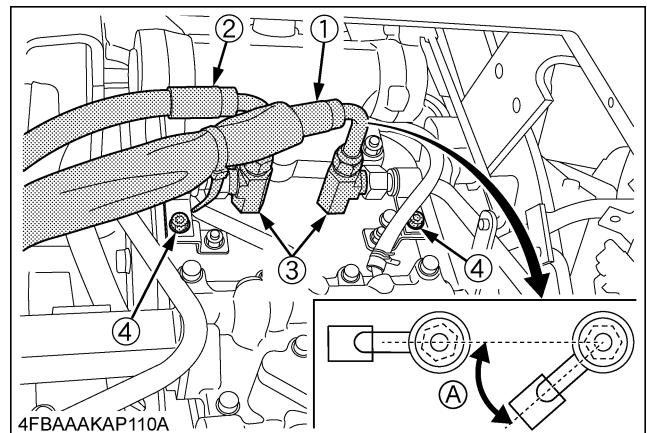

- (1) Backhoe outlet hose
- (2) Backhoe inlet hose  
Thread size: 3/4 - 16 UNF  
Tightening torque: 36 to 40 N·m  
(3.7 to 4.1 kgf·m, 27 to 30 lbf·ft)
- (3) Joint  
Tightening torque: 90 to 108 N·m  
(9.2 to 11.0 kgf·m, 67 to 79 lbf·ft)
- (4) 2-M8 bolts  
Tightening torque: 23.6 to 27.4 N·m  
(2.4 to 2.8 kgf·m, 17.4 to 20.2 lbf·ft)

(A) 10°

5. Connect the backhoe inlet hose to the coupler joint.

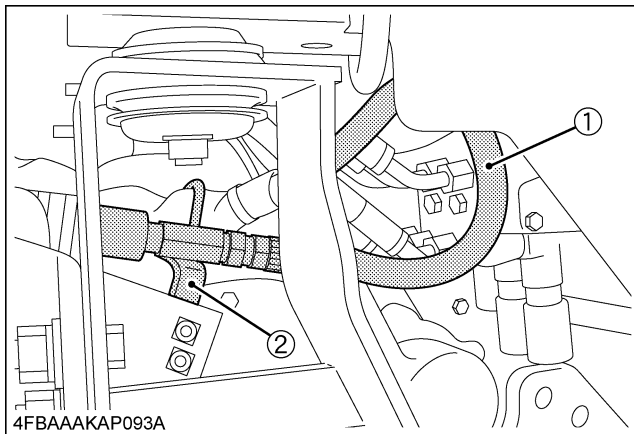

- (1) Backhoe inlet hose  
Thread size: 3/4 - 16 UNF  
Tightening torque: 36 to 40 N·m  
(3.7 to 4.1 kgf·m, 27 to 30 lbf·ft)
- (2) Coupler joint

6. Lower the operating seat and tighten each bolt.

7. Connect the male coupler to the female coupler.  
Pass the outlet hose through the coupler joint hose guide.

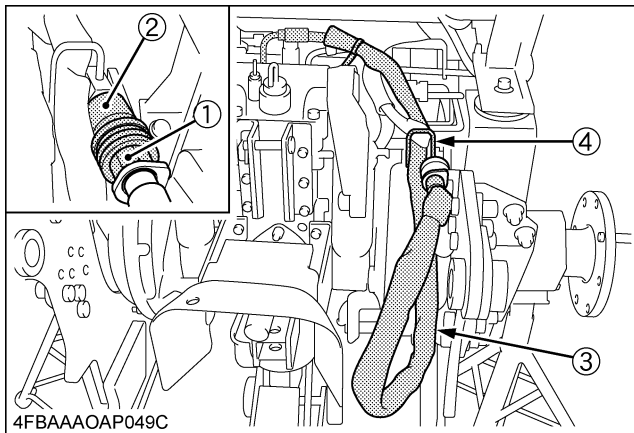

- (1) Male coupler  
(2) Female coupler  
(3) Outlet hose (Green)  
(4) Coupler joint

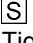
8.  Attach the operating seat to the floor seat cover.  
Tighten the bolts and nuts by correct tightening torque.

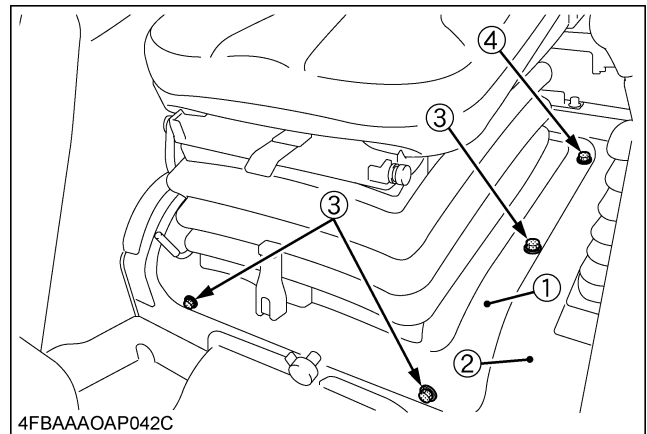

- (1) Operating seat  
(2) Floor seat cover  
(3) 4 - M8 bolts  
(4) 2 - M8 nuts  
Tightening torque: 23.6 to 27.4 N·m  
(2.4 to 2.8 kgf·m, 17.4 to 20.2 lbf·ft)

#### ◆ Rear wheels

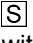
1.  Install the right and left rear wheels to the tractor with the bolts and nuts. Tighten the bolts and nuts by the correct tightening torque.

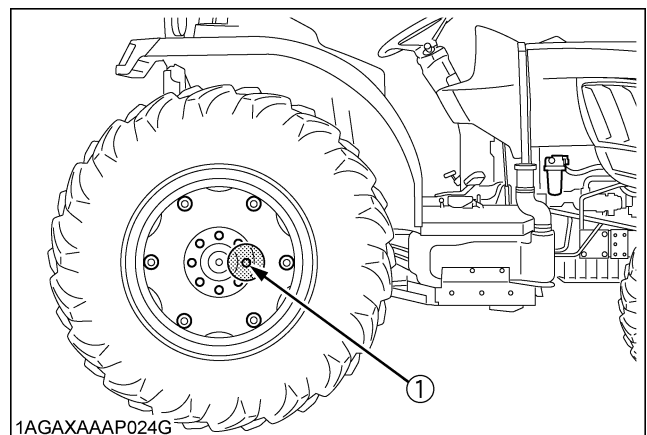

- (1) Tightening torque: 215 N·m  
(21.9 kgf·m, 158.6 lbf·ft)

- ◆ **Loader option**  
(When the machine is equipped with the 3rd function or the hydraulic 2 lever quick coupler)
1. Disconnect the loader option's hoses.

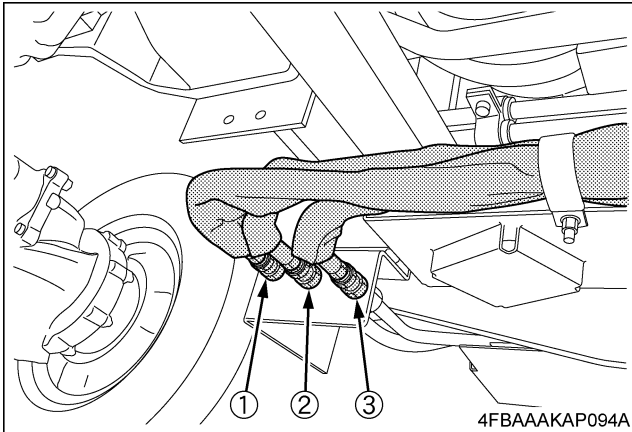

- (1) Hose (P.B) (Green)
- (2) Hose (OUT) (Gray)
- (3) Hose (IN) (Orange)

2. Remove the sub frame bolts first and then the optional valve cover.

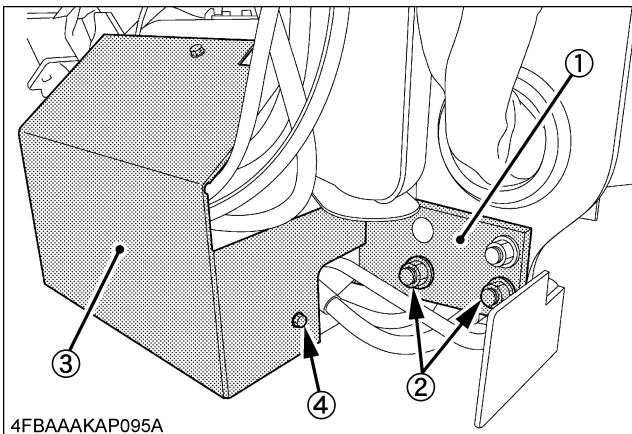

- (1) Sub frame
- (2) 2 - M16 nuts
- (3) Valve cover
- (4) 3 - M8 bolts

3. Disconnect the coupler, the relay and the band cord.

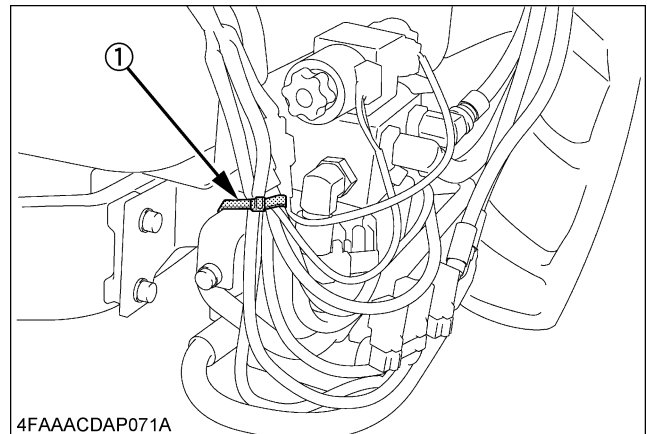

### [3rd function]

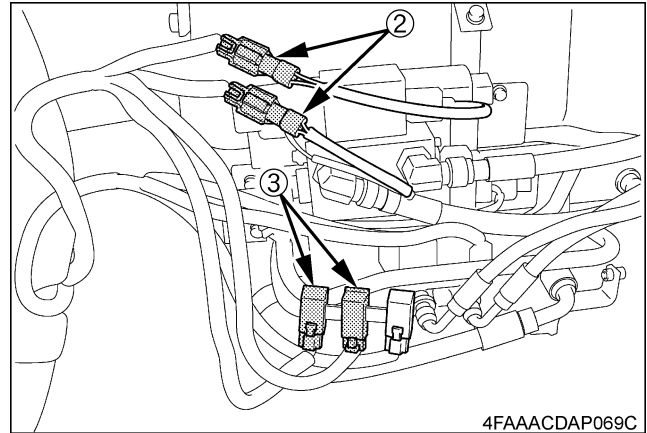

### [Hydraulic 2 lever quick coupler]

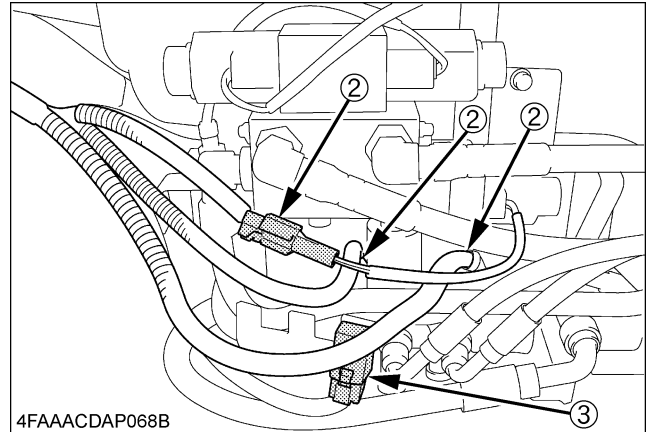

- (1) Band cord
- (2) Coupler
- (3) Relay

4. Disconnect the 3rd function hose and the hydraulic 2 lever quick coupler hose.  
Remove the bolts and take the valve out of the sub frame.

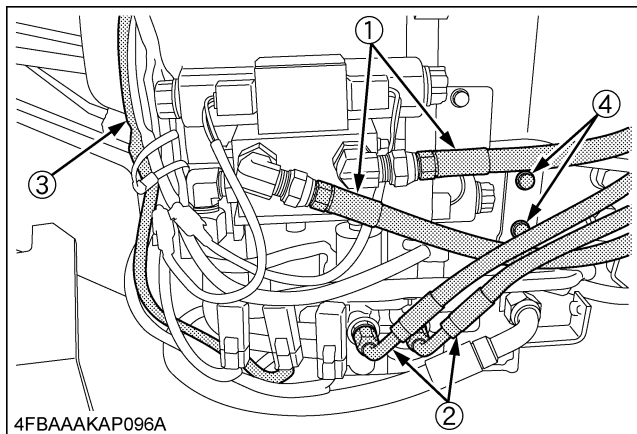

- (1) 3rd function hose
- (2) HYD. 2 lever quick coupler hose
- (3) Wire harness
- (4) 4 - M10 bolts

5. Dismount the loader sub frame.
6. Mount the backhoe sub frame instead.  
(For details, see "Sub Frame" in "ASSEMBLY [L3560, L4060, L4760, L5060, L5460, L6060 ROPS Model]" section.)
7. Disconnect the inlet hose (Green) from the tractor P.B. port.

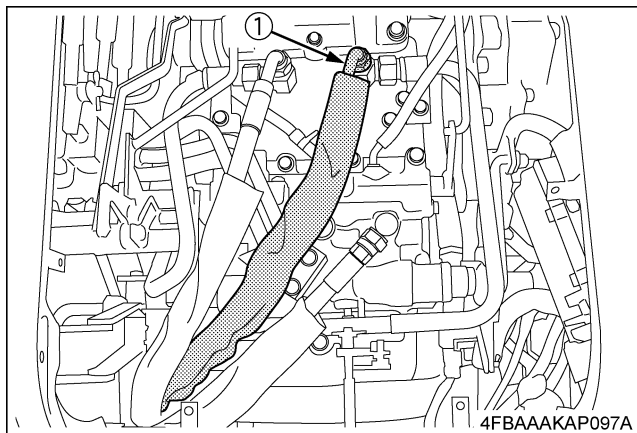

- (1) Inlet hose (Green)

8. Connect the inlet hose that was dismantled in the previous step to the coupler joint and angle to 55° to avoid contact with the rear lift arms as shown in picture.

9. Pass the backhoe outlet hose through the coupler joint hose guide and connect this hose to the tractor P.B. port.

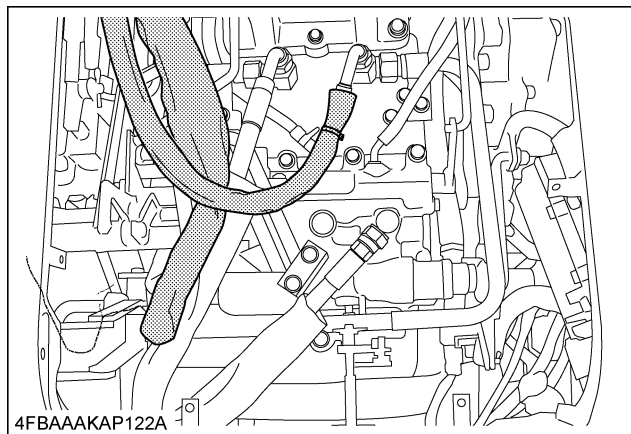
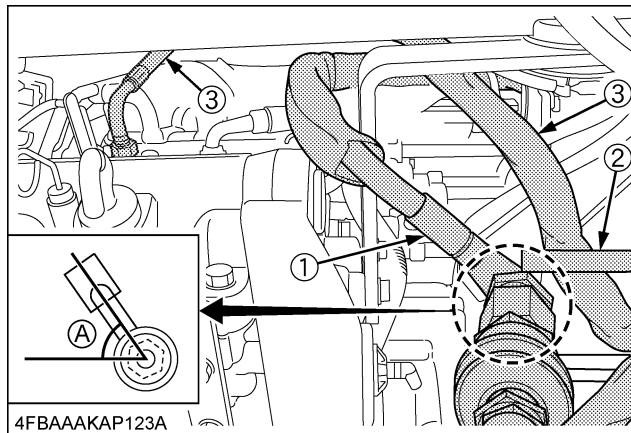

- (1) Inlet hose
  - (2) Coupler joint
  - (3) Backhoe outlet hose
- Thread size: 3/4 - 16 UNF  
Tightening torque: 36 to 40 N·m  
(3.7 to 4.1 kgf·m, 27 to 30 lbf·ft)

(A) 55°

10. Reattach the related parts in the reverse order of dismantling the loader option.  
(For details, refer to LA555, LA805, LA1055 ASSEMBLY INSTRUCTIONS.)
11. Ensure all hydraulic hose connection points torqued before starting the tractor.

## ■ Tool box

1. Detach the tool box from the tool box stay.

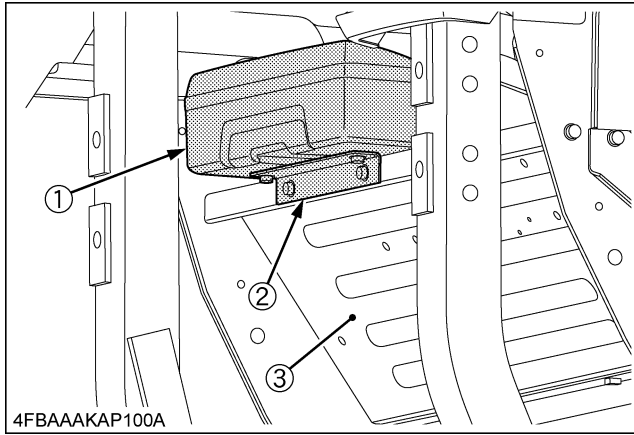

- (1) Tool box  
(2) Tool box stay  
(3) Floor seat

### NOTE :

- After detaching the tool box, secure its stay back in position in order not to lose it.

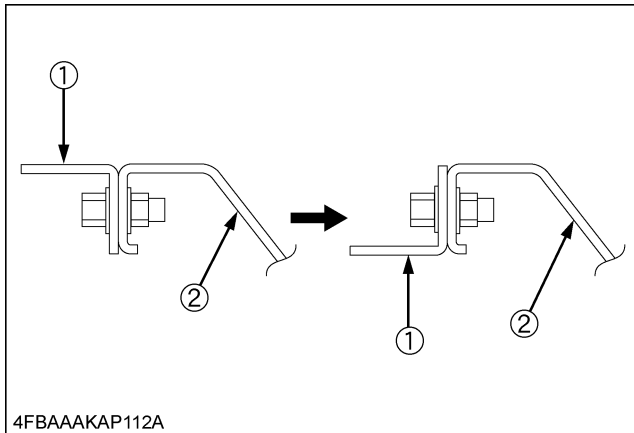

- (1) Tool box stay  
(2) Floor seat

2. Attach the tool box and the tool box stay to the left side of the tractor ROPS.

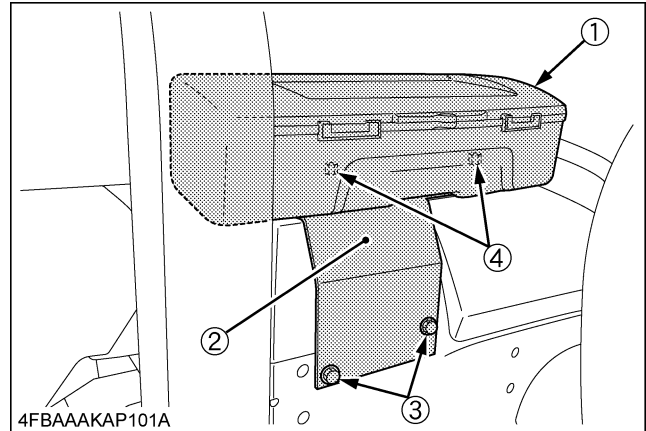

- (1) Tool box  
(2) Tool box stay  
(3) 2 - M8 x 16 bolts  
2 - M8 Flange nuts  
(4) 2 - M8 x 25 bolts



## ASSEMBLY [L3240-3 - L5740-3 CAB Model]

### ■ Preparation

1. Detach the rear tire, fender plate and operating seat from the tractor.

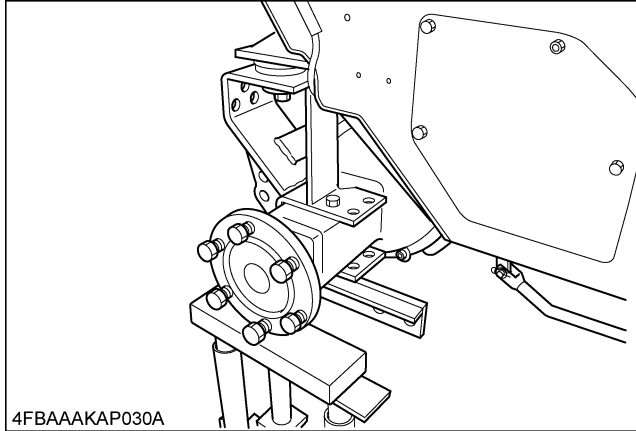

#### NOTE :

- Before detaching the operating seat, disconnect the OPC wire harness.

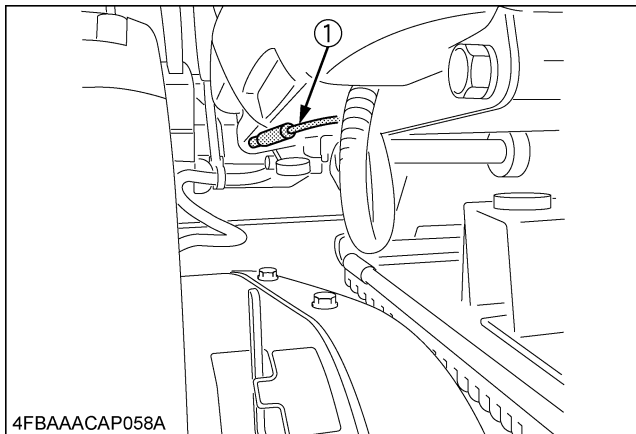

(1) OPC wire harness

### ■ Hydraulic Line

1. Disconnect the front loader power beyond tube.

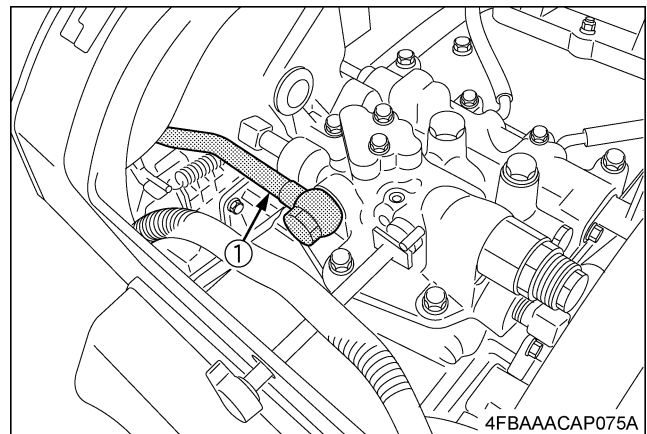
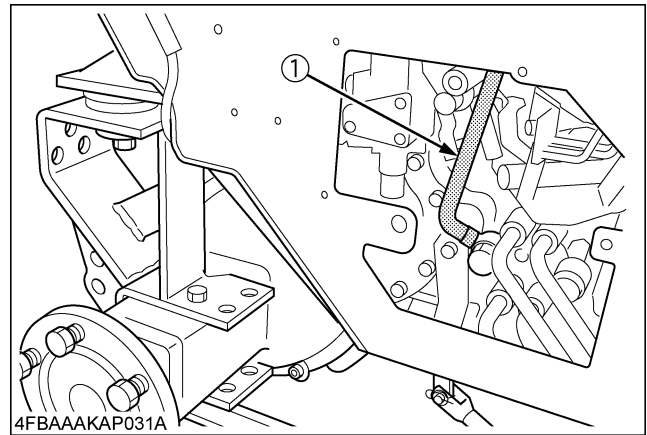

(1) Front loader power beyond tube

2. Connect the backhoe inlet tube to the power beyond port of the loader valve and the backhoe inlet hose to the backhoe inlet tube and coupler joint. Fix the coupler joint to the joint stay.

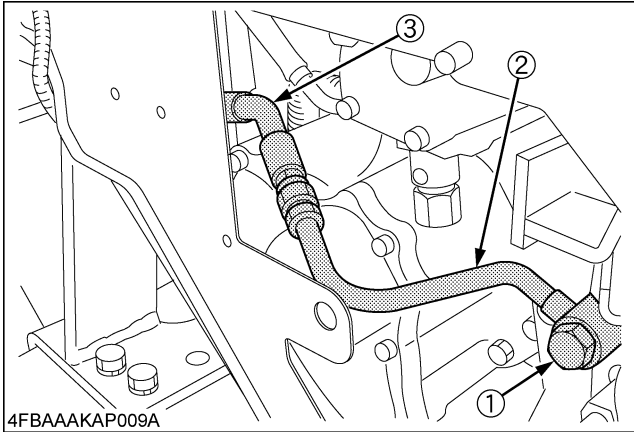

- (1) Power beyond port  
 (2) Backhoe inlet tube  
 (3) Backhoe inlet hose (3/4-16)  
 Tightening torque: 36 to 40 N·m  
 (3.6 to 4.1 kgf·m, 26 to 30 lbf·ft)

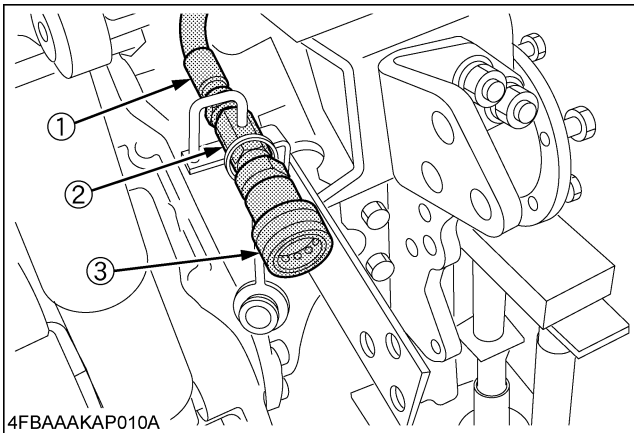

- (1) Backhoe inlet hose (3/4-16)  
 Tightening torque: 36 to 40 N·m  
 (3.6 to 4.1 kgf·m, 26 to 30 lbf·ft)  
 (2) Coupler joint  
 (3) Quick coupler (1/2-14NPT)  
 Tightening torque: 49 to 58 N·m  
 (5.0 to 5.9 kgf·m, 36 to 43 lbf·ft)

#### IMPORTANT :

- Make sure quick coupler with red cap should be connected securely.

3. Connect the backhoe outlet hose to the P port of the valve cover.

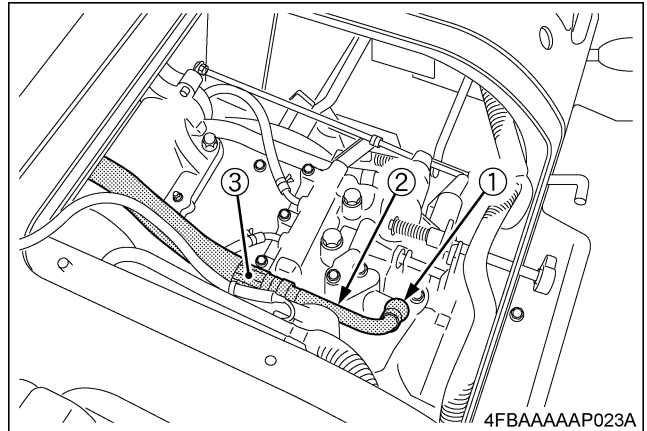

- (1) P port  
 (2) Backhoe outlet tube  
 (3) Backhoe outlet hose (3/4-16)  
 Tightening torque: 36 to 40 N·m  
 (3.6 to 4.1 kgf·m, 26 to 30 lbf·ft)

4. Connect the male coupler to the outlet hose. Connect the coupler joint and female coupler to the inlet hose. Connect the male coupler to the female coupler.

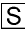
5.  Attach the operating seat to the floor seat cover. Tighten the bolts and nuts by correct tightening torque.

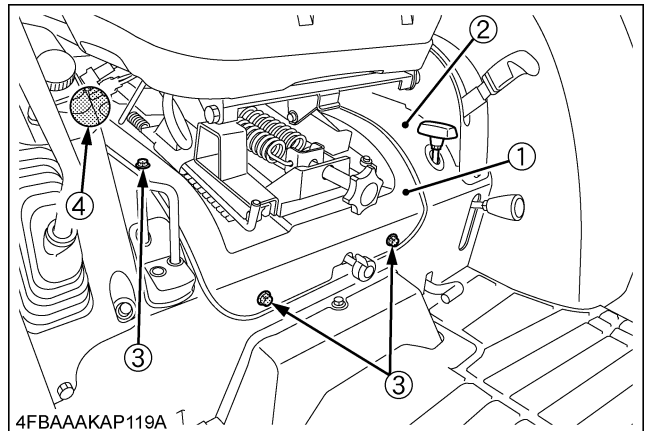

- (1) Operating seat  
 (2) Floor seat cover  
 (3) 4 - M8 bolts  
 (4) 2 - M8 nuts  
 Tightening torque: 23.6 to 27.4 N·m  
 (2.4 to 2.8 kgf·m, 17.4 to 20.2 lbf·ft)

## ■ Sub Frame

1. Detach the front loader sub frame.

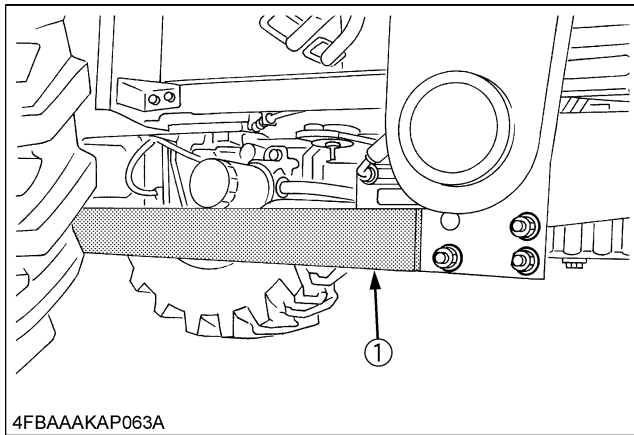

(1) Sub frame

2. Attach the rear bracket in place.

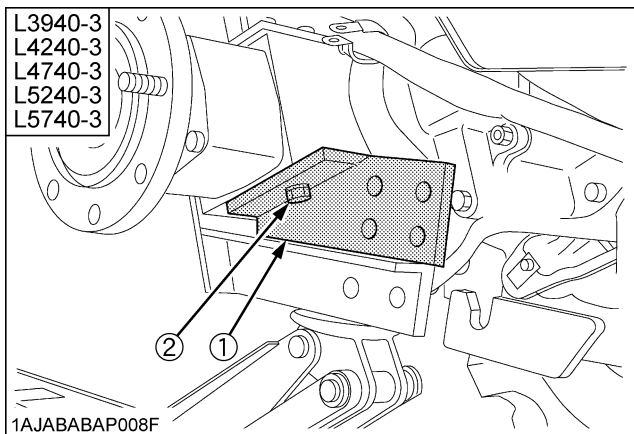

(1) Rear bracket  
(2) 2 - M14 x 30 bolts  
Tightening torque: 124 to 147 N·m  
(12.6 to 15.0 kgf·m , 91.5 to 108.4 lbf·ft)

3. On the L3240-3 and L3540-3, using the accessory bolts of the tractor, attach the rear bracket.

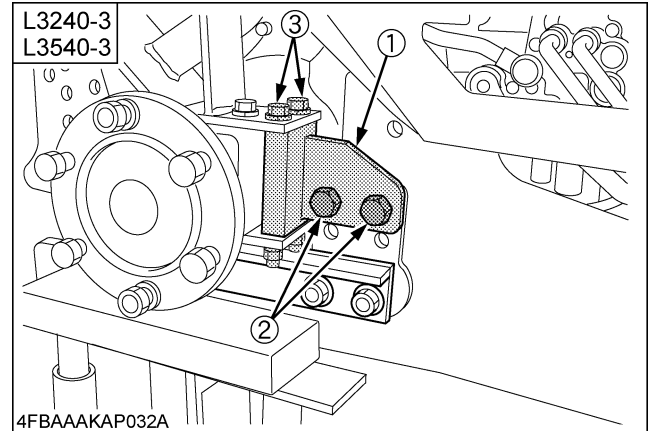

(1) Rear bracket  
(2) 2 - M16 x 50 bolts  
2 - 5/8 hardened plain washers  
2 - M16 spring lock washers  
2 - M16 nuts  
Tightening torque: 196 to 225 N·m  
(20.0 to 23.0 kgf·m , 145 to 166 lbf·ft)  
(3) 2 - M14 x 148 bolts (with spring washer)  
Tightening torque: 167 to 202 N·m  
(17.0 to 20.6 kgf·m , 120 to 149 lbf·ft)

### IMPORTANT :

- If the number of bolts and that of hardened plain washers are the same, additionally put the hardened plain washers at the nut.

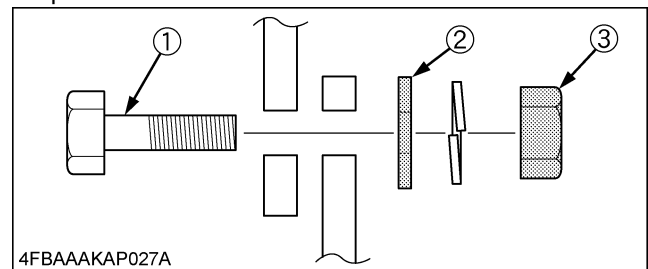

(1) Bolt  
(2) Hardened plain washer  
(3) Nut

4. Lift the back end of the sub frame using a hoist and jack up the front of the sub frame. Temporarily tighten the bolts and nuts in place.

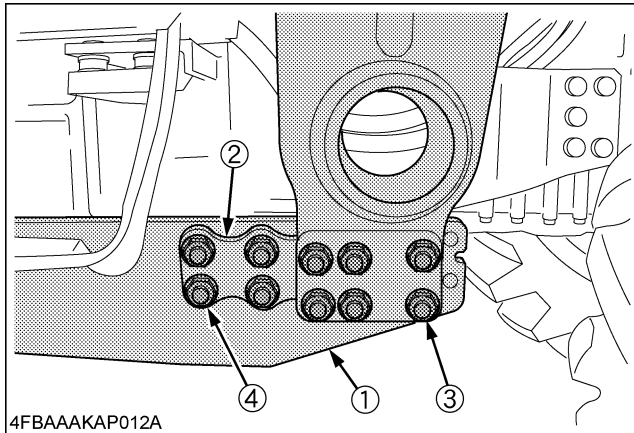

- (1) Sub frame  
 (2) Front bracket  
 (3) 6 - M16 x 130 bolts  
     6 - 5/8 hardened plain washers  
     6 - M16 spring lock washers  
     6 - M16 nuts  
 (4) 4 - M16 x 60 bolts  
     4 - 5/8 hardened plain washers  
     4 - M16 spring lock washers  
     4 - M16 nuts

Tightening torque: 196 to 225 N·m  
 (20.0 to 23.0 kgf·m , 145 to 166 lbf·ft)

**IMPORTANT :**

- Be sure to apply a nylon strap to the back end of the sub frame for hoisting it.

5. Using the bolts and nuts, temporarily fix the following components to the sub frame: CAB frame, rear bracket, frame support and connecting plate.

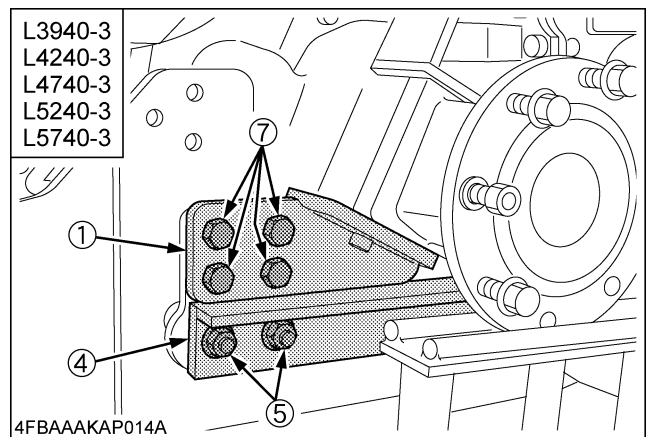
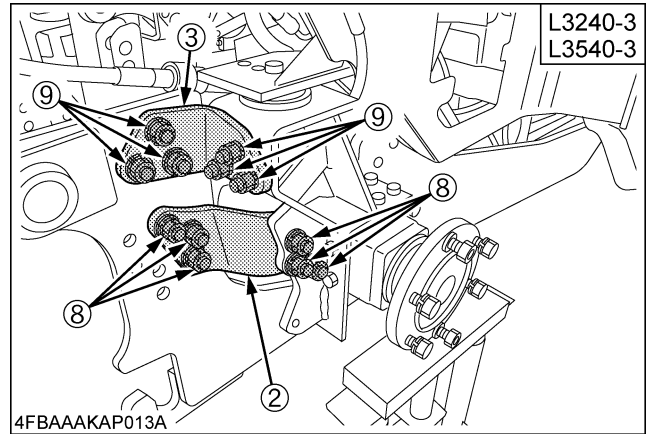
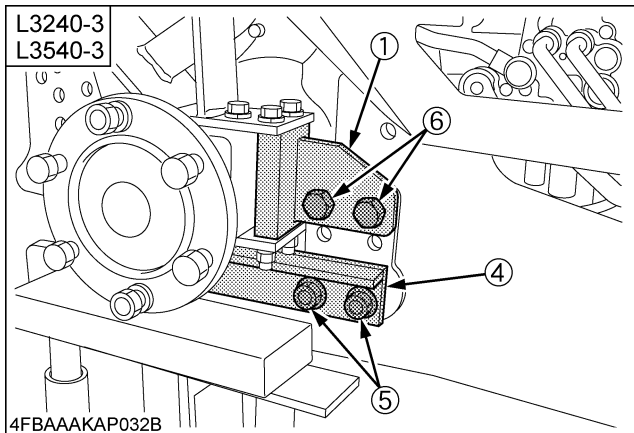

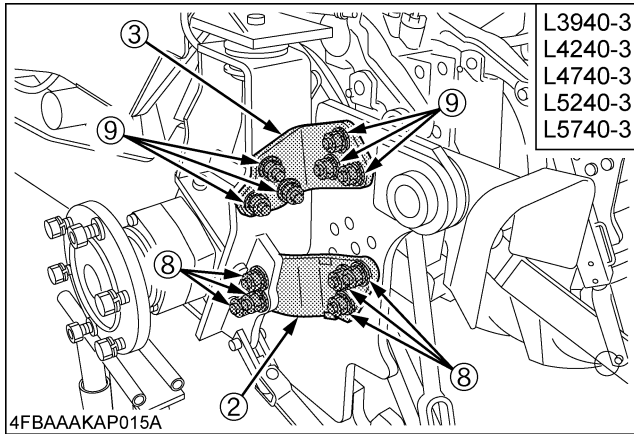

- (1) Rear bracket
- (2) Frame support
- (3) Connecting plate
- (4) ROPS Frame
- (5) 2 - M16 x 140 bolts  
2 - 5/8 hardened plain washers  
2 - M16 spring lock washers  
2 - M16 nuts
- (6) 2 - M16 x 50 bolts [L3240, L3540]  
2 - 5/8 hardened plain washers  
2 - M16 spring lock washers  
2 - M16 nuts
- (7) 4 - M16 x 50 bolts [L3940, L4240, L4740, L5240, L5740]  
4 - 5/8 hardened plain washers  
4 - M16 spring lock washers  
4 - M16 nuts
- (8) 6 - M16 x 50 bolts  
6 - 5/8 hardened plain washers  
6 - M16 spring lock washers  
6 - M16 nuts
- (9) [Left side]  
6 - M16 x 50 bolts  
6 - 5/8 hardened plain washers  
6 - M16 spring lock washers  
6 - M16 nuts
- [Right side]  
3 - M16 x 55 bolts  
3 - M16 x 50 bolts  
6 - 5/8 hardened plain washers  
6 - M16 spring lock washers  
6 - M16 nuts

Tightening torque: 196 to 225 N·m  
(20.0 to 23.0 kgf·m , 145 to 166 lbf·ft)

**NOTE :**

- Install joint stay to the sub frame (RH) as shown in the figure.

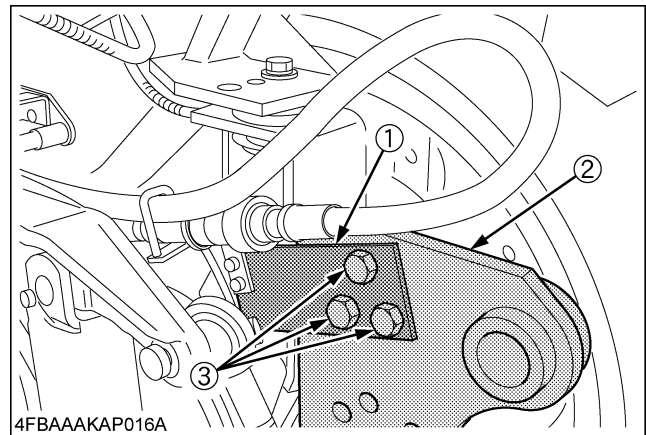

- (1) Joint stay
- (2) Sub frame (RH)
- (3) M16 x 55 bolts (Right side only)

6. After assembling connect the OPC wire harness.

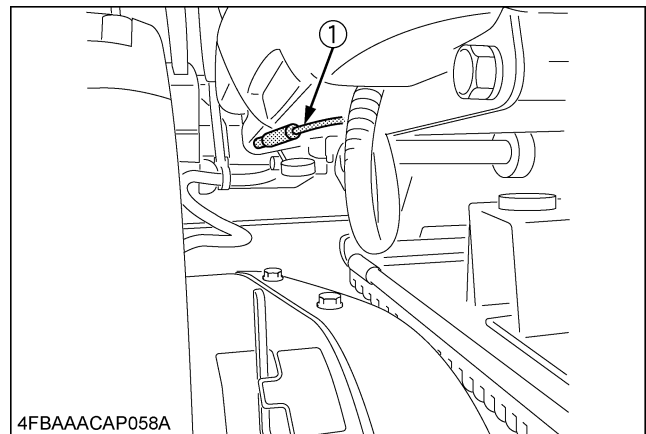

- (1) OPC wire harness

### ◆ Rear wheels

1. [S] Install the right and left rear wheels to the tractor with the bolts and nuts. Tighten the bolts and nuts by the correct tightening torque.

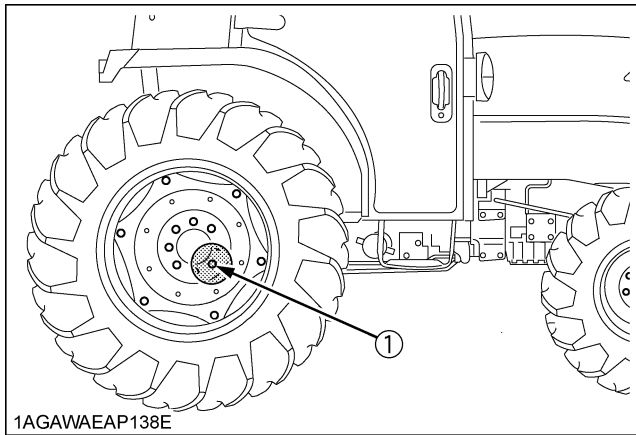

(1) Tightening torque: 215 N·m  
(21.9 kgf·m, 158.6 lbf·ft)

### ■ CAB Spacer

1. Attach the cab spacer.

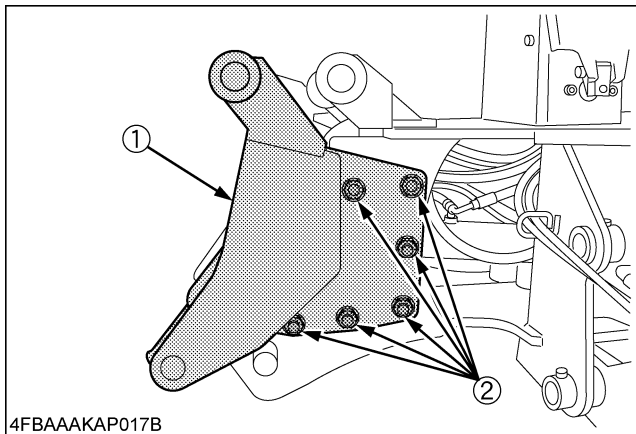

(1) Cab spacer  
(2) 6 - M20 x 55 bolts  
12 - 3/4 hardened plain washers  
6 - M20 spring lock washers  
6 - M20 nuts  
Tightening torque: 368 to 431 N·m  
(37.6 to 44.0 kgf·m, 272 to 318 lbf·ft)

## ASSEMBLY [L3240(-3) - L5740(-3) ROPS Model]

### ■ Preparation

1. Detach the rear tire (RH), fender (RH) and operating seat from the tractor.

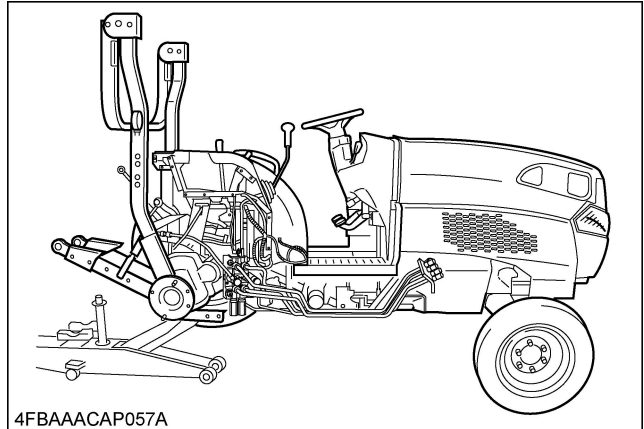

### NOTE :

- Before detaching the operating seat, disconnect the OPC wire harness.

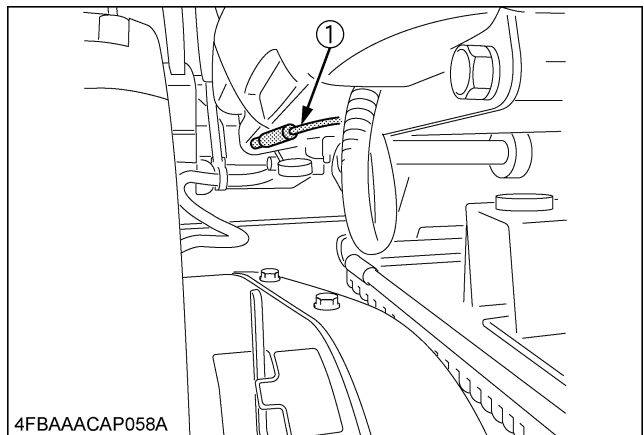

(1) OPC wire harness

## Layout of BH92 Backhoe Hydraulic Lines

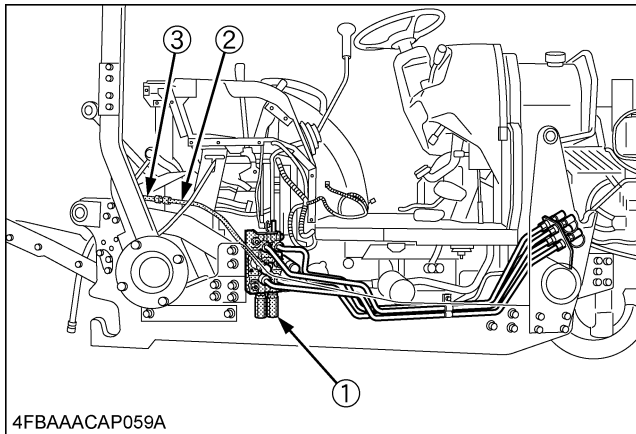

- (1) Front loader valve
- (2) Backhoe inlet tube
- (3) Backhoe inlet hose

## Hydraulic Line

1. Disconnect the front loader power beyond tube.

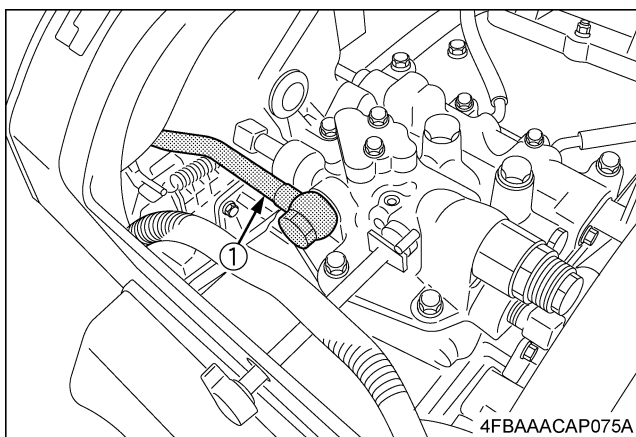
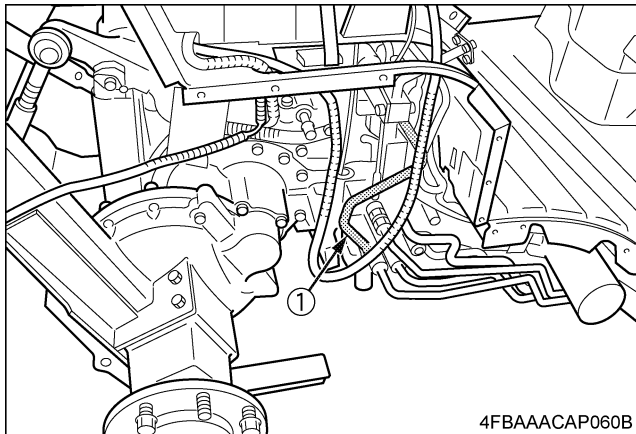

- (1) Front loader power beyond tube

2. Connect the backhoe inlet tube to the power beyond port of the loader valve and the backhoe inlet hose to the backhoe inlet tube and coupler joint.

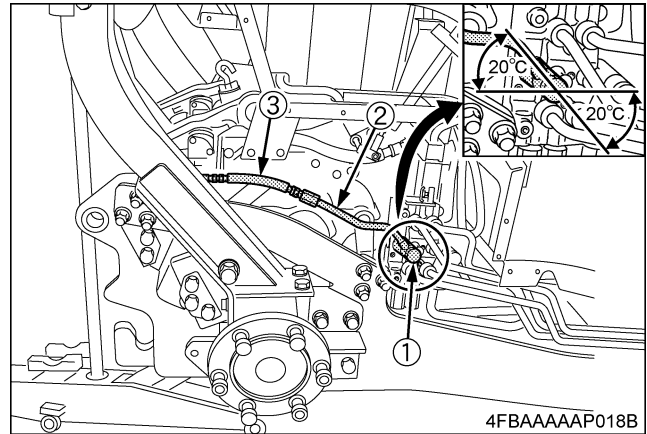

- (1) Power beyond port
  - (2) Backhoe inlet tube
  - (3) Backhoe inlet hose (3/4-16)
- Tightening torque: 36 to 40 N·m  
(3.6 to 4.1 kgf·m, 26 to 30 lbf·ft)

### IMPORTANT :

- Make sure quick coupler with red cap should be connected securely.