

### Replace Rear Wiring Harness—Tractors Without Cab

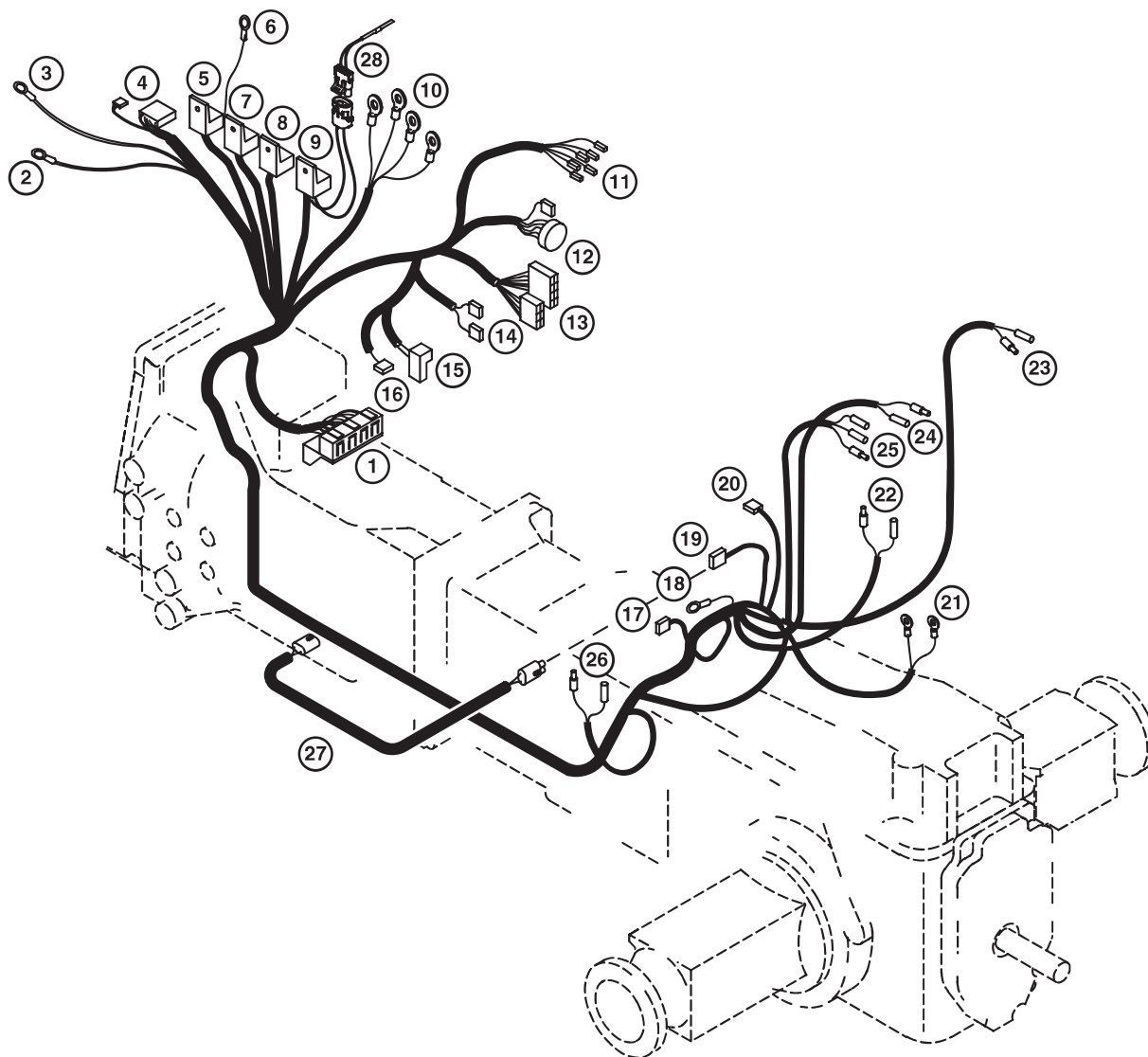

Rear Wiring Harness—Tractors Without Cab

- |                                     |                           |   |   |
|-------------------------------------|---------------------------|---|---|
| 1—Fuse Block                        | 10—Start Relay            | 19—Neutral Start Switch<br>(CollarShift/SyncShuttle™<br>Transmission) | 24—Rear Work Light  |
| 2—Starter Motor Battery<br>Terminal | 11—Light Switch           | 20—Seat Switch  | 25—Left Warn/Turn Light   |
| 3—To Fuse Link Junction Box         | 12—Key Switch             | 21—Fuel Level Sender  | 26—Left Front Fender<br>Floodlight (Model 5510<br>Tractor Only) |
| 4—To Front Wiring Harness           | 13—Instrument Panel       | 22—Right Front Fender<br>Floodlight (Model 5510<br>Tractor Only)      | 27—Neutral Start Switch<br>(PowrReverser™<br>Transmission)      |
| 5—Diode Pack                        | 14—Optional Horn Switch   | 23—Right Warn/Turn Light  | 28—Start Resistor (4-cyl only)                                  |
| 6—Ground                            | 15—Turn Signal Controller |   |   |
| 7—Accessory Relay                   | 16—Horn/Timer             |   |   |
| 8—Bypass Start Relay #2             | 17—Rear PTO Switch        |   |   |
| 9—Bypass Start Relay #1             | 18—Ground                 |   |   |

40  
15  
8

LV2217 -JUN-01-JUL02

Continued on next page

AG,OUO1085,104 -19-27JUN02-1/2