

(3000 - SERIES) - 3 CYL TRACTOR (1/65-12/74) > (07C03) - DUAL RANGE 7 SPEED (GERMANY)

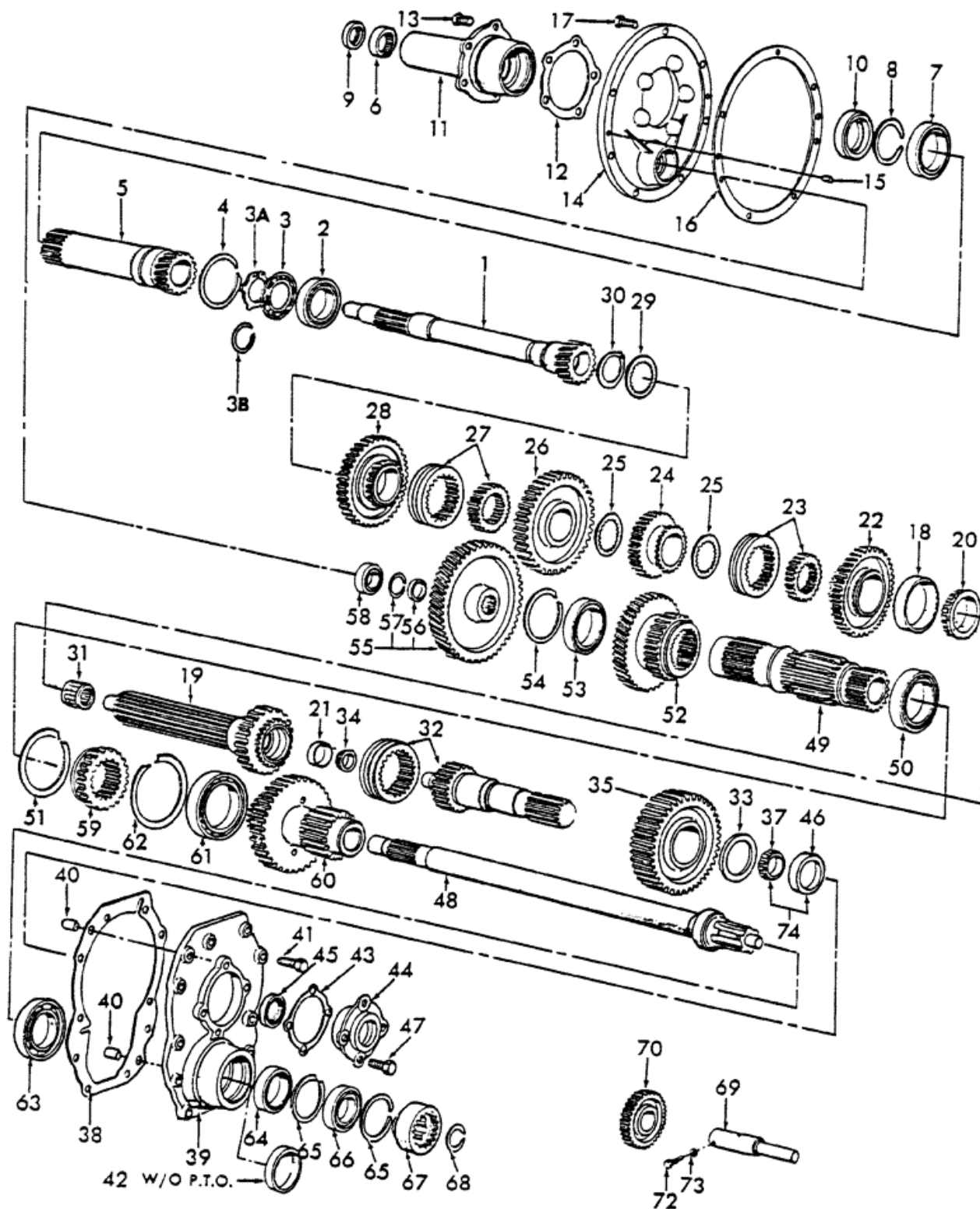



PARTS & MERCHANDISE
STORE

New Holland Agriculture 621 State Street
NA Customer Relations@newholland.com Racine, Wisconsin 53404
866-639-4563 option 1

(3000 - SERIES) - 3 CYL TRACTOR (1/65-12/74) > (07C03) - DUAL RANGE 7 SPEED (GERMANY)

Diag #	Part #	Name	Description	Qty
1	81804588	SHAFT	Main, Front, W/Live	1
		NH-E Only	NH-E Only	1
		No Longer Serviced.	No Longer Serviced.	1
1	C9NN7017C	MAIN SHAFT	Shaft, Main, Front, W/Live	1
1	C5NN7017G	MAIN SHAFT	Shaft, Main, Front, W/Live	1
1	C7NN7017AB	MAIN SHAFT	Shaft, Main, Front, W/Live	1
2	86511837	BALL BEARING	Bearing, Ball, M40, Main Drive Shaft, Start Year: 01-JAN-65	1
3	C5NN7N301C	WASHER	Plate, Drive Shaft Bearing, W/Live PTO, Start Year: 01-JAN-65	1
3A	C5NN7N300B	CIRCLIP	Ring, Drive Shaft Bearing Plate Retaining, W/Live PTO, Start Year: 01-JAN-65	1
3B	508E7064A	SNAP RING	Ring, Drive Shaft Bearing, W/Transmission PTO, Start Year: 01-JAN-65	1
4	C5NN7N064A	SNAP RING	Ring, Snap, Main Drive Shaft Bearing, Outer, Start Year: 01-JAN-65	1
5	C5NN772A	PTO SHAFT	Shaft, PTO Input, W/Live PTO, Replaces P/N D1NN-772-A, Start Year: 01-JAN-65	1
6	E61GE9	NEEDLE BEARING, Needle, 26.98mm ID x 33.35mm OD x 26.99mm W	Bearing, PTO Input Shaft, W/Live PTO, Start Year: 01-JAN-65	1
7	83908455	BALL BEARING	Bearing, PTO Input Shaft, Front, 90 x 50 x 20, Start Year: 01-JAN-65	1
8	957E732	SNAP RING	Ring, Snap, PTO Input Shaft Bearing, Small, W/Live PTO, Start Year: 01-JAN-65	1
9	957E727A	SEAL	Oil Seal Assy., PTO Input Shaft, W/Live PTO, Start Year: 01-JAN-65	1
10	D9NNC729BA	SEAL	Seal, Oil, PTO Input Shaft Bearing Retainer, W/Live PTO, Start Year: 01-JAN-65	1
10	D9NN7R510BA	OIL SEAL	Oil, Clutch Release Bearing Hub Retainer, W/PTO, 2.197 OD x 1.187 ID x .50 thick, Start Year: 01-JAN-65	1
11	C5NN7050C	RETAINER	Main Drive Bearing, W/Live PTO, Start Year: 01-JAN-65	1
11	C5NN7050A	RETAINER	Main Drive Bearing, W/Transmission PTO, Start Year: 01-JAN-65	1
12	81804648	GASKET, 0.31mm Thk	Main Drive Bearing Retainer, Start Year: 01-JAN-65	1
13	46007S36	SCREW	Cap, HH, G5, Self-Locking, 3/8"-16 x 7/8", Start Year: 01-JAN-65	5

Diag #	Part #	Name	Description	Qty
14	C7NN7N054C	PLATE	Assy., Clutch Release Bearing Hub Support, Replaces P/N C5NN-7N054-A Includes: Plate	1
15	73269S	PIN,3/8" x 11/16"	Dowel 3/8" x 11/16", Start Year: 01-JAN-65	2
16	E6NN7N057AA	GASKET	Gasket, Clutch Release Bearing, Support Plate, Start Year: 01-JAN-65	1
17	46009S36	SCREW	Cap, HH, G5, Self-Locking, 3/8"-16 x 1-1/8", Start Year: 01-JAN-65	7
18	82930256	BEARING ASSY	., Mainshaft, Start Year: 01-JAN-65	1
19	81804717	SHAFT	Main, Rear, Start Year: 01-JAN-65	1
19	81822917	SHAFT	Main, Rear, 8 Speed, 25 KPH Transmission, U.K.-Antwerp, Start Year: 01-AUG-70	1
20	82930256	BEARING ASSY	Bearing, Cone	1
21	C5NN7N044A	BEARING ASSY,25 mm ID x 51.988 mm OD x 16.307 mm	Bearing, Cup, Output Shaft, Start Year: 01-JAN-65	1
22	C5NN7102F	GEAR	2nd Speed, Replaces P/N C5NN-7102-A, Start Year: 01-JAN-65	1
23	E6NN7N072AA	SPLINED COUPLING	Connector	1
24	C5NN7K013E	GEAR	Main Shaft, Reverse, 8 Speed, 28T	1
		When Replacing P/N C5NN-7K013-A(87771648) W/C5NN-7K013-E(81813564) you must also replaces P/N C5NN-7141-A (81804801) W/C5NN-7141-B(81813479).	When Replacing P/N C5NN-7K013-A(87771648) W/C5NN-7K013-E(81813564) you must also replaces P/N C5NN-7141-A (81804801) W/C5NN-7141-B(81813479).	1
24	C5NN7K013E	GEAR	Main Shaft Reverse, 7 Speed, 28T	1
25	957E7728A	WASHER,41.12mm ID x 63.5mm OD x 1.4mm Thk	Main Shaft Reverse Gear Thrust, Start Year: 01-JAN-65	2
26	C5NN7100A	GEAR	1st Speed, 8 Speed, 28T	1
		No Longer Serviced.	No Longer Serviced.	1
26	C5NN7100A	GEAR	1st Speed, 7 Speed, 28T	1
		No Longer Serviced.	No Longer Serviced.	1
26	E6NN7N100AA	GEAR SET	Gear, 1st Speed, 8 Speed, 28T	1
26	E6NN7N100AA	GEAR SET	Gear, 1st Speed, 7 Speed, 28T	1
27	E6NN7N072AA	SPLINED COUPLING	Connector	1
28	C5NN7B340A	GEAR	Main, 3rd Speed, Start Year: 01-JAN-65	1
29	957E7071B	THRUST WASHER	Main Drive Shaft Thrust, Start Year: 01-JAN-65	1
30	C5NN7064A	SNAP RING	Ring, Snap, Main Shaft, Start Year: 01-JAN-65	1
31	C5NN7120B	NEEDLE BEARING,0.9973" ID x 1.3735" OD x 0.875"	Bearing, Main Shaft Pilot, Replaces P/N 960E-7120, Start Year: 01-JAN-65	1
32	C5NN7N071C	SHAFT	Coupling	1
		No Longer Serviced.	No Longer Serviced.	1
32	E6NN7N071AA	COUPLING	COUPLING	1

Diag #	Part #	Name	Description	Qty
33	C5NN7A385A	THRUST WASHER	Washer, Output Shaft Thrust, 1.688" (42.88mm) I.D., Years: 01-JAN-65-30-APR-71	1
		NH-E Only	NH-E Only	1
		No Longer Serviced.	No Longer Serviced.	1
33	C9NN7A385A	WASHER	Output Shaft Thrust, 1.755" (44.577mm) I.D., Start Year: 01-MAY-71	1
34	C5NN7N044A	BEARING ASSY,25 mm ID x 51.988 mm OD x 16.307 mm	Bearing, Cone	1
35	E6NN7145AA	GEAR	Assy., Output Shaft, Start Year: 01-JAN-65	1
37	C5NN7N042A	BEARING ASSY	Bearing, Cone	1
38	C5NN7086A	GASKET	Output Shaft Bearing Retainer, Replaces P/N C5NN-7N086-A, Start Year: 01-JAN-65	1
39	C5NN7049E	COVER PLATE	Retainer, Output, Replaces P/N C5NN-7049-C, Start Year: 01-JAN-65	1
40	379304S2	PIN	Dowel, 1/2" x 13/16", Start Year: 01-JAN-65	2
41	304703S36	SCREW	Cap, HH, G5, 3/8"-16 x 1-1/8", Start Year: 01-JAN-65	10
42	115422ES	PLUG	Retainer Expansion, L/PTO, Start Year: 01-JAN-65	1
43	C5NN7N135A	SHIM,.003" Thk	(.0762mm), Output Shaft .003" Thk, Start Year: 01-JAN-65	1
43	81804789	SHIM,91.95mm ID x 128.67mm OD x 0.13mm Thk	(.127 mm), Output Shaft .005" Thk, Start Year: 01-JAN-65	1
43	81804790	SHIM,91.95mm ID x 128.67mm OD x 0.08mm Thk	(.305 mm), Output Shaft .012" Thk, Start Year: 01-JAN-65	1
44	C5NN7085B	RETAINER	Assy., Output Shaft Bearing, Includes: Retainer, Ref. 45, 46	1
		No Longer Serviced.	No Longer Serviced.	1
44	C9NN7049C	HOUSING	Retainer , Output Shaft Bearing, Start Year: 01-MAY-71	1
45	C5NN77086A	SEAL	Assy., Output Shaft, Start Year: 01-JAN-65	1
46	C5NN7N041A	CUP	Output Shaft Bearing, Years: 01-JAN-65-30-APR-71	1
47	46007S36	SCREW	Cap, HH, G5, Self-Locking, 3/8"-16 x 7/8", Start Year: 01-JAN-65	4
48	C5NN702A	COUNTERSHAFT	PTO, W/Transmission PTO, Start Year: 01-JAN-65	1
48	C7NN702B	COUNTERSHAFT	PTO, W/Live PTO, Replaces P/N C5NN-702-B, Start Year: 01-JAN-65	1
49	C5NN7111B	COUNTERSHAFT	W/Transmission PTO, 8 Speed, 16T, Years: 01-JAN-65-30-SEP-65	1
49	C5NN7111B	COUNTERSHAFT	7 Speed, 16T, Years: 01-JAN-65-31-MAR-68	1

Diag #	Part #	Name	Description	Qty
49	C5NN7111M	COUNTERSHAFT	W/Transmission PTO, 8 Speed, 18T, Start Year: 01-SEP-65	1
49	C5NN7111M	COUNTERSHAFT	7 Speed, 18T, Start Year: 01-APR-68	1
49	C5NN7111C	COUNTERSHAFT	W/Live PTO, 8 Speed, 16T, Years: 01-JAN-65-30-SEP-65	1
49	C5NN7111C	COUNTERSHAFT	W/Live PTO, 7 Speed, 16T, Years: 01-JAN-65-31-MAR-68	1
49	C5NN7111N	COUNTERSHAFT	W/Live PTO, 8 Speed, 18T, Start Year: 01-SEP-65	1
49	C5NN7111N	COUNTERSHAFT	7 Speed, 18T, Start Year: 01-APR-68	1
50	C7NN7118B	BEARING ASSY,55 mm ID x 100 mm OD x 21 mm	., Coutnershaft, Replaces P/N E1ADDN-7025-A, Start Year: 01-JAN-65	1
51	E1ADKN77014	SNAP RING	Ring, Lock, Countershaft Rear Bearing, Start Year: 01-JAN-65	1
52	C5NN7113D	GEAR	Countershaft Main, 8 Speed Transmission, 30T	1
52	81804755	GEAR	Countershaft Main, 7 Speed Transmission, 30T	1
53	83908455	BALL BEARING	Bearing, Countershaft, Highland Park, 90 x 50 x 20, Start Year: 01-JAN-65	1
53	83908455	BALL BEARING	Bearing, Countershaft, 90 x 50 x 20, Basildon-Antwerp, Start Year: 01-JAN-65	1
54	C5NN7N064A	SNAP RING	Ring, Lock, Countershaft Bearing, Start Year: 01-JAN-65	1
55	C7NN791B	GEAR	Assy., PTO Countershaft, W/Live PTO, Replaces P/N C5NN-791-A, 4110, Years: 01-JAN-65-31-MAY-72	1
55	C7NN791B	GEAR	Assy., PTO Countershaft, W/Live PTO, Replaces P/N C5NN-791-A, 2000-3000, Start Year: 01-JAN-65	1
55	D1NN791A	GEAR	Assy., PTO Countershaft, W/Live PTO, 4110 Includes: Gear, Ref. 56	1
56	C7NNB777B	THRUST WASHER,26.67mm ID x 30.96mm OD x 4.83mm Thk	Washer, W/Live PTO, Replaces P/N 957E-714, Start Year: 01-JAN-65	1
57	C7NNB781A	SNAP RING	Ring, Snap, W/Live PTO, Replaces E97-GE-9, Start Year: 01-JAN-65	1
58	E9NND745AA	BALL BEARING	Bearing Assy., PTO Front, W/Live PTO, Start Year: 01-JAN-65	1
59	E0NN7106BA	COUPLING,16T	Countershaft Sliding Gear, 21T, Must be used P/N C5NN-7102-F, Gear, Start Year: 01-JAN-65	1
60	C5NN7113B	GEAR	Countershaft Secondary, Start Year: 01-JAN-65	1
60	81822919	GEAR	Countershaft Secondary, 8 Speed, 25 KPH Transmission, Basildon-Antwerp, Start Year: 01-AUG-70	1
		NH-E Only	NH-E Only	1

Diag #	Part #	Name	Description	Qty
61	20141040	BALL BEARING,60mm ID x 110mm OD x 22mm W	Bearing Assy, Countershaft Front, Start Year: 01-JAN-65	1
62	C5NN7N160A	RING,4.63" OD	Lock, Countershaft Front Bearing 4.63" OD, Start Year: 01-JAN-65	1
63	C5NN7127A	BALL BEARING	Bearing Assy., Countershaft Rear, Start Year: 01-JAN-65	1
64	E62GE9	SEAL	Assy., PTO Countershaft, Start Year: 01-JAN-65	1
65	957E790	SNAP RING,3.03" OD	RING, SNAP, , PTO Countershaft Bearing 3.03" OD, Start Year: 01-JAN-65	2
66	E75GE9	BALL BEARING	Bearing, PTO Drive Countershaft Rear, Start Year: 01-JAN-65	1
67	C5NNN705A	LINER	Sleeve, PTO Intermediate Shaft, Start Year: 01-JAN-65	1
68	E1ADKN7256	SNAP RING	Ring, Lock, Sleeve	1
69	C5NN7140B	SHAFT,28.52mm OD x 158.75mm L	Reverse Idler, Start Year: 01-JAN-65	1
70	C5NN7141A	GEAR	Assy., Reverse Idler, 8 Speed, 33T, Years: 01-JAN-65-30-SEP-65	1
70	C5NN7141A	GEAR	Assy., Reverse Idler, 7 Speed, 33T, Years: 01-JAN-65-31-MAR-68	1
70	81813479	GEAR	Assy., Reverse Idler, 8 Speed, 31T, Start Year: 01-SEP-65	1
70	81813479	GEAR	Assy., Reverse Idler, 7 Speed, 31T, Start Year: 01-APR-68	1
72	C5NN7N011B	BOLT	3/8"-16, Start Year: 01-JAN-65	1
73	C5NN7N144A	SEAL	Washer, Lock, 3/8", Start Year: 01-JAN-65	1
74	86512015	BEARING ASSY,41.27mm ID x 73.46mm OD x 19.63mm W	Bearing Set, Cup	1