

(3000 - SERIES) - 3 CYL TRACTOR (1/65-12/74) > (07C01) - DUAL RANGE 7 SPEED (GERMANY)

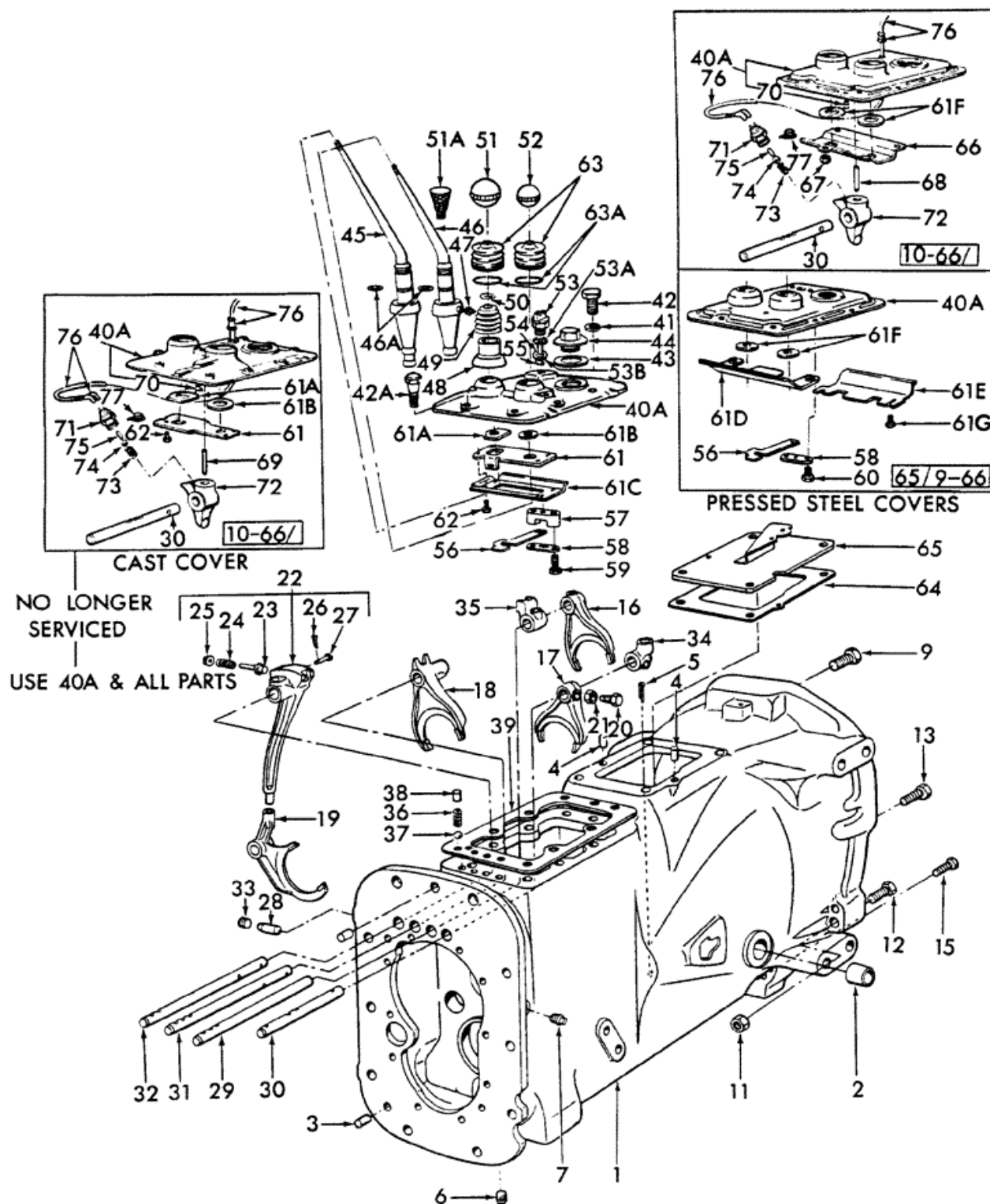



PARTS & MERCHANDISE  
STORE

**New Holland Agriculture 621 State Street**  
**NA Customer Relations@newholland.com Racine, Wisconsin 53404**  
**866-639-4563 option 1**

(3000 - SERIES) - 3 CYL TRACTOR (1/65-12/74) > (07C01) - DUAL RANGE 7 SPEED (GERMANY)

Diag #	Part #	Name	Description	Qty
	NLS	NO LONGER SERVICED	Transmission Assy., W/Live PTO, L/Gear Shift Cover, 2000-3000 Except 3400, Start Year: 01-JAN-65	1
		Order Wholegoods.	Order Wholegoods.	1
	NLS	NO LONGER SERVICED	Transmission Assy., W/Transmission PTO, L/Gear Shift Cover, 2100-3100-3190, Start Year: 01-JAN-65	1
		Order Wholegoods.	Order Wholegoods.	1
	NLS	NO LONGER SERVICED	Transmission Assy., Transmission PTO, L/Gear Shift Cover, Replaces P/N D1NN7N002A, 4400-4500, Start Year: 01-JAN-65	1
		Order Wholegoods.	Order Wholegoods.	1
	NLS	NO LONGER SERVICED	Transmission Assy., Transmission PTO, L/Gear Shift Cover, Replaces P/N D1NN7N002A, U.K.- Antwerp, 4100, Start Year: 01-MAY-73	1
	NLS	NO LONGER SERVICED	Transmission Assy., W/Transmission PTO, L/Gear Shift Cover, 3190-3400, Start Year: 01-JAN-65	1
		Order Wholegoods.	Order Wholegoods.	1
	NLS	NO LONGER SERVICED	Transmission Assy., W/Live PTO, L/Gear Shift Cover, 3400, Start Year: 01-JAN-65	1
		Order Wholegoods.	Order Wholegoods.	1
	NLS	NO LONGER SERVICED	Transmission Assy., L/PTO, L/Gear Shift Cover, U.S. Only, 3190-3400, Start Year: 01-JAN-65	1
		Order Wholegoods.	Order Wholegoods.	1
	NLS	NO LONGER SERVICED	Transmission Assy., L/PTO, L/Gear Shift Cover, U.S., 4410, Start Year: 01-OCT-69	1
		Order Wholegoods.	Order Wholegoods.	1
	NLS	NO LONGER SERVICED	Transmission Assy., L/PTO, L/Gear Shift Cover, 4190-4400-4500, Start Year: 01-JAN-65	1
		Order Wholegoods.	Order Wholegoods.	1
	NSS	NOT SERVICED SEPARATELY	Tranmission Assy., L/PTO, L/Gear Shift Cover, U.K.-Antwerp, 4100, Start Year: 01-MAY-73	1
	NLS	NO LONGER SERVICED	Transmission Assy., Independent PTO, L/Gear Shift Cover, U.S., 4100, Years: 01-JAN-65-31-MAY-71	1
		Order Wholegoods.	Order Wholegoods.	1

Diag #	Part #	Name	Description	Qty
	NLS	NO LONGER SERVICED	Transmission Assy., Independent PTO, L/Gear Shift Cover, 4190-4400-4500, Start Year: 01-JAN-65	1
		Order Wholegoods.	Order Wholegoods.	1
	NSS	NOT SERVICED SEPARATELY	Transmission Assy., Independent PTO, L/Gear Shift Cover, U.K.- Antwerp, 4100, Start Year: 01-MAY-73	1
	NLS	NO LONGER SERVICED	Transmission Assy., Independent PTO, L/Gear Shift Cover, U.K.- Antwerp, 4100, Start Year: 01-JAN-65	1
		Order Wholegoods.	Order Wholegoods.	1
	NLS	NO LONGER SERVICED	Transmission Assy., Transmission PTO, L/Gear Shift Cover, 4100-4190, Start Year: 01-JAN-65	1
		Order Wholegoods.	Order Wholegoods.	1
	NLS	NO LONGER SERVICED	Transmission Assy., W/Independent PTO, L/Shift Cover, 4140, Start Year: 01-APR-70	1
		Order Wholegoods.	Order Wholegoods.	1
	NLS	NO LONGER SERVICED	Transmission Assy., W/Independent PTO, L/Shift Cover, 4410, Years: 01-OCT-69-31-JAN-75	1
		Order Wholegoods.	Order Wholegoods.	1
	NLS	NO LONGER SERVICED	Transmission Assy., W/Transmission PTO, L/Shift Cover, 4410, Start Year: 01-OCT-69	1
		Order Wholegoods.	Order Wholegoods.	1
	NLS	NO LONGER SERVICED	Transmission Assy., W/Transmission PTO, Special Ratio, L/Shift Cover, 2100-3100-3190, Start Year: 01-APR-68	1
		Order Wholegoods.	Order Wholegoods.	1
	NLS	NO LONGER SERVICED	Transmission Assy., W/Independent PTO, Special Ratio, L/Shift Cover, 3055, Start Year: 01-MAR-70	1
		Order Wholegoods.	Order Wholegoods.	1
	NLS	NO LONGER SERVICED	Transmission Assy., W/Live PTO, Special Ratio, L/Shift Cover, 2300-3190-3300, Start Year: 01-APR-68	1
		Order Wholegoods.	Order Wholegoods.	1
	NLS	NO LONGER SERVICED	Transmission Assy., W/Transmission PTO, L/Shift Cover, Replaces P/N C7NN7N002AU, 4100-4190, Start Year: 01-APR-68	1
		Order Wholegoods.	Order Wholegoods.	1
	NLS	NO LONGER SERVICED	Transmission Assy., W/Independent PTO, L/Shift Cover, 4100, Start Year: 01-APR-68	1
		Order Wholegoods.	Order Wholegoods.	1
	NLS	NO LONGER SERVICED	Transmission Assy., W/Independent PTO, Special Ratio, L/Shift Cover, 4400-4500, Start Year: 01-APR-68	1

Diag #	Part #	Name	Description	Qty
		Order Wholegoods.	Order Wholegoods.	1
	NLS	NO LONGER SERVICED	Transmission Assy., W/Independent PTO, Special Ratio, L/Shift Cover, Except Germany, 4190, Start Year: 01-APR-68	1
		Order Wholegoods.	Order Wholegoods.	1
	NLS	NO LONGER SERVICED	Transmission Assy., L/PTO, Special Ratio, L/Shift Cover, 4190-4400-4500, Start Year: 01-APR-68	1
		Order Wholegoods.	Order Wholegoods.	1
	NLS	NO LONGER SERVICED	Transmission Assy., W/Live PTO, L/Gear Shift Cover, 7 Speed Transmission, Special Ratio, Special Order Germany Only, 2100-2300-2310-3100-3300-3310-3190, Years: 01-JAN-65-31-OCT-72	1
		Order Wholegoods.	Order Wholegoods.	1
	NLS	NO LONGER SERVICED	Transmission Assy., W/Independent PTO, L/Gear Shift Cover, 7 Speed Transmission, Special Ratio, Special Order Germany Only, 3055, Years: 01-JAN-71-31-OCT-72	1
		Order Wholegoods.	Order Wholegoods.	1
	NLS	NO LONGER SERVICED	Transmission Assy., W/Transmission PTO, 25 KPH Transmission, U.K.- Antwerp, 2100-2310-3100-3310, Start Year: 01-AUG-70	1
		Order Wholegoods.	Order Wholegoods.	1
	NLS	NO LONGER SERVICED	Transmission Assy., W/Live PTO, 25 KPH Transmission, U.K.- Antwerp, Except 3400-3500-4000, Start Year: 01-AUG-70	1
		Order Wholegoods.	Order Wholegoods.	1
1	D9NN7005CB	LOAD DECK	Case Assy., Transmission, Replaces P/N C7NN7005AV, AY	1
		When replacing Case Assy.'s made prior to 10-69/ both Bushings C5NN7A615A(81805431) must be replaced W/(2) D0NN7A615A(81823296).	When replacing Case Assy.'s made prior to 10-69/ both Bushings C5NN7A615A(81805431) must be replaced W/(2) D0NN7A615A(81823296).	1
		No Longer Serviced NH-E.	No Longer Serviced NH-E.	1
1	D9NN7005DB	CASE	Assy., Transmission, Replaces C7NN7005AZ, BA	1
1	C7NN7005BC	CASE	Assy., Transmission 8 Speed	1
		No Longer Serviced.	No Longer Serviced.	1
2	C5NN7A615B	BUSHING	Clutch Release Cross Shaft, Years: 01-JAN-65-30-SEP-69	2
2	C5NN7A615A	BUSHING	Clutch Release Cross Shaft, Start Year: 01-OCT-69	2
2	D0NN7A615A	BRONZE BUSHING	Bushing, Clutch Release Shaft, Service Only	2
3	379304S2	PIN	Dowel, 1/2" x 13/16", Start Year: 01-JAN-65	2

Diag #	Part #	Name	Description	Qty
4	73269S	PIN,3/8" x 11/16"	Dowel, 4000 3/8" x 11/16", Start Year: 01-JAN-65	2
	138188	BEARING COVER	Button, 13/32", Start Year: 01-JAN-65	1
	36916S2	SCREW,Rnd Hd, 3/8" - 16 x 1"	Rd Hd, 3/8"-16 x 1", Start Year: 01-JAN-66	1
		NHNA Only.	NHNA Only.	1
		No Longer Serviced.	No Longer Serviced.	1
5	72036S36	COTTER PIN,5/32" x 1"	Pin, Split Cotter, 5/32" x 1", Start Year: 01-JAN-65	1
6	263136	MAGNETIC PLUG,Sq. Soc, 3/4"-14 NPTF	PLUG, MAGNETIC, Sq. Soc, 3/4"-14 NPTF, Years: 01-JAN-65-31-OCT-67	1
6	87811S36	DRAIN PLUG,3/4"-14	PLUG, DRAIN, , Sq Hd, NPTF 3/4"-14, Start Year: 01-NOV-67	1
7	9617020	PLUG,1/4" - 18 x 0.48"	Pipe, HS, 1/4"-18, NPTF, Years: 01-JAN-65-31-OCT-67	1
7	87709S2	PLUG	Socket Hd., 1/4"-18 NPTF, Start Year: 01-NOV-67	1
9	P0401846	SCREW	Cap, HH, G5, 3/4"-16 x 2-3/4", Start Year: 01-JAN-65	2
9	301027S36	SCREW	Cap, HH, G5, 3/4"-16 x 6", 3400,4000,4500,5000, Start Year: 01-JAN-65	2
9	301027S36	SCREW	Cap, HH, G5, 3/4"-16 x 6", 4200, Start Year: 01-JAN-66	2
11	9602227	LOCK NUT,5/8"-18, GC	NUT, LOCK, 5/8"-18, GC, Start Year: 01-JAN-65	2
		This part is thinner than original part - number 33884S43	This part is thinner than original part - number 33884S43	1
12	304956S36	BOLT	Screw, Cap, HH, G5, 5/8"-18 x 3-3/4", Start Year: 01-JAN-65	2
13	304883S36	SCREW	Cap, HH, G5, 5/8"-11 x 2-3/8", Start Year: 01-JAN-65	2
15	280244	BOLT,Hex, 7/16" - 14 x 3/4", Gr 5, Full Thd	Screw, Cap, HH, G5, 7/16"-14 x 3/4", Start Year: 01-JAN-65	2
16	C5NN7231A	FORK	Gear Shift, 7	1
17	81804929	FORK	Gear Shift, High-Low, Start Year: 01-JAN-65	1
18	C5NN7231S	FORK	Gear Shift, 2	1
19	C5NN7231E	FORK	Gear Shift, 4th Low	1
20	957E7245	SET SCREW,Hex, 3/8" - 24 x 1"	SCREW, SET, , Gear Shift Fork Lock Hex, 3/8"-24 x 1", Start Year: 01-JAN-65	6
21	87308	JAM NUT,Jam, 3/8"-24, G2	Jam, G2, 3/8"-24, Start Year: 01-JAN-65	6
22	C7NN7302A	ARM	Assy., Gear Shift Selector, Replaces C5NN7302A, Includes: Arm	1
23	D7NN7R427A	PLUNGER	Selector Stop, Replaces C5NN7N547A, Start Year: 01-JAN-65	1

Diag #	Part #	Name	Description	Qty
24	C7NN7N458A	SPRING	Selector Stop Plunger, Replaces P/N C5NN7N458A, Start Year: 01-JAN-65	1
25	81805140	RETAINER	Selector Stop Plunger Spring, Start Year: 01-JAN-65	1
26	280236	COTTER PIN,1/16" x 1/2"	Pin, Split (Cotter), 1/16" x 1/2"	1
27	76237S	ROLL PIN	Pin, Clevis, 3/16" x 1-7/32", Start Year: 01-JAN-65	1
27	76237S	ROLL PIN	Pin, Clevis, 3/16" x 1-7/32", Use W/C7NN7302A, Start Year: 01-JAN-65	1
28	C5NN7229B	DOWEL,.373" x .723" L	Interlock, Gear Shift Rail .373" x .723" L, Start Year: 01-JAN-65	2
28	C5NN7N230A		Interlock, Gear Shift, High-Low, 3-1/4" Lg., Germany, Years: 01-JAN-65-31-OCT-72	1
		NH-E Only	NH-E Only	1
		No Longer Serviced.	No Longer Serviced.	1
29	C5NN7240A	SPINDLE	Rail, Gear Shift, 7	1
30	81814738	SHAFT	Rail, Gear Shift, High	1
30	C5NN7240S		Rail, Gear Shift, High-Low, 3 Detents, Germany, Years: 01-JAN-65-30-SEP-66	1
		NH-E Only	NH-E Only	1
		No Longer Serviced.	No Longer Serviced.	1
30	81814739	Rail, Gear Shift, High & Low, W/.190 Hole, Germany, Start Year: 01-OCT-66	GUIDE	1
		NH-E Only	NH-E Only	1
		No Longer Serviced.	No Longer Serviced.	1
30	C5NN7240Z		Rail, Gear Shift, High	1
		NH-E Only	NH-E Only	1
		No Longer Serviced.	No Longer Serviced.	1
31	C5NN7240B	SPINDLE	Rail, Gear Shift, 2	1
32	81804959	SHAFT	Rail, Gear Shift, 4	1
32	C5NN7240V		Rail, Gear Shift, 15.45" Long, Germany, Years: 01-JAN-65-31-OCT-72	1
		NH-E Only	NH-E Only	1
		No Longer Serviced.	No Longer Serviced.	1
33	9617020	PLUG,1/4" - 18 x 0.48"	Pipe, HS, 1/4"-18, NPTF, Start Year: 01-JAN-65	2
34	D9NN7279AA	DOOR	Gate, Gear Shift Shaft, Start Year: 01-JAN-65	1
35	E5NN7N103AA	COUPLING	Connector, Gear Shift Lever, Replaces C5NN7N103A, Start Year: 01-JAN-65	1
36	797234	SPRING	Gear Shift Rail, Start Year: 01-JAN-65	4
37	145222	BALL BEARING,9.53mm OD, Gr 1000	Steel, Rail Detent 3/8", Start Year: 01-JAN-65	4
38	379678S	PIN,3/8" x 1.26"	Straight 3/8" x 1.26", Years: 01-JAN-65-30-SEP-66	4

Diag #	Part #	Name	Description	Qty
38	379678S	PIN,3/8" x 1.26"	Straight 3/8" x 1.26", Start Year: 01-OCT-66	3
38	C7NN7N442A	PIN	3/8" x 31/32", High	1
39	82004680	GASKET,1mm Thk	Gear Shift Cover, 10 Hole, W/Pressed Steel Cover, Start Year: 01-JAN-65	1
40A	C5NN7211F	COVER	Case Cover Assy., Pressed Steel, Start Year: 01-JAN-65	1
		Parts with callout numbers 66 thru 77 should be used when replacing C5NN7211F(81814737) or C5NN7222C(81804896) Cover.	Parts with callout numbers 66 thru 77 should be used when replacing C5NN7211F(81814737) or C5NN7222C(81804896) Cover.	1
41	388601S36M	WASHER	Lock, 3/8", Start Year: 01-JAN-65	8
42	88434	BOLT,Hex, 3/8" - 16 x 3/4", Gr 5	Screw, Cap, HH, G5, 3/8"-16 x 3/4", W/Pressed Steel Cover, Start Year: 01-JAN-65	8
42	88206	BOLT,Hex, 3/8" - 16 x 1", Gr 5	W/Cast Cover Hex, 3/8"-16 x 1", G5, Full Thd, Years: 01-JAN-65-31-JAN-69	8
42A	C5NN7N176C	BOLT	Dowel, Case Cover, W/Pressed Steel Cover, Years: 01-JAN-65-30-SEP-66	1
		No Longer Serviced.	No Longer Serviced.	1
42A	C5NN7N176A	BOLT	Dowel, Case Cover, W/Cast Cover, Years: 01-JAN-65-30-SEP-66	1
		No Longer Serviced.	No Longer Serviced.	1
43	D9NN7037AA	GASKET	Filler Plug 3400,4000,5000, Start Year: 01-JAN-65	1
44	957E7010	PLUG	Case Filler, Start Year: 01-JAN-65	1
45	C5NN7210D	LEVER	Main Gear Change, W/Pressed Steel Cover, Years: 01-JAN-65-31-MAR-68	1
45	C7NN7210K	LEVER	Main Gear Change, W/Cast Cover, 2300-3300, Years: 01-APR-68-31-JAN-69	1
		No Longer Serviced.	No Longer Serviced.	1
45	C7NN7210AD	LEVER	Main Gear Change, W/Pressed Steel Cover, 2300-3300, Start Year: 01-FEB-69	1
45	C7NN7210J	LEVER	Main Gear Change, W/Cast Cover, 4200-4410, Years: 01-JAN-66-31-JAN-69	1
45	C7NN7210AF	LEVER	Main Gear Change, W/Pressed Steel Cover, 4200-4410, Start Year: 01-FEB-69	1
45	C5NN7210E	LEVER	Main Gear Change, W/Cast Cover, Years: 01-JAN-65-31-MAR-68	1
45	C7NN7210C	LEVER	Main Gear Change, W/Cast Cover, Except 2300-3300-4200, Years: 01-APR-68-31-JAN-69	1
45	C7NN7210AG	LEVER	Main Gear Change, W/Pressed Steel Cover, Except 2300,3300,4200, Start Year: 01-FEB-69	1
46	C5NN7210V	LEVER	High - Low Gear Shift, W/Cast Cover, 2000-3000, Years: 01-JAN-65-31-MAR-68	1

Diag #	Part #	Name	Description	Qty
		No Longer Serviced.	No Longer Serviced.	1
46	C7NN7210D	LEVER	High - Low Gear Shift, W/Cast Cover, Years: 01-APR-68-31-JAN-69	1
		No Longer Serviced.	No Longer Serviced.	1
46	C5NN7210T	LEVER	High - Low Gear Shift, 4200, Years: 01-JAN-66-31-MAR-68	1
		NHNA Only.	NHNA Only.	1
		No Longer Serviced.	No Longer Serviced.	1
46	C7NN7210AC	LEVER	High - Low Gear Shift, W/Pressed Steel Cover, Start Year: 01-FEB-69	1
46A	128359	O-RING,0.07" Thk x 0.614" ID, -16, CI 5, 75 Duro	-016, 70 Duro, .614" ID x .070" Thk, Start Year: 01-APR-68	2
47	D7NN7C402A	PIN	Gear Shift Lever Retaining, W/Pressed Steel Cover, Start Year: 01-JAN-65	2
47	D7NN7C402A	PIN	Gear Shift High - Low Lever Locating, W/Cast Cover, Replaces P/N N7221, Years: 01-JAN-65-31-JAN-69	1
47	C7NN7N441B	PIN	Gear Shift Main Lever Locating, W/Cast Cover, Years: 01-JAN-65-31-JAN-69	1
48	82007346	RETAINER	Gear Shift Lever Ball, Replaces P/N D4NN7N309A, Start Year: 01-JAN-65	2
49	C7NN7227A	COMPRESSION SPRING,Compression, 30.739mm OD x 45.719mm L	Gear Shift Lever, Replaces P/N N7227, Start Year: 01-JAN-65	2
50	N7228	SEAT/SLOT	Ring, Snap, Gear Shift Lever Spring, Start Year: 01-JAN-65	2
51	81804882	BALL	Main Gear Change Lever, 1-5/8" (4.128cm) (Replaces C5NN7213A), Start Year: 01-JAN-65	1
51A	C5NN7C305B	GEAR	Extension Assy., Gear Shift, 4200, Start Year: 01-JAN-66	2
		NHNA Only.	NHNA Only.	1
		No Longer Serviced.	No Longer Serviced.	1
52	E440GB9	BALL	High - Low Gear Shift, 1-1/4" (3.175cm) Dia., Except 4200, Start Year: 01-JAN-65	1
53	C5NN11N500A	SWITCH	Starter Safety, Years: 01-JAN-65-30-SEP-66	1
53A	9672467	O-RING,0.103" Thk x 0.549" ID, -113, CI 5, 75 Duro	.562" ID x .103" Thk, Years: 01-JAN-65-30-SEP-66	1
53B	C5NN11N005A	SHIM	Pack, Switch to Shift Cover, U.S., Years: 01-JAN-65-30-SEP-66	1
		No Longer Serviced.	No Longer Serviced.	1
54	C5NN11467H	PLUNGER	Starter Safety Switch, W/Pressed Steel Cover, Red, .990/.995 (25.146/25.273mm), Years: 01-JAN-65-30-SEP-66	1
		No Longer Serviced.	No Longer Serviced.	1



Diag #	Part #	Name	Description	Qty
54	C5NN11467J	SPARE PART	Plunger, Starter Safety Switch, Red, 1.315/1.320 (33.401/33.528mm), Years: 01-JAN-65-30-SEP-66	1
		No Longer Serviced.	No Longer Serviced.	1
55	C5NN11N520A	ROLLER	Starter Safety Switch, Years: 01-JAN-65-30-SEP-66	1
		No Longer Serviced.	No Longer Serviced.	1
56	C5NN11N517B	SPARE PART	Connector, Starter Safety Switch, U.S., Years: 01-JAN-65-30-SEP-66	1
		Procure Locally	Procure Locally	1
		No Longer Serviced.	No Longer Serviced.	1
56	C5NN11N517B	SPARE PART	Connector, Starter Safety Switch, U.K.-Antwerp, Years: 01-JAN-65-30-SEP-66	1
		Procure Locally	Procure Locally	1
		No Longer Serviced.	No Longer Serviced.	1
57	C5NN11N466A	RETAINER	Starter Safety Switch Plunger, W/Cast Cover, Years: 01-JAN-65-30-SEP-66	1
		No Longer Serviced.	No Longer Serviced.	1
58	C5NN11N499A	PLATE	Starter Switch Support, U.S. Only, Years: 01-JAN-65-30-SEP-66	1
		No Longer Serviced.	No Longer Serviced.	1
59	C7NN7N450B	BOLT	Hex Drilled Hd., W/Cast Cover, 5/16"-18 x 1-7/8", Years: 01-JAN-65-30-SEP-66	2
		No Longer Serviced.	No Longer Serviced.	1
60	355431S	BOLT	Hex Drilled Hd., W/Pressed Steel Cover, 5/16"-18 x .56, Years: 01-JAN-65-30-SEP-66	2
		No Longer Serviced.	No Longer Serviced.	1
61	C5NN7B226B	SPARE PART	Stop, Gear Shift Lever, W/Cast Cover, Years: 01-JAN-65-30-SEP-66	1
		No Longer Serviced.	No Longer Serviced.	1
61	C5NN7B226L	STOP	Gear Shift Lever, W/Cast Cover, Replaces P/N C5NN7B226G, Years: 01-OCT-66-31-JAN-69	1
		No Longer Serviced.	No Longer Serviced.	1
61A	C5NN7N179A	PLATE	Gear Shift Oil Baffle Sliding, W/Cast Cover, Years: 01-JAN-65-31-JAN-69	1
61B	352619S36	WASHER	Flat, W/Cast Cover, .880/.890 I.D. x 1.50, Years: 01-JAN-65-31-JAN-69	1
61C	C5NN7N178A	PLATE	Gear Shift Oil Baffle, W/Cast Cover, Years: 01-JAN-65-30-SEP-66	1
		No Longer Serviced.	No Longer Serviced.	1
61D	C5NN7N177A	PLATE	Assy., Gear Shift Oil Baffle, W/Pressed Steel Cover, U.S., Years: 01-JAN-65-30-SEP-66	1
		No Longer Serviced.	No Longer Serviced.	1

Diag #	Part #	Name	Description	Qty
61E	C5NN7N178B	PLATE	Gear Shift Oil Baffle, W/Pressed Steel Cover, Years: 01-JAN-65-30-SEP-66	1
		No Longer Serviced.	No Longer Serviced.	1
61F	375217S36	WASHER,3/4", .79" x 1.72" x .13" Thk	W/Pressed Steel Cover 3/4", .79" x 1.72" x .13" Thk, Start Year: 01-JAN-65	2
61G	355137S	BOLT	HH, W/Pressed Steel Cover, #10-32 x 3/8", Years: 01-JAN-65-30-SEP-66	2
		No Longer Serviced.	No Longer Serviced.	1
62	355431S	BOLT	Hex Drilled Hd., W/Cast Cover, 5/16"-18 x .56, Years: 01-JAN-65-31-JAN-69	4
		No Longer Serviced.	No Longer Serviced.	1
63	C5NN7277D	SEAL	Gear Shift Lever, 4200, Start Year: 01-JAN-66	2
63A	C5NN7N294A	RETAINER	Gear Shift Lever Seal, 4200, Start Year: 01-JAN-66	2
		NHNA Only.	NHNA Only.	1
		No Longer Serviced.	No Longer Serviced.	1
64	C5NN3C715A	GASKET	Cover, 4200, Start Year: 01-JAN-66	1
65	C5NN7N021B	PLATE	Assy., Cover, 4200, Start Year: 01-JAN-66	1
		NHNA Only.	NHNA Only.	1
		No Longer Serviced.	No Longer Serviced.	1
66	D9NN7B226FA	STOP	Gear Shift Lever, W/Pressed Steel Cover, Start Year: 01-OCT-66	1
67	55712S7	NUT	Lock, Prevailing Torque, G5, 5/16"-24, Start Year: 01-OCT-66	3
68	C5NN11N001B	PIN,9.44mm OD x 59.69mm L	Safety Starter Switch Locating, W/Pressed Steel Cover, 2.35" (59.689mm), Start Year: 01-OCT-66	1
69	C5NN11N001A	PIN,.371" x 2.73"	Safety Starter Switch Locating, W/Cast Cover, 2.73" (69.311mm, .371" x 2.73", Years: 01-OCT-66-31-JAN-69	1
70	81815256	DOWEL	Case Cover, Start Year: 01-OCT-66	1
71	81817901	NEUTRAL START SWITCH	Switch, Safety Starter, Start Year: 01-OCT-66	1
72	E1NN11N002AA	RETAINER	Safety Starter Switch, Start Year: 01-OCT-66	1
73	C5NN11N003B	SPRING	Safety Starter Switch, Replaces P/N C5NN11N003A, Start Year: 01-OCT-66	1
74	145222	BALL BEARING,9.53mm OD, Gr 1000	Steel 3/8", Start Year: 01-OCT-66	1
75	C5NN11467R	PIN,4.72mm OD x 15.75mm L	Safety Starter Switch, Start Year: 01-OCT-66	1
76	E4NN7A488BB	WIRE HARNESS	Wire Assy., Safety Starter Switch, Start Year: 01-OCT-66	1
77	D0NN14N204B	SWITCH	Clip, Safety Starter Switch, Start Year: 01-OCT-66	1

Diag #	Part #	Name	Description	Qty
	375394S	GROMMET	.34 ID x .061 Groove x .31 Thick, U.K.-Antwerp, Except 3500-4400-4500, Years: 01-OCT-66-30-JUN-71	1
		No Longer Serviced.	No Longer Serviced.	1
	353873S	GROMMET	.37 ID x .12 Groove x .50 Thick, U.K.-Antwerp, Except 3500, 4400, 4500, Start Year: 01-JUL-71	1
	353873S	GROMMET	.37 ID x .12 Groove x .50 Thick, U.S., Except 3500-4400-4410-4500, Start Year: 01-OCT-66	1
	D1NN3A566A	GROMMET	1/2" ID x 11/32" Thk, 3500-4000-4100-5000, Start Year: 01-OCT-66	1