

Third Function Valve Kit #380-152A Installation Instructions



For L2501, L3301 & L3901 Kubota Tractors with LA525 Loader
For L3200 & L3800 Kubota Tractors with LA524 Loader
For L4600 Kubota Tractor with LA764 Loader
For L4701 Kubota Tractor with LA765 Loader

380-153M

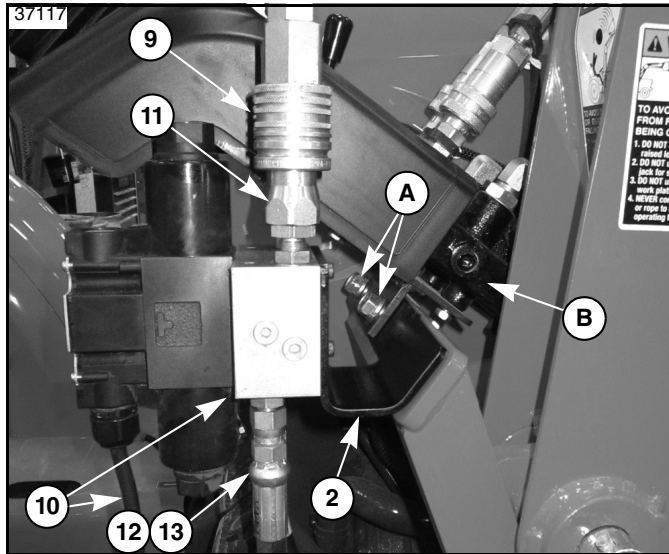

Figure 1

Notes

For color photos, visit
<https://dealers.landpride.com/en/12036/dealer-training>
and look for "Third Function Valves."

1. This manual is written with the assumption that the tractor is not supplied with rear remotes or backhoe.
2. This valve kit is designed to operate hydraulic cylinders.
3. For further assistance write to:

Land Pride Service Department
P.O. Box 5060
Salina, Ks. 67402-5060
E-mail address: lp servicedept@landpride.com

Assembly Instructions

Initial Preparations

1. Park tractor on a flat surface, place gear shift lever in park, turn off engine, and remove ignition key.

Valve Assembly

Refer to Figure 1 & Figure 2:

1. Remove hardware "A" used to mount the tractor's loader control valve assembly "B".
2. Bolt Land Pride's third function valve assembly in place by positioning mount bracket (#2) under the tractor's loader control valve assembly "B".
3. Reinstall hardware "A" removed in step 1 to secure Land Pride's third function valve as shown.

4. Route hydraulic hoses (#12 & #13) under the tractor's platform and back towards the rear of the tractor.

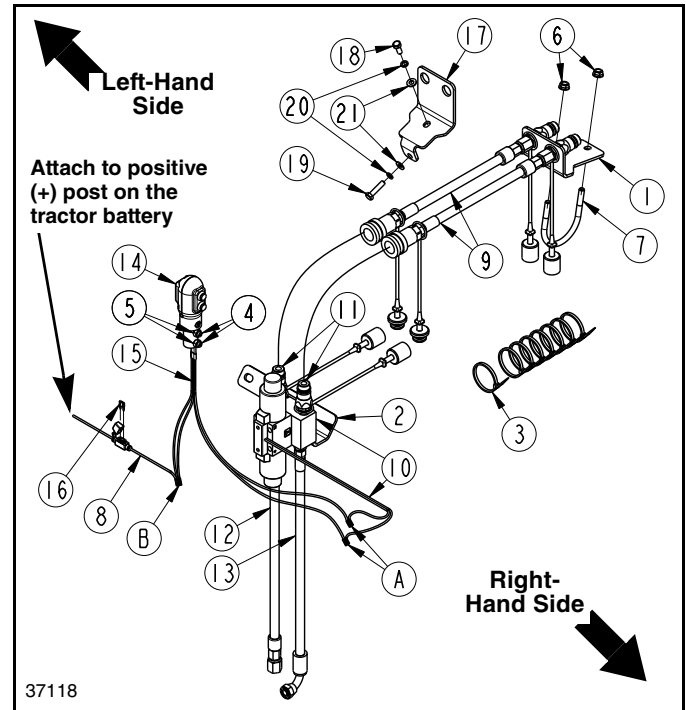

Figure 2

Connect Hydraulic Hoses to Power Beyond Ports

IMPORTANT: Land Pride recommends that your dealer connects hydraulic hoses (#12 & #13) to your tractor's power beyond ports. Improper hook-up could cause damage to your tractor.

1. Locate and remove hydraulic hose that connects power beyond port of tractor's loader valve assembly to outlet block under the tractor platform.

Refer to Figure 2:

2. Connect hydraulic hose (#12) from "P" port of third function valve (#10) to the fitting in the power beyond port of loader valve where hydraulic hose was removed in step #1 above.
3. Connect hydraulic hose (#13) from "T" port of third function valve (#10) to fitting in outlet block where hydraulic hose was removed in step (#1)
4. Secure hoses (#12 & #13) to tractor as needed with cable ties (#3).
5. Check tractor hydraulic fluid level. If low, add recommended hydraulic fluid. Refer to your tractor Operator's Manual for recommended hydraulic fluid and procedure for checking hydraulic fluid level.

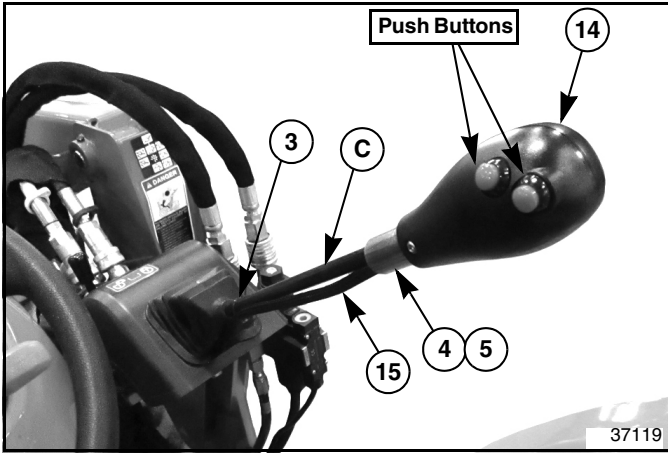

Figure 3

Control Lever Assembly

Refer to Figure 3 & Figure 4:

1. Remove existing knob (not shown) from end of control lever "C".
2. Install new joystick (#14) over end of control lever "C" with push buttons facing operator as shown.
3. Tighten set screws (#4) against control lever "C". Tighten jam nuts (#5) to secure set screws (#4).

Refer to Figure 4:

4. **Reference Connections "A":** Connect one black wire in harness (#15) to one black wire in harness (#10) and the other black wire in harness (#15) to one white wire in harness (#10).
5. **Reference Connection "B":** Connect the two red wires from the joystick (#14) to one end of wire (#8) with fuse holder (#16), and connect opposite end of wire (#8) to the positive (+) post on the tractor battery.

Refer to Figure 3:

6. Secure wiring with cable ties (#3) as needed.

Cross Beam Mount For L2501, L3301, L3901, L3200, & L3800 Tractors

Refer to Figure 4 & Figure 5:

1. Orient bulk head mount (#1) as shown and attach it to right-hand side of loader crossbeam "D" with u-bolt (#7) and hex whiz nuts (#6). Tighten hex whiz nuts to the proper torque.

Cross Beam Mount For L4600, L4701 Tractors

Refer to Figure 4 & Figure 6:

1. Remove existing top and top rear hardware (#18 & #19) from the right-hand side of loader cross tube "E".
2. Orient as shown and attach bulk head mount (#17) to right-hand side of loader cross tube "E" with new W8-1.25 x 35 bolt (#19) and new W8-1.25 x 20 bolt (#18), lock washers (#20) and flat washer (#21). Tighten bolts (#18 & #19) to the proper torque.

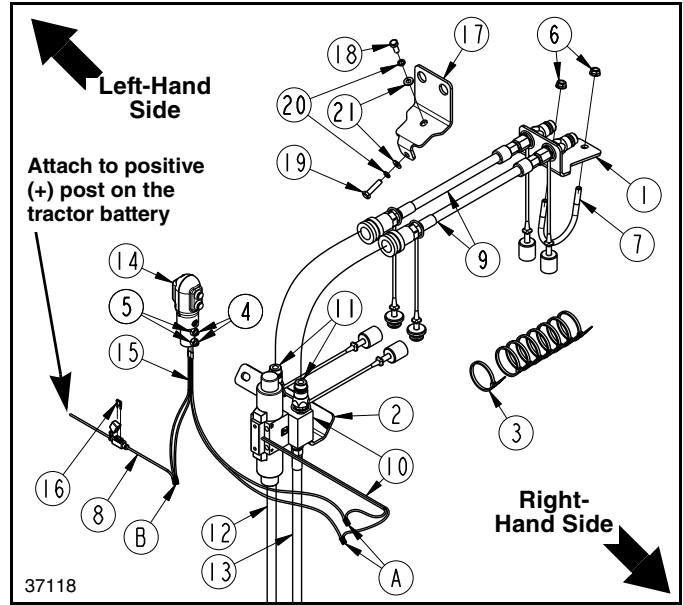

Figure 4

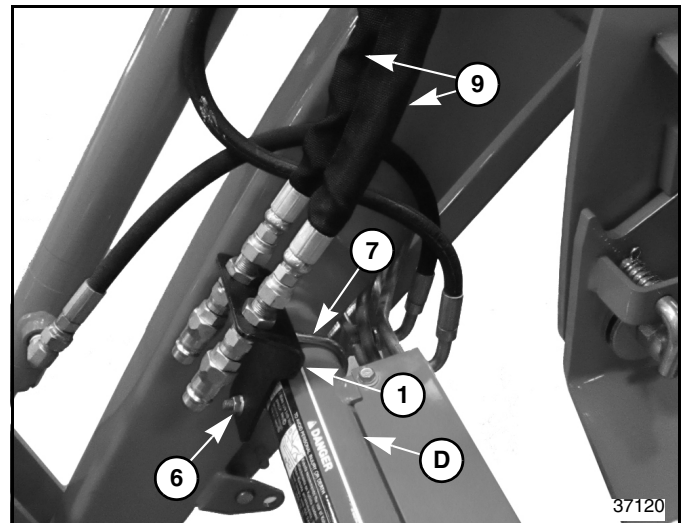

Figure 5

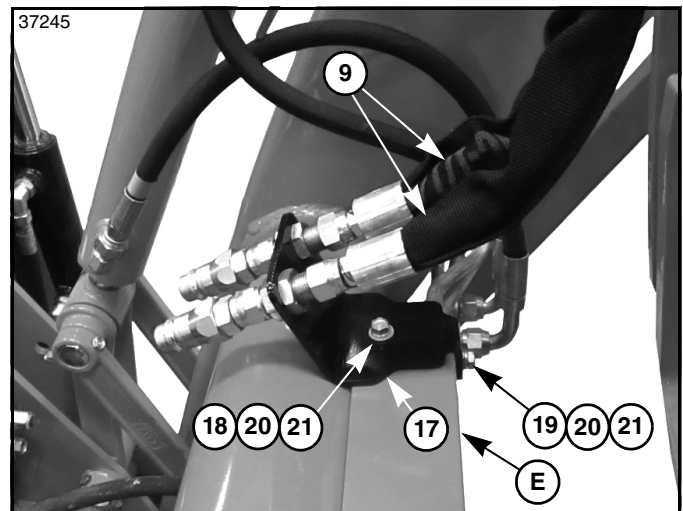

Figure 6

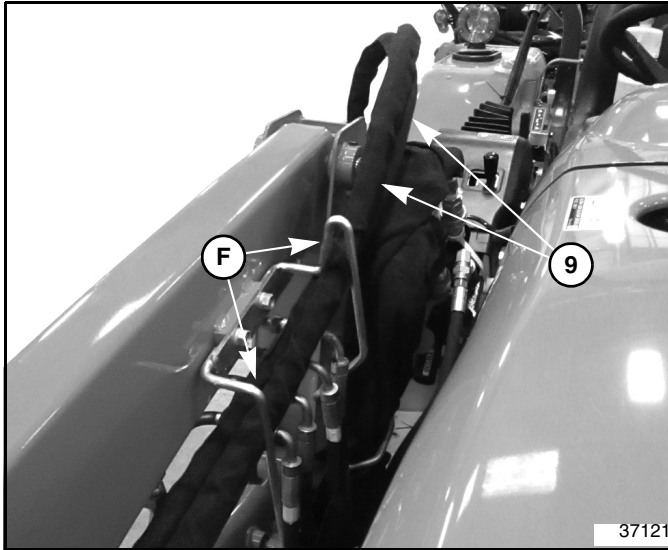

Figure 7

Hose Routing Along Loader Arm

Refer to Figures 4, 5, & 6 on page 2 & Figure 7:

1. Route hydraulic hoses (#9) along loader arm and through loader loop bracket "F" to third function valve assembly (#10).
2. Connect hoses to quick couplers (#11) on "A" & "B" ports of valve block (#10).
3. Secure hydraulic hoses (#9) as needed with cable ties (#3).



Corporate Office: P.O. Box 5060
Salina, Kansas 67402-5060 USA
www.landpride.com
